

KANSAS

WELL COMPLETION REPORT AND
DRILLER'S LOG

State Geological Survey
WICHITA BRANCH

S. 4 T. 31S R. 6 ^{XXX}W
Loc. 1980' FNL & 1980' FEL
County Harper County

API No. 15 — 077 — 20,681
County Number

Operator Texas Oil & Gas Corp.

Address 200 W. Douglas, Ste. 300, Wichita, KS 67202

Well No. #1 Lease Name Stevens "E"

Footage Location
1980' feet from (N) ~~XX~~ line 1980' feet from (E) ~~XX~~ line

Principal Contractor Slawson, Rig #4 Geologist Earl Moore

Spud Date 4-18-81 Date Completed 8-4-81 Total Depth 4450 P.B.T.D. 4112

Directional Deviation Not directionally drilled Oil and/or Gas Purchaser N/A

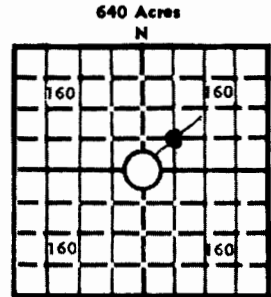

Elev.: Gr. 1537

DF KB 1542

CASING RECORD

Report of oil strings set — surface, intermediate, production, etc.

Purpose of string	Size hole drilled	Size casing set (in O.D.)	Weight lbs/ft.	Setting depth	Type cement	Sacks	Type and percent additives
Surface	12"	8-5/8"	24#	301		275	
Production		4-1/2"	10.5#	4447'		200 Sxs	Class "A" w/.75% CFG-2 + 10% salt +5# gillsonite per sxs

LINER RECORD

PERFORATION RECORD

Top, ft.	Bottom, ft.	Sacks cement	Shots per ft.	Size & type	Depth interval
N/A	N/A	N/A	2 JSPF (24 h.)	Miss.	4304-06', 4316-18', 4322-26', 4331-33'

Size	Setting depth	Packer set at
2-3/8"	4291	4261

ACID, FRACTURE, SHOT, CEMENT SQUEEZE RECORD

Amount and kind of material used	Depth interval treated
Acidized w/2000 gals 15% NE acid w/35 ball sealers	Same as above
Treated w/310 sxs 16-30 sd in 36,000 gals 70-qual. N2 foam	"

INITIAL PRODUCTION

Date of first production P & A, 8-4-81	Producing method (flowing, pumping, gas lift, etc.) plugged & abandoned
RATE OF PRODUCTION PER 24 HOURS	Oil N/A bbls. Gas N/A MCF Water N/A bbls. Gas-oil ratio N/A CFPB
Disposition of gas (vented, used on lease or sold) Plugged & abandoned, 8-4-81	Producing interval (s) N/A

INSTRUCTIONS: As provided in KCC Rule 82-2-125, within 90 days after completion of a well, one completed copy of this Drillers Log shall be transmitted to the State Geological Survey of Kansas, 4150 Monroe Street, Wichita, Kansas 67209. Copies of this form are available from the Conservation Division, State Corporation Commission, 245 No. Water, Wichita, Kansas 67202. Phone AC 316-522-2206. If confidential custody is desired, please note Rule 82-2-125. Drillers Logs will be on open file in the Oil and Gas Division, State Geological Survey of Kansas, Lawrence, Kansas 66044.

FIELD: BAUER EXT.

Operator
Texas Oil & Gas Corp.

DESIGNATE TYPE OF COMP.: OIL, GAS,
DRY HOLE, SWDW, ETC.:
P & A

Well No.
#1

Lease Name
Stevens "E"

S 4 T 31S R 6 ^{NE} W

WELL LOG

Show all important zones of porosity and contents thereof; cored intervals, and all drill-stem tests, including depth interval tested, cushion used, time tool open, flowing and shut-in pressures, and recoveries.

SHOW GEOLOGICAL MARKERS, LOGS RUN,
OR OTHER DESCRIPTIVE INFORMATION.

FORMATION DESCRIPTION, CONTENTS, ETC.	TOP	BOTTOM	NAME	DEPTH
LOG TOPS				
Heebner	3176	-1634		
Douglas	3264	-1722		
Stalnaker Sd	3466	-1924		
Kansas City	3736	-2194		
Swope	3866	-2324		
Cherokee	4145	-2603		
Miss.	4307	-2765		
RTD	4450			
LTD	4450			
Ran O.H. Logs				
DST #1, 4310-20' (Miss.), w/results as follows:				
IFP/30": 65-55#, weak blow				
ISIP/60": 225#				
FFP/45": 65-55#				
FSIP/90": 460#				
Rec: 120' GCM + 240' GIP				
DST #2, 4320-40' (Miss.), w/results as follows:				
IFP/30": 55-30#, good blow, GTS in 40", STM				
ISIP/60": 1390#				
FFP/45": 40-30#				
FSIP/90": 1390#				
Rec: 5' DM				
DST #3, 4340-52' (Miss.), w/results as follows:				
IFP/30": 40-40#, weak blow				
ISIP/60": 405#				
FFP/45": 55-55#, fair blow				
FSIP/90": 865#				
Rec: 600' GIP + 55' VSO&GCM (5% oil)				

USE ADDITIONAL SHEETS, IF NECESSARY, TO COMPLETE WELL RECORD.

Date Received	
	Harold R. Trapp District Geologist
	August 25, 1981

Signature
Title
Date

DRILLERS LOG

21

OPERATOR: Texas Oil & Gas Corp.
200 West Douglas
Wichita, Kansas 67202

WELL NAME: #1 Stevens 'E'
C SW NE Sec. 4-31S-6W
Harper County, Kansas

CONTRACTOR: Slawson Drilling Company, Inc.
200 Douglas Building
Wichita, Kansas 67202

COMMENCED: 4/18/81

COMPLETED: 4/29/81

RTD: 4450'

SURFACE CASING: 8-5/8" set at 301' with 275 sx

PRODUCTION CASING: 4-1/2" set at 4448' with 225 sx

0' to 305' Red Bed and Surface Hole
305' to 1056' Red Bed
1056' to 1450' Lime & Shale
1450' to 1470' Shale
1470' to 3740' Lime & Shale
3740' to 3900' K.C. Lime
3900' to 4320' Lime & Shale
4320' to 4352' Mississippian
4352' to 4450' Lime & Shale
RTD 4450

STATE OF KANSAS

COUNTY OF SEDGWICK

I, James C. Remsberg, of the Slawson Drilling Company, Inc.
hereby state the above is an accurate copy of the Stevens 'E'
log for Texas Oil & Gas Corp.

RECEIVED
STATE CORPORATION COMMISSION
MAY 15 1981
CONSERVATION DIVISION
Wichita, Kansas

James C. Remsberg
James C. Remsberg

Subscribed and sworn to me this
11th day of May, 1981