

State Geological Survey  
WICHITA, BRANCH

25-31-6W

KANSAS DRILLERS LOG

S. 25 T. 31 R. 6 <sup>K</sup> W

API No. 15 — 077 — 20,277  
County Number

Loc. SW NW NW

County Harper

Operator

Texaco, Inc.

Address Box 2420 Tulsa, Oklahoma

Well No.

#25

Lease Name

E. G. Litsey Unit

Footage Location

990 feet from (N) (S) line 330' feet from (E) (W) line

Principal Contractor

Damac

Geologist

Spud Date

2/1/75

Total Depth

3850'

P.B.T.D.

3653'

Date Completed

3-25-75

Oil Purchaser

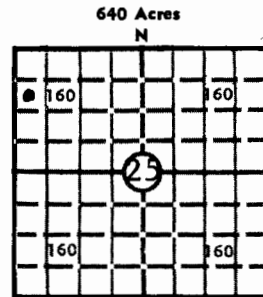

Elev.: Gr. 1388'

DF 1393' KB 1395'

CASING RECORD

Report of all strings set — surface, intermediate, production, etc.

Purpose of string	Size hole drilled	Size casing set (in O.D.)	Weight lbs/ft.	Setting depth	Type cement	Sacks	Type and percent additives
surface	12 1/4"	8-5/8"	24#	253'	reg	250	2% gel 3% CaCl
production		5-9/16"	15.63#	3850'	poz	200	2% gel 18% salt

LINER RECORD

PERFORATION RECORD

Top, ft.	Bottom, ft.	Sacks cement	Shots per ft.	Size & type	Depth interval
			2	jts	3646-48'
TUBING RECORD			"	"	3659-62'
			"	"	3673-76'
Size	Setting depth	Packer set at	"	"	3696-99'
			"	"	3728-32'

ACID, FRACTURE, SHOT, CEMENT SQUEEZE RECORD

Amount and kind of material used	Depth interval treated
A/each of above interval w/500 gal 15% NEA	

INITIAL PRODUCTION

Date of first production	Producing method (flowing, pumping, gas lift, etc.)				
3-1-75 (Swab test)	Pmpg				
RATE OF PRODUCTION PER 24 HOURS	Oil	Gas	Water	Gas-oil ratio	
	1 bbls.	-	52 BSW bbls.		CFPB
Disposition of gas (vented, used on lease or sold)			Producing interval (s)		
			3646-48'		

INSTRUCTIONS: As provided in KCC Rule 82-2-125, within 90 days after completion of a well, one completed copy of this Drillers Log shall be transmitted to the State Geological Survey of Kansas, 4150 Monroe Street, Wichita, Kansas 67209. Copies of this form are available from the Conservation Division, State Corporation Commission, 3830 So. Meridian (P.O. Box 17027), Wichita, Kansas 66217. Phone AC 316-522-2206. If confidential custody is desired, please note Rule 82-2-125. Drillers Logs will be on open file in the Oil and Gas Division, State Geological Survey of Kansas, Lawrence, Kansas 66044.

Operator

TEXACO INC.

DESIGNATE TYPE OF COMP.: OIL, GAS, DRY HOLE, SWDW, ETC.:

OIL

Well No.

5

Lease Name

E. G. Litsey

S 25 T 31 S R 6 W

WELL LOG

Show all important zones of porosity and contents thereof; cored intervals, and all drill-stem tests, including depth interval tested, cushion used, time tool open, flowing and shut-in pressures, and recoveries.

SHOW GEOLOGICAL MARKERS, LOGS RUN, OR OTHER DESCRIPTIVE INFORMATION.

FORMATION DESCRIPTION, CONTENTS, ETC.

TOP

BOTTOM

NAME

DEPTH

Red Beds & Sh

0

150

FDC  
GRL

2350-3850'  
245-3850'

Red Beds

150

250

Sh

250

264

Red Beds & Sh

264

988

Sh & Li

988

1436

Li & Sh

1436

2005

Li

2005

2422

Li & Sh

2422

2498

Li

2498

3737

Li

3737

3850

TD

3850

USE ADDITIONAL SHEETS, IF NECESSARY, TO COMPLETE WELL RECORD.

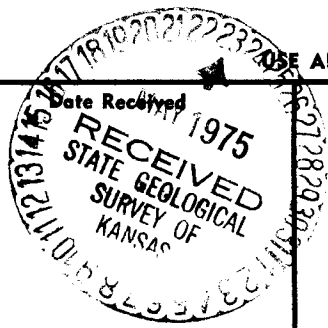

*F. E. Anderson*

F. E. ANDERSON

Signature

Oper. Supt.

Title

April 18, 1975

Date