

KANSAS

State Geological Survey
WICHITA, KANSAS

**WELL COMPLETION REPORT AND
DRILLER'S LOG**

S. 13 T. 31S R. 7 E
Loc. 1320' FSL & 1980' FWL

API No. 15 — 077 — 20,621
County Number

County Harper County

Operator
Texas Oil & Gas Corp.

Address
200 W. Douglas, Suite 300, Wichita, KS 67202

Well No. #1 Lease Name Mathes

Footage Location
1320 feet from XX (S) line 1980 feet from XX (W) line

Principal Contractor Slawson, Rig #4 Geologist Earl Moore

Spud Date 12-30-80 Date Completed 1-10-81 Total Depth 4400' P.B.T.D. N/A

Directional Deviation Not directionally drilled Oil and/or Gas Purchaser N/A

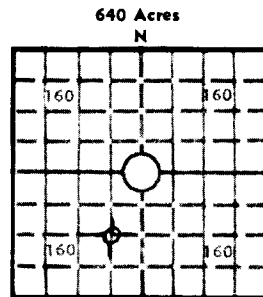

Locate well correctly
Elev.: Gr. 1497'
DF KB 1502'

CASING RECORD

Report of all strings set — surface, intermediate, production, etc.

Purpose of string	Size hole drilled	Size casing set (in O.D.)	Weight lbs/ft.	Setting depth	Type cement	Sacks	Type and percent additives
Surface		8-5/8		340'		300	

LINER RECORD

PERFORATION RECORD

Top, ft.	Bottom, ft.	Sacks cement	Shots per ft.	Size & type	Depth interval
N/A	N/A	N/A	N/A	N/A	N/A

TUBING RECORD

Size	Setting depth	Packer set at
N/A	N/A	N/A

ACID, FRACTURE, SHOT, CEMENT SQUEEZE RECORD

Amount and kind of material used	Depth interval treated
N/A	N/A

INITIAL PRODUCTION

Date of first production	Producing method (flowing, pumping, gas lift, etc.)			
N/A, D&A	Dry & Abandoned			
RATE OF PRODUCTION PER 24 HOURS	Oil	Gas	Water	Gas-oil ratio
	N/A bbls.	N/A MCF	N/A bbls.	N/A CFPB
Disposition of gas (vented, used on lease or sold)	Producing interval(s)			
Dry & Abandoned, 1-10-81	N/A			

INSTRUCTIONS: As provided in KCC Rule 82-2-125, within 90 days after completion of a well, one completed copy of this Drillers Log shall be transmitted to the State Geological Survey of Kansas, 4150 Monroe Street, Wichita, Kansas 67209. Copies of this form are available from the Conservation Division, State Corporation Commission, 245 No. Water, Wichita, Kansas 67202. Phone AC 316-522-2206. If confidential custody is desired, please note Rule 82-2-125. Drillers Logs will be on open file in the Oil and Gas Division, State Geological Survey of Kansas, Lawrence, Kansas 66044.

FIELD: Goheen

operator

DESIGNATE TYPE OF COMP.: OIL, GAS, DRY HOLE, SWDW, ETC.:

Texas Oil & Gas Corp.

Dry

Well No.

Lease Name

#1

Mathes

S¹³ T^{31S} R⁷ W^X

WELL LOG

Show all important zones of porosity and contents thereof; cored intervals, and all drill-stem tests, including depth interval tested, cushion used, time tool open, flowing and shut-in pressures, and recoveries.

SHOW GEOLOGICAL MARKERS, LOGS RUN, OR OTHER DESCRIPTIVE INFORMATION.

FORMATION DESCRIPTION, CONTENTS, ETC.	TOP	BOTTOM	NAME	DEPTH
LOG TOPS				
Herington	1398	+104		
Winfield	1450	+52		
Towanda	1520	-18		
Florence	1606	-104		
Wreford	1713	-212		
Cottonwood	1904	-402		
Red Eagle	2046	-544		
Onaga	2197	-695		
Wabaunsee	2213	-711		
Stotler	2420	-918		
Emporia	2645	-1143		
Howard	2784	-1282		
Heebner	3226	-1724		
Douglas Grp	3312	-1810		
Iatan	2454	-1952		
U. Stalnaker	3482	-1980		
L. Kansas City	3765	-2263		
Swope	3900	-2398		
Hertha	3936	-2434		
Cherokee	4162	-2660		
Mississippian	4336	-2834		
TD	4400			
DST #1, 3542-3554' (Stalnaker) w/results as follows:				
IFP/30 possible plugging, flushed tool, no pressures				
ISIP/60": tool plugged				
FFP/45": 66-78#, weak blow				
FSIP/90": 1462#				
Rec: 195' mud, 60' MSW				
DST #3, 3487-99' (Stal.) w/results as follows:				
IFP/30" 20-30#, strong blow				
ISIP/60": 1002#				
FFP/30" 30-40#, strong blow				
FSIP/60": 922# Rec: 75' mud				
DST #2, 4339-4350' (Miss.) w/results as follows:				
IFP/30": 44-44#, strong blow, GTS in 20"				
ISIP/60: 1548-1548				
FFP/60": 66-77#, max Ga 34 MCFG				
FSIP/120": 2066-2100				
Rec: 100' HOGCM & 60' OGCMSW				

USE ADDITIONAL SHEETS, IF NECESSARY, TO COMPLETE WELL RECORD.

Date Received

Harold R. Trapp
 Harold R. Trapp
 Signature

District Geologist

Title

January 12, 1981

Date