

15-077-20412

State Geological Survey
WICHITA BRANCH

KANSAS DRILLERS LOG

S. 10 T. 31S R. 8 EW
Loc. 1980' FSL & 1420' FEL

API No. 15 — 077 — 20,412
County Number

County Harper

Operator
Texas Oil & Gas Corp.

Address
200 West Douglas, Suite 300, Wichita, Kansas 67202

Well No. 1 Lease Name Muir "A"

Footage Location
1980 feet from (N) (S) line 1420 feet from (E) (W) line

Principal Contractor Xplor Drilling Company Geologist High Plains Consulting Ltd.

Spud Date 4-3-77 Total Depth 4525' P.B.T.D. N/A

Date Completed 4-14-77 Oil Purchaser N/A

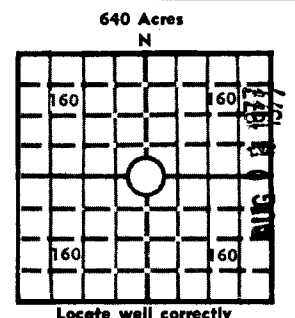

Locate well correctly
Elev.: Gr. 1628'

DF 1633' KB 1636'

CASING RECORD

Report of all strings set — surface, intermediate, production, etc.

Purpose of string	Size hole drilled	Size casing set (in O.D.)	Weight lbs/ft.	Setting depth	Type cement	Sacks	Type and percent additives
Surface	12 1/4"	8 5/8"	24#	266'	Common	250	2% Gel, 3% CaCl

LINER RECORD

PERFORATION RECORD

Top, ft.	Bottom, ft.	Sacks cement	Shots per ft.	Size & type	Depth interval
N/A	N/A	N/A			
TUBING RECORD			N/A	N/A	N/A
Size	Setting depth	Packer set at			
N/A	N/A	N/A			

ACID, FRACTURE, SHOT, CEMENT SQUEEZE RECORD

Amount and kind of material used	Depth interval treated
N/A	N/A

INITIAL PRODUCTION

Date of first production N/A	Producing method (flowing, pumping, gas lift, etc.) N/A				
RATE OF PRODUCTION PER 24 HOURS	Oil N/A bbls.	Gas N/A MCF	Water N/A bbls.	Gas-oil ratio N/A	CFPB
Disposition of gas (vented, used on lease or sold) N/A			Producing interval (s) N/A		

INSTRUCTIONS: As provided in KCC Rule 82-2-125, within 90 days after completion of a well, one completed copy of this Drillers Log shall be transmitted to the State Geological Survey of Kansas, 4150 Monroe Street, Wichita, Kansas 67209. Copies of this form are available from the Conservation Division, State Corporation Commission, 3830 So. Meridian (P.O. Box 17027), Wichita, Kansas 66217. Phone AC 316-522-2206. If confidential custody is desired, please note Rule 82-2-125. Drillers Logs will be on open file in the Oil and Gas Division, State Geological Survey of Kansas, Lawrence, Kansas 66044.

DESIGNATE TYPE OF COMP.: OIL, GAS, DRY HOLE, SWDW, ETC.:

Operator
Texas Oil & Gas Corp.

Well No. 1 Lease Name Muir "A" Dry Hole

S 10 T 31 S R 8 E W

WELL LOG

Show all important zones of porosity and contents thereof; cored intervals, and all drill-stem tests, including depth interval tested, cushion used, time tool open, flowing and shut-in pressures, and recoveries.

SHOW GEOLOGICAL MARKERS, LOGS RUN, OR OTHER DESCRIPTIVE INFORMATION.

FORMATION DESCRIPTION, CONTENTS, ETC.	TOP	BOTTOM	NAME	DEPTH
Herrington	1568	+68		
Krider	1600	+36		
Winfield	1625	+11		
Towanda	1704	-68		
Florence	1783	-147		
Wreford	1915	-279		
Beattie	2074	-438		
Cottonwood	2101	-465		
Indian Cave Sand	2384	-748		
Wabaunsee	2424	-788		
Tarkio	2635	-999		
Howard	2847	-1211		
Topeka	2981	-1345		
Heebner	3402	-1766		
Iatan	3629	-1993		
Lansing	3650	-2014		
Swope	4042	-2436		
Hertha	4072	-2436		
B/Kansas City	4127	-2491		
Cherokee	4286	-2650		
Mississippi	4384	-2748		
TD	4525	-2889		
<u>DST #1, 2364-2417', (Indian Cave) w/results as follows:</u>				
IFP/30": 41-103#				
ISIP/60": 971#				
FFP/45": 103-165#				
FSIP/90": 930#				
Rec 90' WM & 120' MW.				
<u>DST #2, 4039-59', (Swope) w/results as follows:</u>				
IFP/30": 62-144#				
ISIP/60": 1632#				
FFP/45": 103-165#				
FSIP/90": 1632#				
Rec 80' DM & 354' Wtr.				
<u>DST #3, 4382-99', (Mississippi) w/results as follows:</u>				
IFP/30": 62-165#, GTS 17", 12.7 MCFD				
ISIP/60": 1281#				
FFP/45": 165-289#				
FSIP/90": 1260#				
Rec 68' G&WCM & 770' wtr.				
USE ADDITIONAL SHEETS, IF NECESSARY, TO COMPLETE WELL RECORD.				

Date Received

Harold A. Brown
Signature

Harold A. Brown
District Geologist
Title

4-14-77

Date

Attachment to Kansas Drillers Log
TXO #1 Muir "A"
April 14, 1977
Page -2-

State Geological Survey

~~WICHITA BRANCH~~

15-077-20412

10-31-8w

DST'S CONTINUED

DST #4, 4458-64', (Mississippi) w/results as follows:
Mis-run.

DST #5, 4458-64', (Mississippi) w/results as follows:
IFP/20": 41-61#
ISIP/40": 1281#
FFP/45": 62-124#, weak blow
FSIP/90": 1343#
Rec 62' SG&OCM, 62' SO&GCMW, 124' SW.

DST #6, 4402-07', (Mississippi) w/results as follows:
Mis-run.

DST #7, 1595-1632', (Krider) w/results as follows:
Mis-run.