

KANSAS DRILLERS LOG

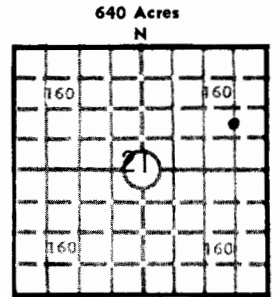

API No. 15 — 077 — 20, 081 WICHITA BRANCH
 County Number 15-077-20651

S. 21 T. 31 R. 8 ^{XK} W
 Loc. N/2 SE NE
 County Harper



Operator
 RUPE OIL COMPANY, INC.

Address
 P. O. Box 2273 (438 Ohio) Wichita, Kansas 67201

Well No. 1 Lease Name Dombaugh

Footage Location
 1650 feet from (N) ~~XX~~ line 660 feet from (E) ~~XX~~ line

Principal Contractor Geologist
 Union Drilling Company Martha Tetrick Kopper

Spud Date Total Depth P.B.T.D.
 1-27-81 4461 4419

Date Completed Oil Purchaser
 2-3-81 Koch Oil Company

Elev.: Gr. 1596'
 DF KB 1601'

CASING RECORD

Report of all strings set — surface, intermediate, production, etc.

Purpose of string	Size hole drilled	Size casing set (in O.D.)	Weight lbs/ft.	Setting depth	Type cement	Sacks	Type and percent additives
Surface	12 1/4"	8-5/8"	20#	287	Common	225	2% gel, 3% ca. cl.
Production	7-7/8"	4 1/2"	9.5#	4462	Pozmix	150	Salt Saturated

LINER RECORD

PERFORATION RECORD

Top, ft.	Bottom, ft.	Sacks cement	Shots per ft.	Size & type	Depth interval
			2	DML-X	4392-98

TUBING RECORD

Size	Setting depth	Packer set at
2-3/8"	4408.30	-

ACID, FRACTURE, SHOT, CEMENT SQUEEZE RECORD

Amount and kind of material used	Depth interval treated
472 Bbls. gelled saltwater, 12 Bbls. 15% MCA, 9900# 20/40 sand.	4392-98

INITIAL PRODUCTION

Date of first production 4-3-81 Producing method (flowing, pumping, gas lift, etc.) Pumping

RATE OF PRODUCTION PER 24 HOURS
 Oil 10 bbls. Gas - MCF Water 40 bbls. Gas-oil ratio - CFPB

Disposition of gas (vented, used on lease or sold) --- Producing interval(s) 4392-98

INSTRUCTIONS: As provided in KCC Rule 82-2-125, within 90 days after completion of a well, one completed copy of this Drillers Log shall be transmitted to the State Geological Survey of Kansas, 4150 Monroe Street, Wichita, Kansas 67209. Copies of this form are available from the Conservation Division, State Corporation Commission, 3830 So. Meridian (P.O. Box 17027), Wichita, Kansas 66217. Phone AC 316-522-2206. If confidential custody is desired, please note Rule 82-2-125. Drillers Logs will be on open file in the Oil and Gas Division, State Geological Survey of Kansas, Lawrence, Kansas 66044.

Operator **Rupe Oil Company** DESIGNATE TYPE OF COMP.: OIL, GAS, DRY HOLE, SWDW, ETC.: **OIL**

Well No. **1** Lease Name **Dombaugh**

S 21 T 31S R 8 ^E/_W

WELL LOG

Show all important zones of porosity and contents thereof; cored intervals, and all drill-stem tests, including depth interval tested, cushion used, time tool open, flowing and shut-in pressures, and recoveries.

SHOW GEOLOGICAL MARKERS, LOGS RUN, OR OTHER DESCRIPTIVE INFORMATION.

FORMATION DESCRIPTION, CONTENTS, ETC.	TOP	BOTTOM	NAME	DEPTH
<p>DST #1 - 30-45-60-65; IHP 2199#; FHP 1999#; IFP 161-201; FFP 181-221#; ISIP 1201#; FSIP 1300#.</p> <p>Recovered 60' slightly oil & gas cut mud, 600' slightly gas cut oil; 80' water cut oil, 3050' gas in pipe.</p> <p>Gamma Ray, Neutron Guard, Caliper and Cement Bond Logs run.</p>	4316	4411	Heebner	3388
			Lansing	3652
			Kansas City	3892
			Stark	4046
			Cherokee	4276
			Mississippian	4391

USE ADDITIONAL SHEETS, IF NECESSARY, TO COMPLETE WELL RECORD.

Date Received	RUPE OIL COMPANY, INC.
	<i>Martha Tetrick Kopper</i> Signature
	Martha Tetrick Kopper, Geologist Title
	July 20, 1981 Date