

**State Geological Survey**  
WICHITA, BRANCH

**KANSAS DRILLERS LOG**

S. 25 T. 31 R. 9 W  
Loc. 2310 WEL 1650 NSL SE

API No. 15 — 077 — 20,227  
County Number

County Harper

Operator

Robinowitz Oil Company

Address 1322 East 50th Street  
Tulsa, Oklahoma

Well No.

#4

Lease Name

Ray Antrim

Footage Location

1650'

2310'

feet from (N) (S) line

feet from (E) (W) line

Principal Contractor

Graves Drilling Co., Inc.

Geologist

Lee Poulsen

Spud Date

December 22, 1973

Total Depth

4387'

P.B.T.D.

Date Completed

December 31, 1973

Oil Purchaser

Skelly Oil Company

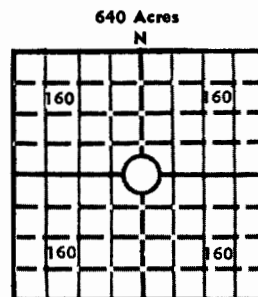

Elev.: Gr. 1571'  
DF 1576' KB

**CASING RECORD**

Report of all strings set — surface, intermediate, production, etc.

| Purpose of string | Size hole drilled | Size casing set (in O.D.) | Weight lbs/ft. | Setting depth | Type cement | Sacks | Type and percent additives |
|-------------------|-------------------|---------------------------|----------------|---------------|-------------|-------|----------------------------|
| Surface           | 12-1/4            | 8-5/8                     | 28#            | 219'          | Common      | 215   | 2% gel 3% CC               |
| Production        | 7-7/8             | 5-1/2                     | 14#            | 4376'         | Common      | 100   |                            |
|                   |                   |                           |                |               |             |       |                            |
|                   |                   |                           |                |               |             |       |                            |

**LINER RECORD**

**PERFORATION RECORD**

| Top, ft. | Bottom, ft. | Sacks cement | Shots per ft. | Size & type | Depth interval |
|----------|-------------|--------------|---------------|-------------|----------------|
|          |             |              |               | Open Hole   |                |
|          |             |              |               |             |                |
|          |             |              |               |             |                |

**TUBING RECORD**

| Size | Setting depth | Packer set at |
|------|---------------|---------------|
| 2"   | 4344'         |               |

**ACID, FRACTURE, SHOT, CEMENT SQUEEZE RECORD**

| Amount and kind of material used | Depth interval treated |
|----------------------------------|------------------------|
| 500 gal. MCA 5,000# 20/40 sand   | 4376 to 87'            |
|                                  |                        |
|                                  |                        |

**INITIAL PRODUCTION**

|   |   |                         |                             |                               |      |
|---|---|-------------------------|-----------------------------|-------------------------------|------|
| Date of first production<br><u>3-21-74</u>                        | Producing method (flowing, pumping, gas lift, etc.)<br><u>Pumping</u> |                         |                             |                               |      |
| RATE OF PRODUCTION<br>PER 24 HOURS                                | Oil<br><u>52</u><br>bbls.   | Gas<br><u>27</u><br>MCF | Water<br><u>50</u><br>bbls. | Gas-oil ratio<br><u>05.21</u> | CFPB |
| Disposition of gas (vented, used on lease or sold)<br><u>sold</u> |   |                         | Producing interval (s)      |                               |      |

INSTRUCTIONS: As provided in KCC Rule 82-2-125, within 90 days after completion of a well, one completed copy of this Drillers Log shall be transmitted to the State Geological Survey of Kansas, 4150 Monroe Street, Wichita, Kansas 67209. Copies of this form are available from the Conservation Division, State Corporation Commission, 3830 So. Meridian (P.O. Box 17027), Wichita, Kansas 66217. Phone AC 316-522-2206. If confidential custody is desired, please note Rule 82-2-125. Drillers Logs will be on open file in the Oil and Gas Division, State Geological Survey of Kansas, Lawrence, Kansas 66044.

|  |                                    |   |
|--|------------------------------------|---|
| Operator<br><b>ROBINOWITZ OIL COMPANY</b>                    |                                    | DESIGNATE TYPE OF COMP.: OIL, GAS,<br>DRY HOLE, SWDW, ETC.: |
| Well No.<br><b>4</b>   | Lease Name<br><b>Ray Antrim #4</b> | <b>Oil Well</b>   |
| S <u>25</u> T <u>31</u> R <u>9</u> <sup>E</sup> <sub>W</sub> |                                    |   |

### WELL LOG

Show all important zones of porosity and contents thereof; cored intervals, and all drill-stem tests, including depth interval tested, cushion used, time tool open, flowing and shut-in pressures, and recoveries.

SHOW GEOLOGICAL MARKERS, LOGS RUN, OR OTHER DESCRIPTIVE INFORMATION.

| FORMATION DESCRIPTION, CONTENTS, ETC. | TOP  | BOTTOM | NAME           | DEPTH |
|---------------------------------------|------|--------|----------------|-------|
| Red Bed and Shale                     | 0    | 218    | Heebner        | 3403  |
| Red Bed                               | 218  | 765    | Lansing        | 3629  |
| Shale and Lime                        | 765  | 1670   | Kansas City    | 3896  |
| Lime and Shale                        | 1670 | 1900   | Base-Kans.City | 4164  |
| Shale and Lime                        | 1900 | 2125   | Mississippian  | 4374  |
| Lime and Shale                        | 2125 | 2530   | Total Depth    | 4387  |
| Shale and Lime                        | 2530 | 3000   |                |       |
| Lime and Shale                        | 3000 | 3041   |                |       |
| Lime                                  | 3041 | 3575   |                |       |
| Sand                                  | 3575 | 3576   |                |       |
| Lime                                  | 3576 | 4305   |                |       |
| Lime and Shale                        | 4305 | 4374   |                |       |
| Chert                                 | 4374 | 4385   |                |       |
| Rotary Total Depth                    |      | 4385   |                |       |

USE ADDITIONAL SHEETS, IF NECESSARY, TO COMPLETE WELL RECORD.



*[Signature]*  
 \_\_\_\_\_  
 Signature  
 \_\_\_\_\_  
 Petroleum Engineer  
 \_\_\_\_\_  
 Title  
 \_\_\_\_\_  
 May 1, 1974  
 \_\_\_\_\_  
 Date

API# 15-077-20,227  
 ROTARY DRILLERS' LOG

25-31-9W

OPERATOR: Robinowitz Oil Company DRILLING COMMENCED: December 21, 1973  
 1322 E. 50th  
 Tulsa, Oklahoma 74105

CONTRACTOR: Graves Drilling Co., Inc. DRILLING COMPLETED: December 31, 1973  
 505 Union Center  
 Wichita, Kansas 67202

CASING RECORD: 10 Jts. 219' 8-5/8" LOCATION: Antrim No. 4  
 cemented with 215 sacks SW NW SE  
 139 Jts. 4376' 5-1/2" Section 25-31S-9W  
 cemented with 75 sacks Harper County, Kansas

ELEVATION: 1576 KB

|             |                    |
|-------------|--------------------|
| 0 - 218     | Red bed & shale    |
| 218 - 765   | Red bed            |
| 765 - 1670  | Shale & lime       |
| 1670 - 1900 | Lime & shale       |
| 1900 - 2125 | Shale & lime       |
| 2125 - 2530 | Lime & shale       |
| 2530 - 3000 | Shale & lime       |
| 3000 - 3041 | Lime & shale       |
| 3041 - 3575 | Lime               |
| 3575 - 3576 | Sand               |
| 3576 - 4305 | Lime               |
| 4305 - 4374 | Lime & shale       |
| 4374 - 4385 | Chert              |
| 4385        | Rotary Total Depth |



I hereby certify the foregoing statements to be true and correct to the best of my knowledge.

GRAVES DRILLING CO., INC.

By Petty Brandt  
 Secretary-Treasurer

STATE OF KANSAS )