

STATE CORPORATION COMMISSION OF KANSAS  
OIL & GAS CONSERVATION DIVISION  
WELL COMPLETION OR RECOMPLETION FORM  
ACO-1 WELL HISTORY

DESCRIPTION OF WELL AND LEASE

Operator: license # 5446  
name Benjamin M. Giles  
address 321 E. William #502  
City/State/Zip Wichita, Kansas 67202

Operator Contact Person Ben Giles  
Phone 316-262-4496

Contractor: license # 5842  
name Gabbert-Jones, Inc.

Wellsite Geologist Kathryn McLead  
Phone 316-265-6431

PURCHASER

Designate Type of Completion  
 New Well  Re-Entry  Workover

Oil  SWD  Temp Abd  
 Gas  Inj  Delayed Comp.  
 Dry  Other (Core, Water Supply etc.)

WFO: old well info as follows:  
Operator J.O. Farmer, Inc.  
Well Name Schreiner #1  
Comp. Date 8-29-58 Old Total Depth 4356

Reentry WELL HISTORY

Drilling Method:  Mud Rotary  Air Rotary  Cable  
6-18-85 6-20-85 6-20-85  
Start Date Date Reached TD Completion Date

Note: This was reentry of an old hole. However driller deviated out of old hole & well was plugged at 720 ft. per the state pluggers instructions.  
Amount of Surface Pipe Set and Cemented at 250 feet

Multiple Stage Cementing Collar Used?  Yes  No

If Yes, Show Depth Set feet

alternate 2 completion, cement circulated

from feet depth to w/ SX cmt

API NO. 15-007-01,011  
County Barber  
C NE NW Sec 14 Twp 32 Rge 10 X  
(location)  
4620 Ft North from Southeast Corner of Sec  
3300 Ft West from Southeast Corner of Sec  
(Note: locate well in section plat below)

Lease Name Schreiner G Well # 1

Field Name

Producing Formation Mississippi

Elevation: Ground 1478 KB 1483 RB

Section Plat

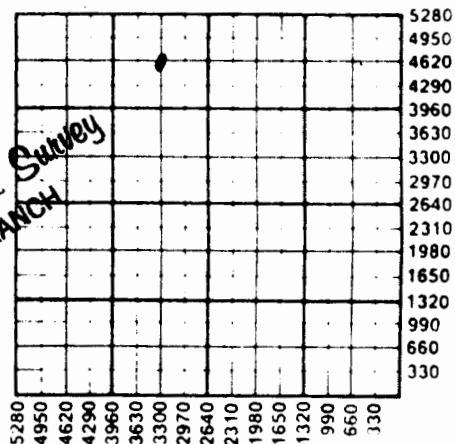

WATER SUPPLY INFORMATION

Source of Water: N/A

Division of Water Resources Permit #

Groundwater Ft North From Southeast Corner (Well) Ft. West From Southeast Corner  
Sec Twp Rge East West

Surface Water Ft North From Southeast Corner (Stream, Pond etc.) Ft West From Southeast Corner  
Sec Twp Rge East West

Other (explain)

(purchased from city, R.W.D. #)

Disposition of Produced Water Disposal

Repressuring

Docket #

INSTRUCTIONS: This form shall be completed in duplicate and filed with the Kansas Corporation Commission, 200 Colorado Derby Building, Wichita, Kansas 67202, within 90 days after completion or recompletion of any well. Rules 82-3-130 and 82-3-107 apply.

Information on side two of this form will be held confidential for a period of 12 months if requested in writing and submitted with the form. See rule 82-3-107 for confidentiality in excess of 12 months.

One copy of all wireline logs and drillers time log shall be attached with this form. Submit CP-4 form with all plugged wells. Submit CP-111 form with all temporarily abandoned wells.

SIDE TWO

Operator Name .... Ben. Giles ..... Lease Name Schweiner G' Well# 1 SEC. 14 TWP. 32 RGE. 10  West

**WELL LOG**

**INSTRUCTIONS:** Show important tops and base of formations penetrated. Detail all cores. Report all drill stem tests giving interval tested, time tool open and closed, flowing and shut-in pressures, whether shut-in pressure reached stat level, hydrostatic pressures, bottom hole temperature, fluid recovery, and flow rates if gas to surface during test. Attach extra sheet if more space is needed. Attach copy of log.

Drill Stem Tests Taken  Yes  No  
Samples Sent to Geological Survey  Yes  No  
Cores Taken  Yes  No

Formation Description  
 Log  Sample

Name Top Bottom

Old well re-entry deviated out of hole at 720 feet. Plugged at 720 feet per the state pluggers instructions.

NOV 12 1985  
State Geological Survey  
WICHITA BRANCH

**CASING RECORD**  new  used

Report all strings set - conductor, surface, intermediate, production, etc.

Purpose of string	size hole drilled	size casing set (in O.D.)	weight lbs/ft.	setting depth	type of cement	# sacks used	type and percent additives
.....	.....	.....	.....	.....	.....	.....	.....
.....	.....	.....	.....	.....	.....	.....	.....
.....	.....	.....	.....	.....	.....	.....	.....

**PERFORATION RECORD**

shots per foot specify footage of each interval perforated

**Acid, Fracture, Shot, Cement Squeeze Record**

(amount and kind of material used)

Depth

.....	.....	.....	.....
.....	.....	.....	.....
.....	.....	.....	.....
.....	.....	.....	.....