

15-007-20765

State Geological Survey  
**KANSAS DRILLERS LOG**  
 DISTRICT BRANCH

**IMPORTANT**  
 Kans. Geo. Survey request  
 samples on this well.

S. 23 T. 32 R. 10 <sup>NE</sup>/<sub>W</sub>

Loc. # C SE SW

County Barber

API No. 15 — 007 — 20,765  
 County Number

Operator  
White & Ellis Drilling, Inc.

Address  
7701 East Kellogg, Suite 290 Wichita, Kansas 67207

Well No. # 1 Lease Name  
Werner

Footage Location  
660 feet from SM (S) line 1980 feet from DK (W) line

Principal Contractor WHITE & ELLIS DRILLING, INC. Geologist BILL SLADEK

Spud Date 7-10-79 Total Depth 4383 P.B.T.D. 4343

Date Completed 9-8-79 Oil Purchaser  
Midwest Purchasing Corp.

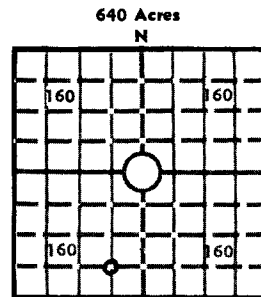

Elev.: Gr. 1443

DF 1446 KB 1448

**CASING RECORD**

Report of all strings set — surface, intermediate, production, etc.

Purpose of string	Size hole drilled	Size casing set (in O.D.)	Weight lbs/ft.	Setting depth	Type cement	Sacks	Type and percent additives
Surface	N.A.	8 5/8	28#	255'	Pozmix	200	3% CC
Production	N.A.	4 1/2	10.5#	4378	Pozmix	150	Salt

**LINER RECORD**

**PERFORATION RECORD**

Top, ft.	Bottom, ft.	Sacks cement	Shots per ft.	Size & type	Depth interval
NONE	NONE	NONE	4/ft	N.A.	4096-4102

**TUBING RECORD**

Size	Setting depth	Packer set at
2 3/8	N.A.	N.A.

**ACID, FRACTURE, SHOT, CEMENT SQUEEZE RECORD**

Amount and kind of material used	Depth interval treated
ACID - 150 gal. 150 MCA	4096-4102

**INITIAL PRODUCTION**

Date of first production <u>August, 1979</u>		Producing method (flowing, pumping, gas lift, etc.) <u>Pumping</u>			
RATE OF PRODUCTION PER 24 HOURS	Oil <u>7</u> bbls.	Gas <u>NONE</u> MCF	Water <u>12</u> bbls.	Gas-oil ratio <u>NONE</u> CFPB	
Disposition of gas (vented, used on lease or sold) <u>NONE</u>			Producing interval(s) <u>4096-4102</u>		

INSTRUCTIONS: As provided in KCC Rule 82-2-125, within 90 days after completion of a well, one completed copy of this Drillers Log shall be transmitted to the State Geological Survey of Kansas, 4150 Monroe Street, Wichita, Kansas 67209. Copies of this form are available from the Conservation Division, State Corporation Commission, 3830 So. Meridian (P.O. Box 17027), Wichita, Kansas 66217. Phone AC 316-522-2206. If confidential custody is desired, please note Rule 82-2-125. Drillers Logs will be on open file in the Oil and Gas Division, State Geological Survey of Kansas, Lawrence, Kansas 66044.

operator

WHITE & ELLIS DRILLING, INC.

DESIGNATE TYPE OF COMP.: OIL, GAS, DRY HOLE, SWDW, ETC.:

Well No. #1 Lease Name WERNER OIL

S 23 T 32 R 10 W C SE SW

**WELL LOG**

Show all important zones of porosity and contents thereof; cored intervals, and all drill-stem tests, including depth interval tested, cushion used, time tool open, flowing and shut-in pressures, and recoveries.

SHOW GEOLOGICAL MARKERS, LOGS RUN, OR OTHER DESCRIPTIVE INFORMATION.

FORMATION DESCRIPTION, CONTENTS, ETC.	TOP	BOTTOM	NAME	DEPTH
DST #1 4087-4117 30"-45"-60"-105" Strong Blow. Rec. 68' GCM, 120' O&GCM, 125' Gsy Oil IFP 46-93 FFP 93-93 ISIP 1286 FSIP 1402			ELGIN HEEBNER DOUGLAS BROWN LIME LANSING SWOPE B/KC CHEROKEE	3278 3409 3443 3640 3646 4084 4140 4310
Drilling at 4162'			MISSISSIPPIAN MISSISSIPPIAN CH.	4349 4378
DST #2 4242-4281 30"-30"-30"-30" Weak blow died in 6" Rec. 20' Mud All pressures 97#				
Drilling ahead				
DST #3 4331-4360 30"-45"-60"-90" Rec. 15' Mud All flow pressures 46#				
Circulating at 4376'				
DST #4 4359-4388 35"-45"-45"-60" Gas to surface in 2" Gauged 750 MCF, flowed oil to surface in 25" Red. 2540' clean oil, 400' water IFP 750-1355 FFP 1239-1448 ISIP 1472 FSIP 1472				

USE ADDITIONAL SHEETS, IF NECESSARY, TO COMPLETE WELL RECORD

Date Received

*Michael W. Egan*  
Signature

Geologist

Title

October 15, 1979

Date

## DRILLERS LOG

OPERATOR: White & Ellis Drilling, Inc.; 7701 E. Kellogg; Suite 290; Wichita,  
 CONTRACTOR: **White & Ellis Drilling, Inc., Box 448, El Dorado, Kansas 67042** Kansas, 67207

Lease Name Werner Well No. 1

Sec. 25 23 T. 32 R. 10W Spot C SE SW

County Barber State Kansas Elevation \_\_\_\_\_

Casing Record: |

Surface: 8 5/8" @ 255' with 200 Sxs.

Production: \_\_\_\_\_ @ \_\_\_\_\_ with \_\_\_\_\_ Sxs.

Type Well: Oil Total Depth 4388' K.B. \_\_\_\_\_

Drilling Commenced: 7/10/79 Drilling Completed 7/20/79

Formation	From	To	Tops
Cellar	0	7	Lansing - 3650
Sand, Shale	7	70	Mississippi - 4360
Lime, Shale	70	255	
Shale	255	1350	
Lime, Shale	1350	2675	
Lime	2675	2808	
Shale	2808	2870	
Lime, Shale	2870	3446	
Sand	3446	3622	
Sandy Lime	3622	3650	
Lime	3650	4388	

### COMPLETION RECORD

Liner Record: Size \_\_\_\_\_ From \_\_\_\_\_ To \_\_\_\_\_

Cementing Record: \_\_\_\_\_ Sacks \_\_\_\_\_

Perforating Record: \_\_\_\_\_