

KANSAS

WELL COMPLETION REPORT AND DRILLER'S LOG

State Geological Survey WICHITA, BRANCH

S. 7 T. 32S R. 11W

Loc. SW NW SW

API No. 15 - 007 - 20,977 County Number

County Barber

Operator Gear Petroleum Co., Inc.

Address 300 Sutton Place, Wichita, Kansas 67202

Well No. #1 Lease Name AXTELL

Footage Location 1650 feet from (S) line 1650 feet from (W) line

Principal Contractor Graves Drilling Company Geologist Benny Singleton

Spud Date 8-6-80 Date Completed 8-14-80 Total Depth 4350' P.B.T.D. N/a

Directional Deviation N/A Oil and/or Gas Purchaser N/A

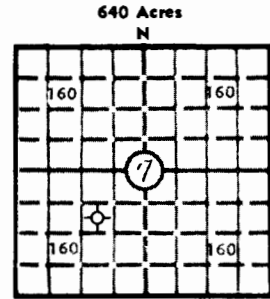

Elev.: Gr. 1476

DF KB 1487

CASING RECORD

Report of all strings set — surface, intermediate, production, etc.

Table with 8 columns: Purpose of string, Size hole drilled, Size casing set (in O.D.), Weight lbs/ft., Setting depth, Type cement, Sacks, Type and percent additives. Row 1: Surface, 12 1/4", 8 5/8, 20#, 248', common, 225, 2% Gel; 3% CC.

LINER RECORD

PERFORATION RECORD

Tables for Liner and Tubing records. Liner record columns: Top ft., Bottom ft., Sacks cement, Shots per ft., Size & type, Depth interval. Tubing record columns: Size, Setting depth, Packer set at.

ACID, FRACTURE, SHOT, CEMENT SQUEEZE RECORD

Table with 2 columns: Amount and kind of material used, Depth interval treated. Row 1: N/A, N/A.

INITIAL PRODUCTION

Table for Initial Production with columns for Date of first production, Producing method, Rate of production per 24 hours (Oil, Gas, Water), Gas-oil ratio, Disposition of gas, and Producing interval(s).

INSTRUCTIONS: As provided in KCC Rule 82-2-125, within 90 days after completion of a well, one completed copy of this Drillers Log shall be transmitted to the State Geological Survey of Kansas, 4150 Monroe Street, Wichita, Kansas 67209.

Operator GEAR PETROLEUM CO., INC.		DESIGNATE TYPE OF COMP.: OIL, GAS, DRY HOLE, SWDW, ETC.: Dry Hole
Well No. #1	Lease Name AXTELL	
S 7 T 32S R 11W E ^W		

WELL LOG

Show all important zones of porosity and contents thereof; cored intervals, and all drill-stem tests, including depth interval tested, cushion used, time tool open, flowing and shut-in pressures, and recoveries.

SHOW GEOLOGICAL MARKERS, LOGS RUN, OR OTHER DESCRIPTIVE INFORMATION.

FORMATION DESCRIPTION, CONTENTS, ETC.	TOP	BOTTOM	NAME	DEPTH
<u>LOG TOPS</u>				
Heebner	3493	-2006		
Douglas SH	3562	-2075		
Brown LM	3712	-2225		
Stark	4088	-2061		
Miss. Chert	4282	-2795		
RTD	4350	-2863		
LTD	4342	-2855		
DST #1, 4291-4304', good blow, 30-30-60-60; Rec. 65' GCM w/scum oil. IFP 55-55, ISIP 122, FFP 55-65, FSIP 533.				
DST #2, 4304-4319', 30-30-30-30; wk. blow 30", no blow 2nd open; Rec. 15' mud, IFP 55-44, ISIP 44, FFP 44-55, FSIP 133.				

USE ADDITIONAL SHEETS, IF NECESSARY, TO COMPLETE WELL RECORD.

Date Received	
	Jim Thatcher <small>Signature</small>
	Engineer <small>Title</small>
	4/28/81 <small>Date</small>

AUG 8 0 RECD

7-32S-11W

State Geological Survey
WICHITA BRANCH

R O T A R Y D R I L L E R S ' L O G

OPERATOR: Gear Petroleum Co., Inc. DRILLING COMMENCED: August 6, 1980
 300 Sutton Place
 Wichita, Kansas 67202

CONTRACTOR: Graves Drilling Co., Inc. DRILLING COMPLETED: August 14, 1980
 910 Union Center
 Wichita, Kansas 67202

CASING RECORD: 6 Jts. 248' of new 8-5/8" LOCATION: Axtell No. 1
 cemented with 225 sacks SW NW SW
 Section 7-32S-11W
 Barber County, Kansas

0 - 60	Sand
60 - 370	Red bed
370 - 1181	Red bed & shale
1181 - 1669	Shale
1669 - 4304	Shale & lime
4304 - 4350	Lime
4350	Rotary Total Depth

I hereby certify the foregoing statements to be true and correct to the best of my knowledge.

GRAVES DRILLING CO., INC.

By Betty Brandt
Secretary-Treasurer

Copy sent to:
Corporation Commission
Kansas Geological Society
Kansas Geological Survey