

IMPORTANT  
Kans. Geo. Survey request  
samples on this well.

S. 33 T. 32 R. 12 <sup>N</sup>W  
Loc. C E2 NE SW  
County Barber

API No. 15 — 007 — 20,917 ✓  
County Number

Operator  
Texas Oil & Gas Corp.

Address  
200 W. Douglas, Suite #300 Wichita, Kansas 67202

Well No. #1 Lease Name Meadows Trust "A"

Footage Location  
1980' feet from ~~XX~~ (S) line 2310' feet from ~~XX~~ (W) line

Principal Contractor Slawson Geologist Jack Childers

Spud Date 4-18-80 Total Depth 4500' P.B.T.D. N/A

Date Completed 4-28-80 Oil Purchaser N/A

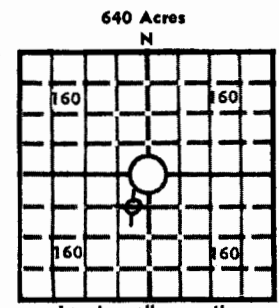

Locate well correctly  
Elev.: Gr. 1609'  
DF \_\_\_\_\_ KB 1614'

CASING RECORD

Report of all strings set— surface, intermediate, production, etc.

Purpose of string	Size hole drilled	Size casing set (in O.D.)	Weight lbs/ft.	Setting depth	Type cement	Sacks	Type and percent additives
Surface	12 1/4"	8-5/8"	28#	336'		250	

LINER RECORD

PERFORATION RECORD

Top, ft.	Bottom, ft.	Sacks cement	Shots per ft.	Size & type	Depth interval
N/A	N/A	N/A	N/A	N/A	N/A

TUBING RECORD

Size	Setting depth	Packer set at
N/A	N/A	N/A

ACID, FRACTURE, SHOT, CEMENT SQUEEZE RECORD

Amount and kind of material used	Depth interval treated
N/A	N/A

INITIAL PRODUCTION

Date of first production D&A Producing method (flowing, pumping, gas lift, etc.) N/A

RATE OF PRODUCTION PER 24 HOURS	Oil	Gas	Water	Gas-oil ratio
	N/A bbls.	N/A MCF	N/A bbls.	N/A CFPB

Disposition of gas (vented, used on lease or sold) Dry Hole Producing interval(s) N/A

INSTRUCTIONS: As provided in KCC Rule 82-2-125, within 90 days after completion of a well, one completed copy of this Drillers Log shall be transmitted to the State Geological Survey of Kansas, 4150 Monroe Street, Wichita, Kansas 67209. Copies of this form are available from the Conservation Division, State Corporation Commission, 3830 So. Meridian (P.O. Box 17027), Wichita, Kansas 66217. Phone AC 316-522-2206. If confidential custody is desired, please note Rule 82-2-125. Drillers Logs will be on open file in the Oil and Gas Division, State Geological Survey of Kansas, Lawrence, Kansas 66044.

Operator  
Texas Oil & Gas Corp.

DESIGNATE TYPE OF COMP.: OIL, GAS,  
DRY HOLE, SWDW, ETC.:  
Dry Hole

Well No.  
#1

Lease Name  
Meadows Trust "A"

S 33 T 32S R 12 ~~E~~  
W

**WELL LOG**

Show all important zones of porosity and contents thereof; cored intervals, and all drill-stem tests, including depth interval tested, cushion used, time tool open, flowing and shut-in pressures, and recoveries.

SHOW GEOLOGICAL MARKERS, LOGS RUN,  
OR OTHER DESCRIPTIVE INFORMATION.

FORMATION DESCRIPTION, CONTENTS, ETC.	TOP	BOTTOM	NAME	DEPTH
LOG TOPS				
Herrington	1932	-318		
Winfield	1978	-364		
Towanda	2068	-454		
Florence	2160	-546		
Wreford	2274	-660		
Cottonwood	2518	-904		
Onaga	2744	-1130		
Indian Cave ss	2753	-1139		
Wabaunsee	2805	-1191		
Topeka	3286	-1672		
Heebner	3706	-2092		
Upper Douglas	3722	-2108		
Lansing	2896	-2286		
Mississippi	4480	-2866		
TD	4500			
DST #1, 4458-80' (Mississippi), w/results as follows:				
IFP/30": 23-23#, strong blow				
ISIP/60": 92#				
FFP/45": 23-23#, good blow				
FSIP/90": 57#				
Rec: 10' mud				

USE ADDITIONAL SHEETS, IF NECESSARY, TO COMPLETE WELL RECORD.

Date Received

*Harold A. Brown*

HAROLD A. BROWN Signature

District Exploration Manager

Title

April 29, 1980

Date