

State Geological Survey
WICHITA, BRANCH

KANSAS DRILLERS LOG

S. 32 T. 32S R. 14 ^{NE} _W

API No. 15 — 007 — 20,223
County Number

Loc. C NW SW

County Barber

Operator
Beacon Resources Corporation

Address
Suite 1000 Century Plaza Bldg., Wichita, Ks. 67202

Well No. 1 Lease Name Schooley

Footage Location
660 feet from (N) ~~(S)~~ line 660 feet from ~~(E)~~ (W) line

Principal Contractor Graves Drilling Co. Geologist Harold Steincamp

Spud Date Jan 7, 1973 Total Depth 4845 P.B.T.D. --

Date Completed Jan 19, 1973 Oil Purchaser --

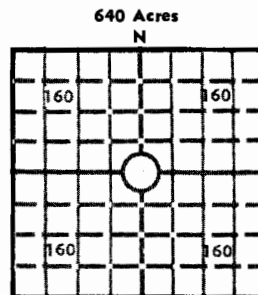

Locate well correctly

Elev.: Gr. 1910

DF 1912 KB 1915

CASING RECORD

Report of all strings set — surface, intermediate, production, etc.

| Purpose of string | Size hole drilled | Size casing set (in O.D.) | Weight lbs/ft. | Setting depth | Type cement | Sacks | Type and percent additives |
|-------------------|-------------------|---------------------------|----------------|---------------|-------------|-------|----------------------------|
| surface | 12-1/4 | 8-5/8 | | 266' | | 275 | 2% gel, 3% CaCl |
| | | | | | | | |
| | | | | | | | |
| | | | | | | | |

LINER RECORD

PERFORATION RECORD

| Top, ft. | Bottom, ft. | Sacks cement | Shots per ft. | Size & type | Depth interval |
|----------|-------------|--------------|---------------|-------------|----------------|
| -- | -- | -- | -- | -- | -- |

| Size | Setting depth | Packer set at | | | |
|------|---------------|---------------|----|----|----|
| -- | -- | -- | -- | -- | -- |

ACID, FRACTURE, SHOT, CEMENT SQUEEZE RECORD

| Amount and kind of material used | Depth interval treated |
|----------------------------------|------------------------|
| -- | -- |
| | |
| | |

INITIAL PRODUCTION

| | | | | | |
|--|---|--------|----------|---------------|--|
| Date of first production | Producing method (flowing, pumping, gas lift, etc.) | | | | |
| -- | -- | | | | |
| RATE OF PRODUCTION PER 24 HOURS | Oil | Gas | Water | Gas-oil ratio | |
| | -- bbls. | -- MCF | -- bbls. | -- CFPB | |
| Disposition of gas (vented, used on lease or sold) | Producing interval(s) | | | | |
| -- | -- | | | | |

INSTRUCTIONS: As provided in KCC Rule 82-2-125, within 90 days after completion of a well, one completed copy of this Drillers Log shall be transmitted to the State Geological Survey of Kansas, 4150 Monroe Street, Wichita, Kansas 67209. Copies of this form are available from the Conservation Division, State Corporation Commission, 3830 So. Meridian (P.O. Box 17027), Wichita, Kansas 66217. Phone AC 316-522-2206. If confidential custody is desired, please note Rule 82-2-125. Drillers Logs will be on open file in the Oil and Gas Division, State Geological Survey of Kansas, Lawrence, Kansas 66044.

Operator

DESIGNATE TYPE OF COMP.: OIL, GAS,
DRY HOLE, SWDW, ETC.:

Beacon Resources Corporation

dry hole

Well No.

Lease Name

1

Schooley

s32 T32S R14 ~~W~~^{XX}

WELL LOG

Show all important zones of porosity and contents thereof; cored intervals, and all drill-stem tests, including depth interval tested, cushion used, time tool open, flowing and shut-in pressures, and recoveries.

SHOW GEOLOGICAL MARKERS, LOGS RUN, OR OTHER DESCRIPTIVE INFORMATION.

| FORMATION DESCRIPTION, CONTENTS, ETC. | TOP | BOTTOM | NAME | DEPTH |
|--|-----|--------|------|-------|
| DST #1 4269-90 15/45/90/45 rec 3324' SW, BHP 1520-1516, FP 860-1220 & 1310-1516. | | | | |
| DST #2 4652-4705 15/45/90/45 rec 150' mud, BHP 250-360, FP 50-60 & 80-90. | | | | |
| DST #3 4778-4805 15/45/90/45 rec 60' mud w/S.O. in tool, BHP 110-100 FP 36-40 & 40-44. | | | | |
| DST #4 4805-4820 15/45/90/45, rec 30' mud w/S.O. in tool, BHP 160- 80, FP 20-20 & 20-30. | | | | |
| Log tops: Heebner 4052 Douglas 4102 Lansing 4230 Stark 4563 Mississippi 4788 TD 4845 | | | | |

USE ADDITIONAL SHEETS, IF NECESSARY, TO COMPLETE WELL RECORD.

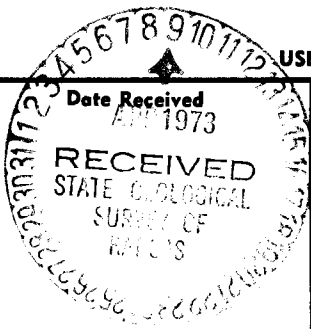

A. L. Dawson, Jr.

Signature

Manager of Production

Title

13 March 1973

Date

KANSAS GEOLOGICAL SOCIETY
508 East Murdock
Wichita, Kansas

32-32-14W 32-32-14W
APP (P) NW SW

MAR 16 1973

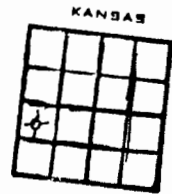

ROTARY DRILLERS' LOG
API # 15-007-20,223

OPERATOR: Beacon Resources, Inc. DRILLING COMMENCED: January 7, 1973
1000 Century Plaza
Wichita, Kansas 67202

CONTRACTOR: Graves Drilling Co., Inc. DRILLING COMPLETED: January 19, 1973
505 Union Center
Wichita, Kansas 67202

CASING RECORD: 6 Jts. 266' 8-5/8" LOCATION: Schooley No. 1
cemented with 275 sacks C NW SW
Section 32-32S-14W
Barber County, Kansas

| LOG TOPS | DEPTH | | |
|----------|--------|---------------|--------------------|
| | 0 - 55 | Sod & red bed | |
| HEEB | 4052 | 55 - 615 | Red bed & shale |
| DOUG | 4102 | 615 - 1750 | Shale |
| LANS | 4230 | 1750 - 2011 | Shale & lime |
| STARK | 4563 | 2011 - 2750 | Lime |
| MISS | 4788 | 2750 - 4110 | Lime & shale |
| TD | 4845 | 4110 - 4233 | Shale |
| | | 4233 - 4765 | Lime |
| | | 4765 - 4790 | Lime & shale |
| | | 4790 - 4805 | Chert |
| | | 4805 - 4820 | Chert & lime |
| | | 4820 - 4845 | Lime |
| | | 4845 | Rotary Total Depth |

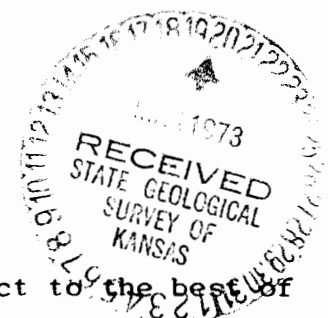

I hereby certify the foregoing statements to be true and correct to the best of my knowledge.

GRAVES DRILLING CO., INC.