

15-007-20615

IMPORTANT
Kans. Geol. Survey request samples on this well.

KANSAS DRILLERS LOG

S. 7 T. 32 R. 15 ^W
Loc. 660' FNL & 330' FWL
County Barber

API No. 15 — 007 — 20,615
County Number

Operator Texas Oil & Gas Corp.

Address 300-200 West Douglas
Wichita, Kansas 67202

Well No. #1 Lease Name Rusk "B"

Footage Location
660 feet from (N) (S) line 330 feet from (E) (W) line

Principal Contractor Xplor Drlg. Co. Geologist High Plains Consulting, Ltd.

Spud Date 4-13-78 Total Depth 4845' P.B.T.D. N/A

Date Completed 5-11-78 Oil Purchaser N/A

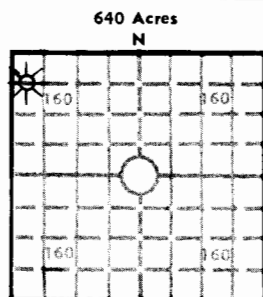

Elev.: Gr. 1977'
DF 1982' KB 1985'

CASING RECORD

Report of all strings set — surface, intermediate, production, etc.

Purpose of string	Size hole drilled	Size casing set (in O.D.)	Weight lbs/ft.	Setting depth	Type cement	Sacks	Type and percent additives
Surface	12-1/4"	8-5/8"	24#	306'	Lite-weight Common	200 100	2% Gel, 3% CaCl
Production		4 1/2"	10.5#	4818'	50/50 Pozmix	150	18% NaCl

LINER RECORD

PERFORATION RECORD

Top, ft.	Bottom, ft.	Sacks cement	Shots per ft.	Size & type	Depth interval
N/A	N/A	N/A			
TUBING RECORD			4	Deep Penet.	4786-90'
Size	Setting depth	Packer set at			
N/A	N/A	4810'			

ACID, FRACTURE, SHOT, CEMENT SQUEEZE RECORD

Amount and kind of material used	Depth interval treated
4500 gal. acid; 200# BAF	4818-45' O.H. 4786-90'

INITIAL PRODUCTION

Date of first production <u>6-14-78</u>	Producing method (flowing, pumping, gas lift, etc.) <u>Flowing</u>				
RATE OF PRODUCTION PER 24 HOURS	Oil <u>N/A</u>	Gas <u>1020</u> bbls.	MCF <u>N/A</u>	Water <u>N/A</u>	Gas-oil ratio <u>N/A</u> bbls. CFPB
Disposition of gas (vented, used on lease or sold) <u>Gas Purchaser: Delhi Gas Pipeline Corp.</u>			Producing interval (s) <u>4786-90' (Ft. Scott) & 4818-45' O.H. (Mississippi)</u>		

INSTRUCTIONS: As provided in KCC Rule 82-2-125, within 90 days after completion of a well, one completed copy of this Drillers Log shall be transmitted to the State Geological Survey of Kansas, 4150 Monroe Street, Wichita, Kansas 67209. Copies of this form are available from the Conservation Division, State Corporation Commission, 3830 So. Meridian (P.O. Box 17027), Wichita, Kansas 66217. Phone AC 316-522-2206. If confidential custody is desired, please note Rule 82-2-125. Drillers Logs will be on open file in the Oil and Gas Division, State Geological Survey of Kansas, Lawrence, Kansas 66044.

Operator Texas Oil & Gas Corp. DESIGNATE TYPE OF COMP.: OIL, GAS, DRY HOLE, SWDW, ETC.:

Well No. 1 Lease Name Rusk "B" Gas Well

S 7 T 32S R 15 (W)

WELL LOG
 Show all important zones of porosity and contents thereof; cored intervals, and all drill-stem tests, including depth interval tested, cushion used, time tool open, flowing and shut-in pressures, and recoveries. SHOW GEOLOGICAL MARKERS, LOGS RUN, OR OTHER DESCRIPTIVE INFORMATION.

FORMATION DESCRIPTION, CONTENTS, ETC.	TOP	BOTTOM	NAME	DEPTH
Herington	2364	-379		
Cottonwood	2878	-893		
Indian Cave	3166	-1181		
Topeka	3595	-1610		
Heebner	4105	-2120		
Lansing	4258	-2273		
Swope	4580	-2595		
Hertha	4626	-2641		
Ft. Scott	4785	-2800		
Mississippi	4817	-2832		
TD	4845	-2860		
DST #1, 4817-45', (Mississippi) w/results as follows: IFP/30": 211-232#, GTS/2", gauged 1064 MCFD ISIP/60": 914# FFP/45": 211-232#, gauged 1105 MCFD & stable FSIP/90": 914# Rec 50' Mud.				

USE ADDITIONAL SHEETS, IF NECESSARY, TO COMPLETE WELL RECORD.

Date Received

Harold A. Brown
 HAROLD A. BROWN Signature
 District Geologist Title
 July 31, 1978 Date

