

WICHITA BRANCH
KANSAS DRILLERS LOG

IMPORTANT
Kans. Geol. Survey requests
samples on this well.

API No. 15 — 119 — 20,256
County Number

S. 24 T. 32S R. 29W E
W
Loc. C W/2 SE/4
County Meade

Operator
Imperial Oil Company

Address
720 Fourth Financial Center Wichita, Kansas 67202

Well No. 3-24 Lease Name SANDERS RANCH

Footage Location
1320 feet from ~~XXX~~ (S) line 660 feet from ~~XXX~~ (W) line

Principal Contractor Sage Drilling Co., Inc. Geologist Dick Roby

Spud Date 1-27-77 Total Depth RTD: 5739' P.B.T.D. LTD: 5745'

Date Completed 3-11-77 Oil Purchaser Gas well

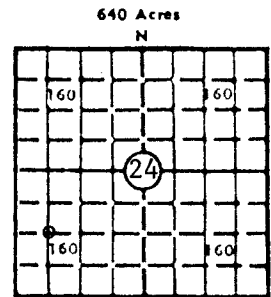

Elev.: Gr. 2638'
DF _____ KB 2649'

CASING RECORD

Report of all strings set — surface, intermediate, production, etc.

Purpose of string	Size hole drilled	Size casing set (in O.D.)	Weight lbs./ft.	Setting depth	Type cement	Sacks	Type and percent additives
Surf. casing	12 1/4"	8 5/8"		1536'	Liteweight Common	625 200	
Prod. casing	7 7/8"	5 1/2"		5736'	Halcolite Common	75 150	18% NaCl 12 1/2# Gilsontite

LINER RECORD

PERFORATION RECORD

Top, ft.	Bottom, ft.	Sacks cement	Shots per ft.	Size & type	Depth interval
			4	Bullets	5686-5704
			4	Bullets	5608-5624

TUBING RECORD

Size	Setting depth	Packer set at	Shots per ft.	Size & type	Depth interval
2 1/2"	5590'		4	Bullets	5608-5624

ACID, FRACTURE, SHOT, CEMENT SQUEEZE RECORD

Amount and kind of material used	Depth interval treated
2000 Gal. 15% MCA and 10,000 gal. Mod acid	5686-5704
Squeezed with 200 sacks Pozmix cement	5686-5704
500 Gal. 15% MCA & frac'd w/690 bbls oil & 13,500# sand	5608-5624

INITIAL PRODUCTION

Date of first production _____ Producing method (flowing, pumping, gas lift, etc.) _____

RATE OF PRODUCTION PER 24 HOURS	Oil	Gas	Water	Gas-oil ratio
	bbls.	7,500	MCF	bbls. None CFPB

Disposition of gas (vented, used on lease or sold) Will be sold to Michigan-Wisconsin Producing interval (s) 5608-5624

INSTRUCTIONS: As provided in KCC Rule 82-2-125, within 90 days after completion of a well, one completed copy of this Drillers Log shall be transmitted to the State Geological Survey of Kansas, 4150 Monroe Street, Wichita, Kansas 67209. Copies of this form are available from the Conservation Division, State Corporation Commission, 3830 So. Meridian (P.O. Box 17027), Wichita, Kansas 66217. Phone AC 316-522-2206. If confidential custody is desired, please note Rule 82-2-125. Drillers Logs will be on an open file in the Oil and Gas Division, State Geological Survey of Kansas, Lawrence, Kansas 66044.

Operator IMPERIAL OIL COMPANY		DESIGNATE TYPE OF COMP.: OIL, GAS, DRY HOLE, SWDW, ETC.:
Well No. 3-24	Lease Name SANDERS RANCH	GAS
S <u>24</u> T <u>32S</u> R <u>29W</u> E W		

WELL LOG

Show all important zones of porosity and contents thereof; cored intervals, and all drill-stem tests, including depth interval tested, cushion used, time tool open, flowing and shut-in pressures, and recoveries.

SHOW GEOLOGICAL MARKERS, LOGS RUN, OR OTHER DESCRIPTIVE INFORMATION.

FORMATION DESCRIPTION, CONTENTS, ETC.	TOP	BOTTOM	NAME	DEPTH
#1 DST: 5560-5598' 30-60-60-90 Rec. 50' mud. Weak blow. IBHP: 213# FBHP: 771# IFP: 53-50 FFP: 46-49			Heebner Lansing K. C. Marmaton Cherokee	4405 (-1756) 4547 (-1898) 4798 (-2149) 5156 (-2507) 5322 (-2673)
* #2 DST: 5601-5630' 60-120-180-120 Rec. 70' mud. Strong blow IBHP: 1714# FBHP: 1640# IFP: 78-88 FFP: 116-81			Atoka Morrow Chester	5550 (-2901) 5604 (-2955) 5668 (-3019)
#3 DST: 5623-5663' 30-60-120-120 Rec. 65' mud. Weak Blow IBHP: 503# FBHP: 1513# IFP: 85-85 FFP: 182-392				
#4 DST: 5669-5739' 60-120-180-120 Rec. 170' mud. Good blow, increased to strong blow. GTS in 85 min. on 2nd opening. 2,940 CFGD, stable. IBHP: 1379# FBHP: 1445# IFP: 78-63 FFP: 81-116				
**On #2 DST; Pre-Flow; in 40 min, gauge 162,000 CFGD in 60 min, 168,000 " Final Flow; in 20 min, gauge 193,000 CFGD 40 min, 191,000 CFGD 60 min, 191,000 CFGD 80 min, 191,000 CFGD 100 min, 189,000 CFGD & stabilized.				

USE ADDITIONAL SHEETS, IF NECESSARY, TO COMPLETE WELL RECORD.

Date Received	 Signature
	Exploration Manager Title
	May 9, 1977 Date
	Date