

KANSAS

WELL COMPLETION REPORT AND
DRILLER'S LOGAPI No. 15 — 119 — 20076
County Number

Operator

Leben Oil Corp.

Address

P.O. Box 35528, Tulsa, OK 74135

Well No.

#1

Lease Name

Roberts 'A'

Footage Location

990 feet from (N) line 990 feet from (E) line

Principal Contractor

Leben Drlg Corp

Geologist

Bill Broughton

Spud Date

6/27/71

Date Completed

7/11/71

Total Depth

6150'

P.B.T.D.

N/A

Directional Deviation

Oil and/or Gas Purchaser

Clear Creek

County Meade

640 Acres

N

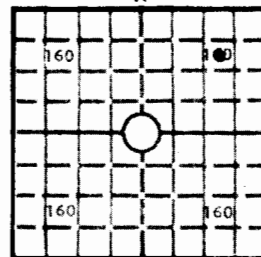

Locate well correctly

Elev.: Gr. 2698

DF 2706 KB 2709

CASING RECORD

Report of all strings set — surface, intermediate, production, etc.

Purpose of string	Size hole drilled	Size casing set (in O.D.)	Weight lbs/ft.	Setting depth	Type cement	Sacks	Type and percent additives
casing	8 5/8"	8 5/8"	24#	1459	common 50/50 poz	200 500	6% gel 2% cac1
Prod	4 1/2"	4 1/2"	9.5#	5320	common common	50 200	2% cac1 +500g sak-flush

LINER RECORD

LISTED BELOW IS REPORT
OF WORKOVER GAS WELL

PERFORATION RECORD

Top, ft.	Bottom, ft.	Sacks cement	Shots per ft.	Size & type	Depth interval
			2		5220' - 5330' OA
			2		4784' - 87'

TUBING RECORD

Size	Setting depth	Packer set at		
2"	5040'	none		

ACID, FRACTURE, SHOT, CEMENT SQUEEZE RECORD

Amount and kind of material used	Depth interval treated
perf Marm-Nov zn 4/5222' - 24', tested w/2000 gal acid.	5220' - 5330' OA

INITIAL PRODUCTION

Date of first production		Producing method (flowing, pumping, gas lift, etc.)			
5/72		flowing			
RATE OF PRODUCTION PER 24 HOURS	Oil	Gas	Water	Gas-oil ratio	
	0 bbls.	150 MCF	0 bbls.	0 CFPB	
Disposition of gas (vented, used on lease or sold)			Producing interval(s)		
sold			5220' - 5330' OA		

INSTRUCTIONS: As provided in KCC Rule 82-2-125, within 90 days after completion of a well, one completed copy of this Drillers Log shall be transmitted to the State Geological Survey of Kansas, 4150 Monroe Street, Wichita, Kansas 67209. Copies of this form are available from the Conservation Division, State Corporation Commission, 245 No. Water, Wichita, Kansas 67202. Phone AC 316-522-2206. If confidential custody is desired, please note Rule 82-2-125. Drillers Logs will be on open file in the Oil and Gas Division, State Geological Survey of Kansas, Lawrence, Kansas 66044.

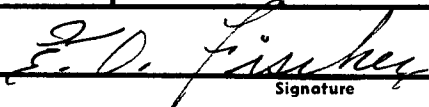
Operator		DESIGNATE TYPE OF COMP.: OIL, GAS, DRY HOLE, SWDW, ETC.:	
Well No. #1	Lease Name Roberts "A"	gas	
S <u>29</u> T <u>32</u> SR <u>29</u> ^E _W			
WELL LOG <small>Show all important zones of porosity and contents thereof; cored intervals, and all drill-stem tests, including depth interval tested, cushion used, time tool open, flowing and shut-in pressures, and recoveries.</small>		<small>SHOW GEOLOGICAL MARKERS, LOGS RUN, OR OTHER DESCRIPTIVE INFORMATION.</small>	
FORMATION DESCRIPTION, CONTENTS, ETC.	TOP	BOTTOM	NAME
Wreford	3008'		
Council Grove	3052'		
Heebner	4396'		
Toronto	4420'		
Lansing	4521'		
K City	4783'		
Hodges Zone	5046'		
Marmaton	5141'		
Novinger Zone	5220'		
Cherokee	5330'		
Morrow Shale	5616'		
Morrow Sand	5648'		
Chester	5684'		
St. Genevieve	5930'		
St. Louis	6012'		
Porosity	6086'		
USE ADDITIONAL SHEETS, IF NECESSARY, TO COMPLETE WELL RECORD.			
Date Received	<div style="margin-bottom: 10px;">  Signature </div> <div style="margin-bottom: 10px;"> Manager of Production Title </div> <div> August 26, 1980 Date </div>		

KANSAS CORPORATION COMMISSION

WELL RECORD

29-32-29W

Mail to Kansas Geological Survey, 4150 Monroe Street, Wichita, Kansas 67209

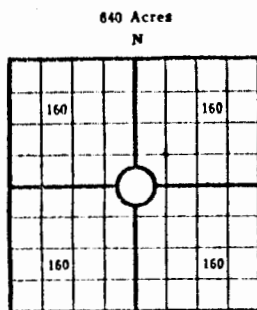

Lease Name: Roberts A Well No. 1
 Well Located: Meade County, Kansas
SW NE NE SEC 29 TWP 32S RGE 29W
 Operator: Leben Oil Corporation
 Address: 200 West Douglas, Wichita, Kansas
 Elevation: Ground 2698 D.F. 2706 K.B. 2709
 Type Well: (Oil, gas, dry hole) Dry Hole

Drilling Commenced: 6-25 1971 Drilling Completed: 7-11 1971
 Well Completed: 7-11 1971 Total Depth 6150'
 Initial Production: _____

Casing Record

Size: 8 5/8" Set at 1460' Size: _____ Set at _____
 Size: 4 1/2" Set at 5320' Size: _____ Set at _____

Liner Record

Size: _____ Set from _____ To _____

Cementing

Casing Size	Sacks	Type Cement and Additives
<u>8 5/8"</u>	<u>500</u>	<u>50-50 Poz. 6% Gel, 2% CaCl</u>
_____	_____	_____
_____	_____	_____

Perforations

Formation	Perforated Interval and Number Shots
_____	_____
_____	_____
_____	_____
_____	_____

Electric Log Run (Show type log and depths covered)

29-32-29w

Show Drill Stem Tests,
Well Stimulation and
Production Tests

Formation	Top	Bottom	
Wreford	3008		DST #1 4788-97/120" (straddle) 30" preflow/ gas to surface in 12" too small too measure Reopen with gas/15" - 16 MCF, 60" - 11 MCF, 90" - 11 MCF Rec. 360' heavy gas and distillate (over 60 gravity @ 65 degrees) slightly water cut, 360' water (175,000) mud is 26,000 ppm, FP 24-72# 145-363# ISIP 1500#/45" FSIP 1548#/45"
Council Grove	3052		
Heebner	4396		
Toronto	4420		
Lansing	4521		
Kansas City	4783		DST #2 5225-32/90", 30" preflow/ gas to surface in 4", no gauge, Reopen/10" - 2,522 MCF, 30" - 2,085 MCF, 60" - 2,085 MCF, Rec. 50' heavy gas and distillate cut mud, watery in bottom, (52,5000 ppm) mud (25,000 ppm), FP 501-528# 422-462# ISIP 1751#/45" FSIP 1711#/60"
Hodges Zone	5046		
Marmaton	5141		
Novinger Zone	5220		
Cherokee	5330		
Morrow Shale	5616		DST #3 5642-76/60" 30" preflow/ very weak blow, Reopen/very weak blow, Rec. 40' mud, FP 13-27# ISIP 92#/30" FSIP 66#/30"
Morrow Sand	5648		
Chester	5684		
St. Genevieve	5930		
St. Louis	6012		
Porosity	6086		



WELL LOG

29-32-2940
SW NE NE

SEP 4 1971

Company Leben Oil Corporation

Contractor Leben Drilling, Inc.

Farm Roberts A-1

Total Depth 6151'

Commenced June 26, 1971

Completed July 12, 1971

Sec. 29 T. 32S R. 29W

Loc. SW NE NE

County Meade Co., Kansas

Casing 8 5/8" 1448' W/500 Sx

Production 5 1/2" 5820' 150 Gx

GA 5, 145,000 CFGPD/NOV
(NEW PAY)

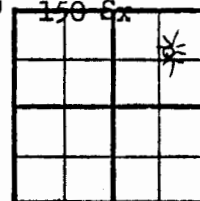

Figures Indicate Bottom of Formations

0 - 450' Surface Soil
450 - 1100' Sd, Red Bed
1100 - 1450' Red Bed & Gyp
1450 - 1460' Anhy
1460 - 1760' Anhy, Red Bed, Sh
1760 - 2390' Shells & Sh
2390 - 2603' Sh & Lm
2603 - 4275' Lm & Sh
4275 - 4460' Sh & Lm
4460 - 4533' Lm & Sh
4533 - 4684' Lm
4684 - 5040' Lm & Sh
5040 - 5321' Lm
5321 - 5385' Lm & Sh
5385 - 5450' Lm
5450 - 6102' Lm & Sh
6102 - 6151' Lm

LOG TOPS:

Wreford	3008
Council Grove	3052
Heebner	4396
Toronto	4420
Lansing	4521
Kansas City	4783
Hodges	5046
Marmaton	5141
Nov	5220
Cher	5330
Morrow Sh	5616
" Sd	5648
Chest	5684
Ste Gen	5930
St Louis	6012

DST (1) 4788-94 (SP) Failed
DST (2) 4788-97
DST (3) 5225-32
DST (4) 5642-76

State of OKLAHOMA

SS

County of OKLAHOMA