

15-191-20,931

KANSAS

WICHITA BRANCH

WELL COMPLETION REPORT AND DRILLER'S LOG

API No. 15 — 191 — 20931
 County Number

S. 7 T. 32S R. 3 **F**
W
 Loc. 2310' FNL & 2310' FWL
 County Sumner

Operator
 Texas Oil & Gas Corp.

Address
 200 West Douglas, Suite 300, Wichita, KS 67202

Well No. #1 Lease Name Edwards "E"

Footage Location
 2310 feet from (N) (S) line 2310 feet from (E) (W) line

Principal Contractor DNB Drilling Geologist Earl Moore

Spud Date 7-10-79 Date Completed 8-25-79 Total Depth 3150' P.B.T.D. 3000'

Directional Deviation not directionally drilled Oil and/or Gas Purchaser Delhi

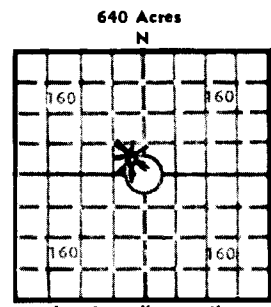

Locate well correctly
 Elev.: Gr. 1248'
 DF. KB 1253'

CASING RECORD

Report of all strings set — surface, intermediate, production, etc.

Purpose of string	Size hole drilled	Size casing set (in O.D.)	Weight lbs/ft.	Setting depth	Type cement	Sacks	Type and percent additives
Surface		8-5/8"		253'		250 sxs	
Production		4-1/2"		3145'	Class "A" lite	200	

LINER RECORD

PERFORATION RECORD

Top, ft.	Bottom, ft.	Sacks cement	Shots per ft.	Size & type	Depth interval
N/A	N/A	N/A	2 JSPF	N/A	3024-27' squeezed
TUBING RECORD			2 JSPF	N/A	3025-29'
			2 JSPF	4-1/2"	2498-2502'
Size 2-3/8"	Setting depth	Packer set at 2703'			
2-3/8"		2484'	2 JSPF	4-1/2"	1879-83'

ACID, FRACTURE, SHOT, CEMENT SQUEEZE RECORD

Amount and kind of material used	Depth interval treated
Acidized w/250 gal acetic acid, 250 gal 15% HCl, squeezed w/10 sxs cement	3024-27'
Acidized w/250 gal. 15% HCl	3025-29'
Acidized w/500 gal. 15% mud acid	2498-2502'
Acidized w/500 gal. 15% mud acid	1879-83'

INITIAL PRODUCTION

Date of first production 11-15-79 Producing method (flowing, pumping, gas lift, etc.) flowing

RATE OF PRODUCTION PER 24 HOURS	Oil	Gas	Water	Gas-oil ratio
	N/A bbls.	415 MCF	none bbls.	N/A CFPB

Disposition of gas (vented, used on lease or sold) Sold Producing interval(s) 2498-2502

INSTRUCTIONS: As provided in KCC Rule 82-2-125, within 90 days after completion of a well, one completed copy of this Drillers Log shall be transmitted to the State Geological Survey of Kansas, 4150 Monroe Street, Wichita, Kansas 67209. Copies of this form are available from the Conservation Division, State Corporation Commission, 245 No. Water, Wichita, Kansas 67202. Phone AC 316-522-2206. If confidential custody is desired, please note Rule 82-2-125. Drillers Logs will be on open file in the Oil and Gas Division, State Geological Survey of Kansas, Lawrence, Kansas 66044.

Operator Texas Oil & Gas Corp. DESIGNATE TYPE OF COMP.: OIL, GAS, DRY HOLE, SWDW, ETC.:

Well No. #1 Lease Name Edwards "E" gas

S 7 T 32 R 3 E W

WELL LOG

Show all important zones of porosity and contents thereof; cored intervals, and all drill-stem tests, including depth interval tested, cushion used, time tool open, flowing and shut-in pressures, and recoveries.

SHOW GEOLOGICAL MARKERS, LOGS RUN, OR OTHER DESCRIPTIVE INFORMATION.

FORMATION DESCRIPTION, CONTENTS, ETC.	TOP	BOTTOM	NAME	DEPTH
Herington	818	+435		
Wreford	1171	+82		
Cottonwood	1338	-85		
Onaga	1590	-337		
Wabaunsee	1683	-430		
Topeka	2262	-1009		
Elgin	2497	-1244		
Heebner	2661	-1408		
Douglas grp.	2693	-1440		
Iatan	2974	-1721		
Stalnaker	3013	-1760		
TD	3150			
PBTD	3000			
DST #1 1580-1695' (Wabaunsee), w/results as follows:				
IFP/30": 235-165# GTS in 5 min., 577 MCF/D decr.				
ISIP/60": 777#				
FFP/45": 236-131#, 577 MCF/D decr.				
FSIP/90": 770#, IH 785, FH 749				
No recovery due to blow out.				
DST #2, 1839-87' (Langdon), w/results as follows:				
Mis-run.				
DST #3, 2470-2510' (Elgin), w/results as follows:				
IFP/30": 59-95# GTS in 10" @ 133 MCF/D inc. to 177				
ISIP/60": 1152#				
FFP/45": 95-95#, 243 MCF/D inc. to 285 and stab.				
FSIP/90": 1152				
Rec: 62 mud				

USE ADDITIONAL SHEETS, IF NECESSARY, TO COMPLETE WELL RECORD.

Date Received

Harold A. Brown
 HAROLD A. BROWN Signature
 District Exploration Manager Title
 November 15, 1979 Date

15-191-20931

7-32-3W

Geological Survey
WICHITA BRANCH

DRILLER'S LOG

TEXAS OIL & GAS CORPORATION
No. 1 Edwards 'E'
2310 FNL & 2310 FWL
Sec. 7-32S-3W
Summer Co., KS.

Commenced: 7-10-79
Completed: 7-22-79

Surface Casing: 247.98' of
8 5/8" cmtd w/250 sg cement.
7-10-79.

<u>FORMATION</u>	<u>DEPTH</u>
Surface Hole	0 - 103
Shale	103 - 2260
Sand	260 - 783
Shale & lime	783 - 1695
Lime & shale	1695 - 1766
Shale & lime	1766 - 1887
Lime	1887 - 1986
Shale & lime	1986 - 2080
White cloud	2080 - 2092
Shale & lime	2092 - 2232
Lime	2232 - 2353
Shale & lime	2353 - 2493
Elgin sand	2493 - 2510
Shale & lime	2510 - 3150 RTD

I do hereby certify that the foregoing statements are true and correct to the best of my knowledge and belief.

D N B DRILLING, INC.

Ella Press

Ella Press

STATE OF KANSAS: ss:

Subscribed and sworn to before me this 27th day of July, 1979.

Dorothy L. Schmidt

Dorothy L. Schmidt, Notary Public

