

WICHITA BRANCH
KANSAS DRILLERS LOG

IMPORTANT
Kans. Geo. Survey request samples on this well.

API No. 15 — 191 — 20,971 ✓
County Number

S. 32 T. 32 R. 3 W
Loc. 330' FSL & 2310' FWL SW
County Sumner

Operator
Texas Oil & Gas Corp.

Address 200 West Douglas, Suite 300 Wichita, Kansas 67202

Well No. #1 Lease Name Stewart "A"

Footage Location
330 feet from (N) (S) line 2310 feet from (E) (W) line

Principal Contractor Slawson Drilling Geologist Earl Moore

Spud Date 10-27-79 Total Depth 3450' P.B.T.D. 3063'

Date Completed 11-14-79 Oil Purchaser N/A

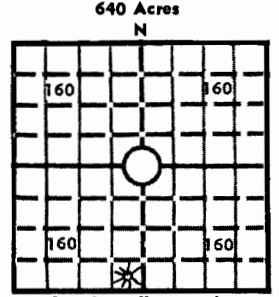

Locate well correctly
Elev.: Gr. 1215'
DF KB 1220'

CASING RECORD

Report of all strings set — surface, intermediate, production, etc.

Purpose of string	Size hole drilled	Size casing set (in O.D.)	Weight lbs/ft.	Setting depth	Type cement	Sacks	Type and percent additives
Surface		8-5/8"	28#	258'		150	
Production		2-7/8"		3098'		150	

LINER RECORD

PERFORATION RECORD

Top, ft.	Bottom, ft.	Sacks cement	Shots per ft.	Size & type	Depth interval
N/A	N/A	N/A	2 JSPF	N/A	3010-13'
TUBING RECORD					
Size	Setting depth	Packer set at			
N/A	N/A	N/A	2 JSPF	N/A	3010-13'

ACID, FRACTURE, SHOT, CEMENT SQUEEZE RECORD

Amount and kind of material used	Depth interval treated
Acidized w/250 gal. 15% HCl	3010-13'
Dumped 12 bbls 2% KCl water	3010-13'
Acidized w/250 gals. 15% HCl	3010-13'

INITIAL PRODUCTION

Date of first production 1-4-80	Producing method (flowing, pumping, gas lift, etc.) flowing
RATE OF PRODUCTION PER 24 HOURS	Oil N/A bbls. Gas 890 MCF Water none bbls. Gas-oil ratio N/A CFPB
Disposition of gas (vented, used on lease or sold) Delhi	Producing interval (s) 3010-13'

INSTRUCTIONS: As provided in KCC Rule 82-2-125, within 90 days after completion of a well, one completed copy of this Drillers Log shall be transmitted to the State Geological Survey of Kansas, 4150 Monroe Street, Wichita, Kansas 67209. Copies of this form are available from the Conservation Division, State Corporation Commission, 3830 So. Meridian (P.O. Box 17027), Wichita, Kansas 66217. Phone AC 316-522-2206. If confidential custody is desired, please note Rule 82-2-125. Drillers Logs will be on open file in the Oil and Gas Division, State Geological Survey of Kansas, Lawrence, Kansas 66044.

.rator

Texas Oil & Gas Corp.

DESIGNATE TYPE OF COMP.: OIL, GAS, DRY HOLE, SWDW, ETC.:

Well No. #1	Lease Name Stewart "A"	gas
----------------	---------------------------	-----

S 32 T 32 R 3 ^E/_W

WELL LOG

Show all important zones of porosity and contents thereof; cored intervals, and all drill-stem tests, including depth interval tested, cushion used, time tool open, flowing and shut-in pressures, and recoveries.

SHOW GEOLOGICAL MARKERS, LOGS RUN, OR OTHER DESCRIPTIVE INFORMATION.

FORMATION DESCRIPTION, CONTENTS, ETC.	TOP	BOTTOM	NAME	DEPTH
Herington	770	+450		
Cottonwood	1353	-133		
Onaga	1568	-348		
Wabaunsee	1689	-469		
Topeka	2272	-1052		
Heebner	2666	-1446		
Iatan	2994	-1774		
Stalnaker	3008	-1788		
Kansas City	3310	-2090		
TD	3450			
PBTD	3063			
DST #1, 2994-3013' (Stalnaker), w/results as follows:				
IFP/30": 188-398#, GTS 2"=2075 inc. to 2675 MCFD				
ISIP/60": 1149#				
FFP/30": 356-440#, 3036 MCFD w/light mist				
FSIP/60": 1169#				
Rec. 20' GC mud, 65' muddy water				

USE ADDITIONAL SHEETS, IF NECESSARY, TO COMPLETE WELL RECORD.

Date Received	
	HAL BROWN Signature
	District Exploration Manager Title
	January 11, 1980 Date

DRILLERS LOG

OPERATOR: Texas Oil & Gas Corp.
200 West Douglas Street
Wichita, Kansas 67202

LEASE: Stewart 'A' #1
SE SE SW Sec. 32-32S-3W
Summer County, Kansas

CONTRACTOR: Slawson Drilling Company, Inc.
200 Douglas Building
Wichita, Kansas 67202

COMMENCED: 10/27/79

COMPLETED: 11/5/79

RTD: 3450'

CONDUCTOR PIPE: 13-3/8" set at 64'

SURFACE CASING: 8-5/8" set at 258' with 150 sx cement

PRODUCTION CASING: 2-7/8" set at 3098' with 150 sx cement

0' to 64' Conductor Pipe
64' to 266' 12 1/2" Surface Hole
266' to 1893' Shale
1893' to 2220' Shale & Lime
2220' to 2735' Shale
2735' to 3013' Shale & Lime
3013' to 3185' Lime & Shale
3185' to 3450' Shale & Lime
3450' Lime
RTD 3450'

STATE OF KANSAS

COUNTY OF SEDGWICK

I, James C. Remsberg, of the Slawson Drilling Company, Inc.
hereby state the above is an accurate copy of the Stewart 'A' #1 log
for Texas Oil & Gas Corp.

James C. Remsberg

Subscribed and sworn to me this
16th day of November 1979

Mary Lou Taylor, Notary

RECEIVED
STATE OF KANSAS