

KANSAS DRILLERS LOG

API No. 15 — 175 — 20,399
 County Number

Operator Kennedy & Mitchell, Inc. OCT - 1979

Address PO Box 1578, Liberal, Kansas 67901

Well No. #24-355 Lease Name Angell

Footage Location
1980 feet from ~~XX~~ (S) line 660 feet from (E) ~~XX~~ line

Principal Contractor DaMac Drilling Company Geologist _____

Spud Date 4-2-79 Total Depth 6000 P.B.T.D. 3655

Date Completed 4-17-79 Oil Purchaser _____

State Geological Survey
 WICHITA BRANCH
 S. 24 T. 32 S. R. 18 W

Loc. C NW SE
 County Seward

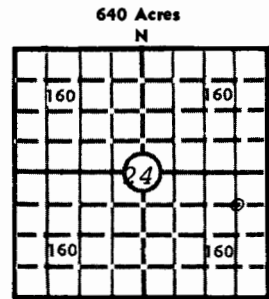

Elev.: Gr. 2781
 DF 2787 KB 2789

CASING RECORD

Report of all strings set — surface, intermediate, production, etc.

Purpose of string	Size hole drilled	Size casing set (in O.D.)	Weight lbs/ft.	Setting depth	Type cement	Sacks	Type and percent additives
Surface	12 1/2"	8 5/8"	24#	1497'	Howco lite class H	600 150	2%cc, 1/2# flocele, 3%cc
Production	7 7/8"	4 1/2"	10.5#	6000'	class H	50	8%gel, 10%salt, 12 1/2#gilsonite
					50/50 pozmix	125	18%salt, 12 1/2#gilsonite, .75%CFR-2

LINER RECORD

PERFORATION RECORD

Top, ft.	Bottom, ft.	Sacks cement	Shots per ft.	Size & type	Depth interval
			4 spf	.53 DML	5636-38
			2 spf	.38 J	5526-32
TUBING RECORD			2 spf	.38 J	5465-67; 5475-78
			2 spf	.38 J	4709-14
Size	Setting depth	Packer set at	4 spf	.38 J	3811-13
2 3/8"	3603'	3603'	2 spf	.38 J	3632-38

ACID, FRACTURE, SHOT, CEMENT SQUEEZE RECORD

Amount and kind of material used	Depth interval treated
50 sacks class H cement w/8% Halad 9 & 100 sacks class H cmt 500 gal 15% NE acid	5636-38 5526-32
500 gal 15% MCH acid	5465-67; 5475-78
500 gal 15% NE acid	4709-14

INITIAL PRODUCTION

Date of first production _____ Producing method (flowing, pumping, gas lift, etc.) _____

RATE OF PRODUCTION PER 24 HOURS	Oil	Gas	Water	Gas-oil ratio
	bbls.	MCF	bbls.	CFPB
Disposition of gas (vented, used on lease or sold)			Producing interval (s)	

INSTRUCTIONS: As provided in KCC Rule 82-2-125, within 90 days after completion of a well, one completed copy of this Drillers Log shall be transmitted to the State Geological Survey of Kansas, 4150 Monroe Street, Wichita, Kansas 67209. Copies of this form are available from the Conservation Division, State Corporation Commission, 3830 So. Meridian (P.O. Box 17027), Wichita, Kansas 66217. Phone AC 316-522-2206. If confidential custody is desired, please note Rule 82-2-125. Drillers Logs will be on open file in the Oil and Gas Division, State Geological Survey of Kansas, Lawrence, Kansas 66044.

Operator <i>Kennedy & Mitchell, Inc.</i>		DESIGNATE TYPE OF COMP.: OIL, GAS, DRY HOLE, SWDW, ETC.: <i>Dry Hole</i>
Well No. <i>#24-355</i>	Lease Name <i>Angell</i>	
S <u>24</u> T <u>32S</u> R <u>31</u> ^K / _W		

WELL LOG

Show all important zones of porosity and contents thereof; cored intervals, and all drill-stem tests, including depth interval tested, cushion used, time tool open, flowing and shut-in pressures, and recoveries.

SHOW GEOLOGICAL MARKERS, LOGS RUN, OR OTHER DESCRIPTIVE INFORMATION.

FORMATION DESCRIPTION, CONTENTS, ETC.	TOP	BOTTOM	NAME	DEPTH
<i>Sand, Red Bed</i>	<i>0</i>	<i>825</i>		
<i>Sand, Shale</i>	<i>825</i>	<i>1500</i>		
<i>Shale</i>	<i>1500</i>	<i>2515</i>		
<i>Lime, Shale</i>	<i>2515</i>	<i>5105</i>		
<i>lime</i>	<i>5105</i>	<i>6000RTD</i>		

USE ADDITIONAL SHEETS, IF NECESSARY, TO COMPLETE WELL RECORD.

Date Received	<i>Harold K Frank</i> Signature
	<i>Kennedy & Mitchell, Inc. Agent</i> Title
	<i>October 3, 1979</i> Date