

KANSAS DRILLERS LOG

State Geological Survey
WICHITA, KANSAS

S. 24 T. 32 R. 31 ^{EX} W

API No. 15 — 175 — 20,507
County Number

Loc. C-24 NE SW

County Seward

Operator
Whitaker Enterprises, Inc.

Address
Box 6 Liberal, Ks. 67901

Well No. #1-24 Lease Name Hayden

Footage Location
1650 feet from (X) (S) line 1980 feet from (X) (W) line

Principal Contractor Sage Drlg. Co., Inc. Geologist

Spud Date 12/27/80 Total Depth 6000' P.B.T.D.

Date Completed 1/7/81 Oil Purchaser PTA

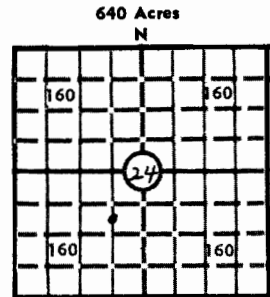

Locate well correctly

Elev.: Gr. 2777

DF KB 2788

10 @ 5930'

CASING RECORD

Report of all strings set — surface, intermediate, production, etc.

Purpose of string	Size hole drilled	Size casing set (in O.D.)	Weight lbs/ft.	Setting depth	Type cement	Sacks	Type and percent additives
Surf	12-1/4	8-5/8	23	1682	35/65 Pozmix	700	1/4# D-29 2% CC
					Class H	200	1/4# D-29 3% CC

LINER RECORD

PERFORATION RECORD

Top, ft.	Bottom, ft.	Sacks cement	Shots per ft.	Size & type	Depth interval

Size	Setting depth	Packer set at

ACID, FRACTURE, SHOT, CEMENT SQUEEZE RECORD

Amount and kind of material used	Depth interval treated

INITIAL PRODUCTION

Date of first production PTA Producing method (flowing, pumping, gas lift, etc.)

RATE OF PRODUCTION PER 24 HOURS
Oil bbls. Gas MCF Water bbls. Gas-oil ratio CFPB

Disposition of gas (vented, used on lease or sold) Producing interval (s)

INSTRUCTIONS: As provided in KCC Rule 82-2-125, within 90 days after completion of a well, one completed copy of this Drillers Log shall be transmitted to the State Geological Survey of Kansas, 4150 Monroe Street, Wichita, Kansas 67209. Copies of this form are available from the Conservation Division, State Corporation Commission, 3830 So. Meridian (P.O. Box 17027), Wichita, Kansas 66217. Phone AC 316-522-2206. If confidential custody is desired, please note Rule 82-2-125. Drillers Logs will be on open file in the Oil and Gas Division, State Geological Survey of Kansas, Lawrence, Kansas 66044.

Operator Whitaker Enterprises, Inc.		DESIGNATE TYPE OF COMP.: OIL, GAS, DRY HOLE, SWDW, ETC.: Dry Hole
Well No. 1-24	Lease Name Hayden	
S 24 T 32 R 31 ^W X		

WELL LOG

Show all important zones of porosity and contents thereof; cored intervals, and all drill-stem tests, including depth interval tested, cushion used, time tool open, flowing and shut-in pressures, and recoveries.

SHOW GEOLOGICAL MARKERS, LOGS RUN, OR OTHER DESCRIPTIVE INFORMATION.

FORMATION DESCRIPTION, CONTENTS, ETC.	TOP	BOTTOM	NAME	DEPTH
DST #1; 15,30,30,30 min. no blo - rec. 40' drlg. mud - IH 2904#, FH 2817#, IF 32#, FF 43#; ISIP 1476#, FSIP 1114#.	5878	5930		
DST #2; 15,30,60,60 min. sto blo, NGTS- rec. 120' sli O&GCM - IH 2976#, FH 2927# IF 166#, FF 200#; ISIP 433#, FSIP 733#.	5485	5526		
Ran DIL, CNL - FDC OH Logs				

USE ADDITIONAL SHEETS, IF NECESSARY, TO COMPLETE WELL RECORD.

Date Received	 Signature
	Eng Title
	1/14/81 Date