

STATE CORPORATION COMMISSION OF KANSAS
OIL & GAS CONSERVATION DIVISION

WELL COMPLETION OR RECOMPLETION FORM
ACO-1 WELL HISTORY

DESCRIPTION OF WELL AND LEASE

Operator: License # 5263
Name: Midwestern Exploration Co.
Address: P.O. Box 1884
City/State/Zip: Liberal, KS 67905-1884

Purchaser: Enron Gas Supply Co.
Tulsa, Oklahoma

Operator Contact Person: Harold K. Frauli
Phone: (316) 624-3534

Contractor: License # 5421
Name: Sage Drilling Co., Inc.

Wellsite Geologist: Joe Blair
Phone: (405) 366-7558

Designate Type of Completion
 New Well Re-Entry Workover
 Oil SWD Temp Abd
 Gas Inj Delayed Comp.
 Dry Other (Core, Water Supply etc.)

If ONWO: old well info as follows:
Operator
Well Name
Comp. Date
Old Total Depth

WELL HISTORY

Drilling Method:
 Mud Rotary Air Rotary Cable
Spud Date: 10-21-88 Date Reached TD: 10-24-88 Completion Date: 11-16-88
Total Depth: 2800' PBTD: 2751'

Amount of Surface Pipe Set and Cemented at: 629 feet
Multiple Stage Cementing Collar Used? Yes No
If yes, show depth set: feet
If alternate 2 completion, cement circulated from: feet depth to: w/ SX cmt

API NO. 15-175-21,050
County: Seward
SW/4 NE/4 NE/4 Sec. 7 Twp. 32S Rge. 32 East West
4030 Ft North from Southeast Corner of Section
1250 Ft West from Southeast Corner of Section
(Note: Locate well in section plat below)
Lease Name: Dorothy Well #: 1-7
Field Name: Hugoton
Producing Formation: Herrington
Elevation: Ground: 2852 KB: 2864

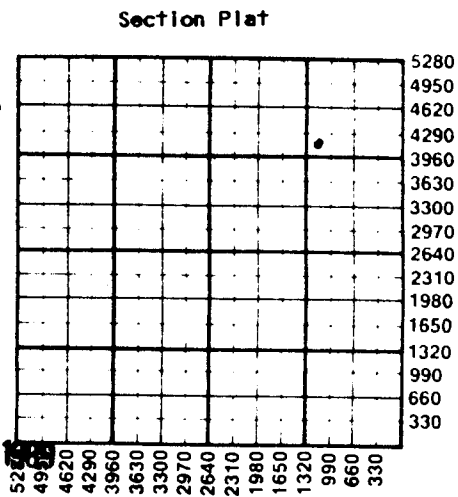

RECEIVED
STATE CORPORATION COMMISSION

JAN 4 1989

CONSERVATION DIVISION
Wichita, Kansas

JAN 05 1989

KANSAS GEOLOGICAL SURVEY
WICHITA BRANCH

WATER SUPPLY INFORMATION
Disposition of Produced Water: Disposal Repressuring
Docket #

Questions on this portion of the ACO-1 call:
Water Resources Board (913) 296-3717
Source of Water:
Division of Water Resources Permit # T. 88-523
 Groundwater: 474.5 Ft North from Southeast Corner (Well) 489.5 Ft West from Southeast Corner of Sec 7 Twp 32S Rge 32 East West
 Surface Water: Ft North from Southeast Corner (Stream, pond etc) Ft West from Southeast Corner Sec Twp Rge East West
 Other (explain) (purchased from city, R.W.D. #)

INSTRUCTIONS: This form shall be completed in duplicate and filed with the Kansas Corporation Commission, 200 Colorado Derby Building, Wichita, Kansas 67202, within 90 days after completion or recompletion of any well. Rule 82-3-130 and 82-3-107 apply. Information on side two of this form will be held confidential for a period of 12 months if requested in writing and submitted with the form. See rule 82-3-107 for confidentiality in excess of 12 months. One copy of all wireline logs and drillers time log shall be attached with this form. Submit CP-4 form with all plugged wells. Submit CP-111 form with all temporarily abandoned wells.

All requirements of the statutes, rules and regulations promulgated to regulate the oil and gas industry have been fully complied with and the statements herein are complete and correct to the best of my knowledge.

Signature: Harold K. Frauli

Title: Agent Date: 12-30-88

Subscribed and sworn to before me this 30th day of December 1988

Notary Public: Mary Morgan

Date Commission Expires: 8-3-92

K.C.C. OFFICE USE ONLY
F Letter of Confidentiality Attached
C Wireline Log Received
C Drillers Time Log Received
Distribution
 KCC SWD/Rep NGPA
 KGS Plug Other (Specify)

Sec. 7, Twp. 32R, Rge. 35W

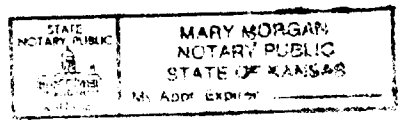

SIDE TWO

Operator Name Midwestern Exploration Co. Lease Name..... Dorothy Well #..... 1-7

Sec..... 7 Twp..... 32S Rge..... 32 East West County..... Seward

WELL LOG

INSTRUCTIONS: Show important tops and base of formations penetrated. Detail all cores. Report all drill stem tests giving interval tested, time tool open and closed, flowing and shut-in pressures, whether shut-in pressure reached static level, hydrostatic pressures, bottom hole temperature, fluid recovery, and flow rates if gas to surface during test. Attach extra sheet if more space is needed. Attach copy of log.

| Drill Stem Tests Taken | <input type="checkbox"/> Yes | <input checked="" type="checkbox"/> No | Formation Description <input checked="" type="checkbox"/> Log <input type="checkbox"/> Sample <table border="0"> <thead> <tr> <th>Name</th> <th>Top</th> <th>Bottom</th> </tr> </thead> <tbody> <tr> <td>Herrington</td> <td>2661</td> <td></td> </tr> <tr> <td>Upper Krider</td> <td>2689</td> <td></td> </tr> <tr> <td>Lower Krider</td> <td>2716</td> <td></td> </tr> <tr> <td>Winfield</td> <td>2770</td> <td></td> </tr> </tbody> </table> | Name | Top | Bottom | Herrington | 2661 | | Upper Krider | 2689 | | Lower Krider | 2716 | | Winfield | 2770 | |
|-----------------------------------|---|--|--|------|-----|--------|------------|------|--|--------------|------|--|--------------|------|--|----------|------|--|
| Name | Top | Bottom | | | | | | | | | | | | | | | | |
| Herrington | 2661 | | | | | | | | | | | | | | | | | |
| Upper Krider | 2689 | | | | | | | | | | | | | | | | | |
| Lower Krider | 2716 | | | | | | | | | | | | | | | | | |
| Winfield | 2770 | | | | | | | | | | | | | | | | | |
| Samples Sent to Geological Survey | <input checked="" type="checkbox"/> Yes | <input type="checkbox"/> No | | | | | | | | | | | | | | | | |
| Cores Taken | <input type="checkbox"/> Yes | <input checked="" type="checkbox"/> No | | | | | | | | | | | | | | | | |

| CASING RECORD <input type="checkbox"/> New <input type="checkbox"/> Used | | | | | | | |
|---|---|--|----------------|---|----------------|-------------|----------------------------|
| Report all strings set-conductor, surface, intermediate, production, etc. | | | | | | | |
| Purpose of String | Size Hole Drilled | Size Casing Set (in O.D.) | Weight Lbs/Ft. | Setting Depth | Type of Cement | #Sacks Used | Type and Percent Additives |
| Surface | | 8 5/8" | 25 | 629 | Lite | 150 | 2% cc |
| | | | | | Class C | 125 | 2% cc |
| Production | | 4 1/2" | 10.5 | 2799 | Lite | 400 | # Flocele |
| | | | | | Class H | 125 | 5% KCL |
| PERFORATION RECORD | | | | Acid, Fracture, Shot, Cement Squeeze Record | | | |
| Shots Per Foot | Specify Footage of Each Interval Perforated | | | (Amount and Kind of Material Used) | | Depth | |
| 2 | 2724-30' | | | 500 gal. 15% FE Acid | | | |
| 2 | 2744-50' | | | 3000 gal. 20% FE Acid w/30% N2 | | | |
| 4 | 2694-98' | | | 500 gal. 15% FE Acid | | | |
| 4 | 2681-86' | | | 1000 gal. 15% FE Acid | | | |
| 4 | 2662-68' | | | 500 gal. 15% FE Acid | | | |
| | | | | 3000 gal. 20% FE Acid w/30% N2 | | | |
| TUBING RECORD | | | | Liner Run <input type="checkbox"/> Yes <input checked="" type="checkbox"/> No | | | |
| Size 2 3/8" | | Set At 2656 | | Packer at None | | | |
| Date of First Production | | Producing Method <input type="checkbox"/> Flowing <input type="checkbox"/> Pumping <input type="checkbox"/> Gas Lift <input type="checkbox"/> Other (explain)..... | | | | | |
| CURRENTLY WAITING ON | | PIPELINE CONNECTION | | | | | |
| Estimated Production Per 24 Hours | Oil | Gas | Water | Gas-Oil Ratio | Gravity | | |
| | 0 | 217 | 15 | | | | |
| | Bbls | MCF | Bbls | CFPB | | | |

METHOD OF COMPLETION Production Interval

Disposition of gas: Vented Open Hole Perforation
 Sold Other (Specify)
 Used on Lease

Dually Completed
 Commingled