

15-175-20354

State Geological Survey

WICHITA BRANCH
KANSAS DRILLERS LOG

API No. 15 — 175 — 20354
County Number

Operator
Cities Service Company

Address
3545 N. W. 58th St. Oklahoma City, OK 73112

Well No. 1 Lease Name Alexander J

Footage Location
1320 feet from (N) line 1980' feet from (E) line of SE/4

Principal Contractor Geologist
E.F. Wakefield Drilling Co.

Spud Date 3-24-78 Total Depth 4475' P.B.T.D.

Date Completed P&A 4-4-1978 Oil Purchaser

S. 22 T. 32S R. 32 W
Loc. 1320' FSL, 1980' FEL of SE/4
County Seward

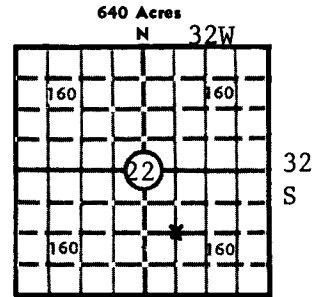

Locate well correctly
Elev.: Gr. 2820'
DF 2827 KB 2828'

CASING RECORD

Report of all strings set — surface, intermediate, production, etc.

Purpose of string	Size hole drilled	Size casing set (in O.D.)	Weight lbs/ft.	Setting depth	Type cement	Sacks	Type and percent additives
Surface	12 1/4"	8-5/8"	24#	1689'	Class H.	850	Cemented w/750 sx 50/50 Pozmix, w/3%
	added gel, 2% CaCl, 1/2# Flocele, followed by 100 sx 60/40 Pozmix, 3% CaCl, 1/2# Flocele. Cement circulated to surface.						

LINER RECORD

PERFORATION RECORD

Top, ft.	Bottom, ft.	Sacks cement	Shots per ft.	Size & type	Depth interval

Size	Setting depth	Packer set at

ACID, FRACTURE, SHOT, CEMENT SQUEEZE RECORD

Amount and kind of material used	Depth interval treated
N/A	N/A

INITIAL PRODUCTION

Date of first production	Producing method (flowing, pumping, gas lift, etc.)				
Dry Hole - NO TEST WAS CONDUCTED					
RATE OF PRODUCTION PER 24 HOURS	Oil	Gas	Water	Gas-oil ratio	
	bbls.	MCF	bbls.	CFPB	
Disposition of gas (vented, used on lease or sold)			Producing interval (s)		

INSTRUCTIONS: As provided in KCC Rule 82-2-125, within 90 days after completion of a well, one completed copy of this Drillers Log shall be transmitted to the State Geological Survey of Kansas, 4150 Monroe Street, Wichita, Kansas 67209. Copies of this form are available from the Conservation Division, State Corporation Commission, 3830 So. Meridian (P.O. Box 17027), Wichita, Kansas 66217. Phone AC 316-522-2206. If confidential custody is desired, please note Rule 82-2-125. Drillers Logs will be on open file in the Oil and Gas Division, State Geological Survey of Kansas, Lawrence, Kansas 66044.

Operator

Cities Service Company

DESIGNATE TYPE OF COMP.: OIL, GAS, DRY HOLE, SWDW, ETC.:

Well No. 1	Lease Name Alexander J	Dry Hole
---------------	---------------------------	----------

S 22 T 32S R 32 E W

WELL LOG

Show all important zones of porosity and contents thereof; cored intervals, and all drill-stem tests, including depth interval tested, cushion used, time tool open, flowing and shut-in pressures, and recoveries.

SHOW GEOLOGICAL MARKERS, LOGS RUN, OR OTHER DESCRIPTIVE INFORMATION.

FORMATION DESCRIPTION, CONTENTS, ETC.	TOP	BOTTOM	NAME	DEPTH
Clay & Sand	0	465	Ran Schlumberger Dual Induction Laterolog, Compensated Formation Density, Borehole Compensated Sonic w/GR & Caliper	
Red Bed & Gypsum	465	1144		
Sand	1144	1285		
Red Bed	1285	1505		
Red Bed & Anhydrite	1505	1690		
Shale	1690	1990		
Shale & Lime	1990	2670		
Lime & Shale TD	2670	4475		

USE ADDITIONAL SHEETS, IF NECESSARY, TO COMPLETE WELL RECORD.

Date Received

H. E. Massey

H. E. Massey

Signature

Operating Manager

Title

April 11, 1978

Date

WELL RECORD

(Mail to Kansas Geological Survey, 4150 Monroe Street, Wichita, Kansas 67209)

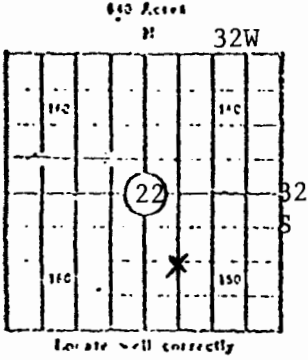

Lease Name: Alexander J Well No. 1
 Well Located: 1320' FSL, 1980' FEL of SE/4
SEC 22 TWP 32S RGE 32W
 Operator: Cities Service Company
 Address: 3545 N. W. 58th Street, Oklahoma City, OK 73112
 Elevation: Ground 2820' D.F. 2827' K.B. 2828'
 Type Well: (Oil, gas, dry hole) Dry Hole

Drilling Commenced: 3-24 1978 Drilling Completed: 4-4-1978
 Well ~~Completed~~ P&A: 4-4 1978 Total Depth 4475'
 Initial Production: N/A

Casing Record

Size: 8-5/8" Set at 1689' Size: Set at
 Size: Set at Size: Set at

Liner Record

Size: Set from To

Cementing

<u>Casing Size</u>	<u>Sacks</u>	<u>Type Cement and Additives</u>
<u>8-5/8"</u>	<u>850</u>	<u>Class H. Cemented w/750 sx 50/50 pozmix, w/3% added gel, 2% CaCl, 1/2# Flocele, followed by 100 sx 60/40 Pozmix, 3% CaCl, 1/4# Flocele. Cement circulated to surface.</u>
<u> </u>	<u> </u>	<u> </u>
<u> </u>	<u> </u>	<u> </u>

Perforations

<u>Formation</u>	<u>Perforated Interval and Number Shots</u>
<u> </u>	<u>N/A</u>
<u> </u>	<u> </u>
<u> </u>	<u> </u>
<u> </u>	<u> </u>

Electric Log Run. (Show type log and depths covered)

Ran Schlumberger Dual Induction Laterolog, Compensated Formation Density, Borehole Compensated Sonic w/CR & Caliper

(Fill in formation and related information on reverse side)

22-32-32w

FORMATION, TESTING AND COMPLETION RECORD

Show Drill Stem Tests,
Well Stimulation and
Production Tests

Formation	Top	Bottom	
& Sand	0	465	Ran DST # 1 Lansing 4280-4338' (58')
Bed & Gypsum	465	1144	
	1144	1285	
Bed	1285	1505	
Bed & Anhydrite	1505	1690	
	1690	1990	
Shale & Lime	1990	2670	
Lime & Shale	2670	4475	
TD		4475	