

15-1175-20444

KANSAS DRILLERS LOG
State Geological Survey
WICHITA, BRANCH

API No. 15 — 175 — 20444
 County Number

S. 26 T.32S R. 33 W
 Loc. 1650' FNL, 2310' FEL of NE/4
 County Seward

Operator
 Cities Service Company

Address
 3545 N.W. 58th Street, Oklahoma City, OK 73112

Well No. 1 Lease Name Cooper G

Footage Location
 1650 feet from (N) (S) line 2310 feet from (E) (W) line of NE/4

Principal Contractor Lohmann-Johnson Geologist

Spud Date 1-8-80 2-26-80 Total Depth 5795' P.B.T.D. 5738'

Date Completed 3-6-80 Oil Purchaser Permian Corporation

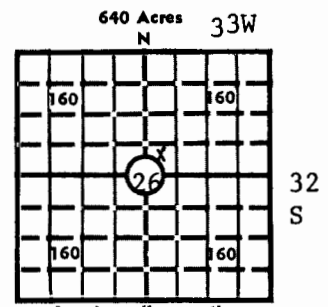

Elev.: Gr. 2743
 DF 2751' KB 2752'

CASING RECORD

Report of all strings set— surface, intermediate, production, etc.

Purpose of string	Size hole drilled	Size casing set (in O.D.)	Weight lbs/ft.	Setting depth	Type cement	Socks	Type and percent additives
Surface	12 1/4"	8 5/8"	24#	1582'	Class H	800	Cemented w/700 sx 65/35 Pozmix with 6% gel, 2% CaCl & 1/2# D-29; followed w/100 sx 60/40 Pozmix w/3% CaCl & 1/4# D-29. Cement circulated to surface
Production	7 7/8"	5 1/2"	14#	5785'	Class H	222	Cemented w/72 sx 35/65 Light Pozmix w/6% total gel, 1/4# D-29, 8/10 of 1% D-65, 10% salt, followed w/150 sx 50/50 Pozmix 4% total gel, 1/4# D-29, 8/10 of 1% D-65 & 10% salt

LINER RECORD

PERFORATION RECORD

Top, ft.	Bottom, ft.	Sacks cement	Shots per ft.	Size & type	Depth interval
---	---	---	4	057 SD,J	Chester Sd: 5619 - 20'

TUBING RECORD

Size	Setting depth	Packer set at
2 3/8"	5630'	---

ACID, FRACTURE, SHOT, CEMENT SQUEEZE RECORD

Amount and kind of material used	Depth interval treated
Acidized Chester Sd w/250 gals. 15% MSR-100 acid containing 1/2 gas W-39	5619' - 20'

INITIAL PRODUCTION

Date of first production	Producing method (flowing, pumping, gas lift, etc.)
2-7-80	Flowing
RATE OF PRODUCTION PER 24 HOURS	Oil 33 bbls. Gas 9.5 MCF Water 0 bbls. Gas-oil ratio 287 CFPB
Disposition of gas (vented, used on lease or sold)	Producing interval (s)
Vented	5619-20'

INSTRUCTIONS: As provided in KCC Rule 82-2-125, within 90 days after completion of a well, one completed copy of this Drillers Log shall be transmitted to the State Geological Survey of Kansas, 4150 Monroe Street, Wichita, Kansas 67209. Copies of this form are available from the Conservation Division, State Corporation Commission, 3830 So. Meridian (P.O. Box 17027), Wichita, Kansas 66217. Phone AC 316-522-2206. If confidential custody is desired, please note Rule 82-2-125. Drillers Logs will be on open file in the Oil and Gas Division, State Geological Survey of Kansas, Lawrence, Kansas 66044.

Operator

Cities Service Company

DESIGNATE TYPE OF COMP.: OIL, GAS,
DRY HOLE, SWDW, ETC.:

Well No. 1	Lease Name Cooper G	Oil
---------------	------------------------	-----

S 26 T32S R 33 ^E_W**WELL LOG**

Show all important zones of porosity and contents thereof; cored intervals, and all drill-stem tests, including depth interval tested, cushion used, time tool open, flowing and shut-in pressures, and recoveries.

SHOW GEOLOGICAL MARKERS, LOGS RUN,
OR OTHER DESCRIPTIVE INFORMATION.

FORMATION DESCRIPTION, CONTENTS, ETC.	TOP	BOTTOM	NAME	DEPTH
Sand & Red Bed	0	980	Ran Schlumberger Dual In-	
Glorietta	980	1185	duction SFL Compensated	
Sand & Shale	1185	1573	FD w/GR & Caliper	
Anhy,	1573	1583		
Red Bed	1583	1861	Ran CC & Cement Bond Log	
Sand & Shale	1861	2290	5738' PBTD to 4100'	
Lime & Shale	2290	3515	Found top of cement at 4350'	
Dolomite and Shale	3515	3990		
Lime & Shale	3990	5795		
TD		5795		
PBTD		5735		

USE ADDITIONAL SHEETS, IF NECESSARY, TO COMPLETE WELL RECORD.

Date Received

 Signature

H. E. Massey

Operations Manager

Title

March 17, 1980

Date

TYPE

AFFIDAVIT OF COMPLETION FORM

ACO-1 WELL HISTORY

SIDE ONE

Two (2) copies of this form shall be filed with the Kansas Corporation Commission, 200 Colorado Derby Building, Wichita, Kansas 67202, within thirty (30) days after the completion of a well, regardless of how the well was completed.

Attach separate letter of request if the information is to be held confidential. If confidential, only file one copy. Information on Side One will be of public record and Side Two will then be held confidential.

Applications must be made on dual completion, commingling, salt water disposal, injection and temporarily abandoned wells.

Attach one copy only wireline logs (i.e. electrical log, sonic log, gamma ray neutron log, etc.). (Rules 82-2-105 & 82-2-125) KCC# (316) 263-3238.

LICENSE # 5447 EXPIRATION DATE 6-30-83

OPERATOR Cities Service Company API NO. 15-175-20444

ADDRESS 3545 N.W. 58th St., Okla. City, OK 73112 COUNTY Seward

FIELD Lemert

** CONTACT PERSON Larry Ervin PROD. FORMATION Chester

PHONE 405-949-4400

PURCHASER Cities Service Company LEASE Cooper G

ADDRESS P.O. Box 300 WELL NO. 1

Tulsa, Oklahoma WELL LOCATION C NW SW NE

DRILLING Lohmann-Johnson 330 Ft. from West Line and

CONTRACTOR ADDRESS 3535 N.W. 58th, Suite 710 990 Ft. from South Line of

Oklahoma City, OK 73112 the NE (Qtr.) SEC 26 TWP 32S RGE 33W.

PLUGGING CONTRACTOR ADDRESS

State Geological Survey WICHITA BRANCH

WELL PLAT

(Office Use Only)

		X	
		26	

KCC
KGS
SWD/REP
PLG.

TOTAL DEPTH 5786' PBTD 5738'

SPUD DATE 1-8-80 DATE COMPLETED 3-6-80

ELEV: GR 2750' DF KB -2760'

DRILLED WITH (CABLE) (ROTARY) ~~(XXX)~~ TOOLS.

DOCKET NO. OF DISPOSAL OR REPRESSURING WELL BEING USED TO DISPOSE OF WATER FROM THIS LEASE

Amount of surface pipe set and cemented 1582' DV Tool Used? No

THIS AFFIDAVIT APPLIES TO: (Circle ONE) Oil, Gas, Shut-in Gas, Dry, Disposal, Injection, Temporarily Abandoned, OWWO. Other

ALL REQUIREMENTS OF THE STATUTES, RULES AND REGULATIONS PROMULGATED TO REGULATE THE OIL AND GAS INDUSTRY HAVE BEEN FULLY COMPLIED WITH.

A F F I D A V I T

Verlin Meier

, being of lawful age, hereby certifies that:

I am the Affiant, and I am familiar with the contents of the foregoing Affidavit. The statements and allegations contained therein are true and correct.

FILL IN WELL LOG AS REQUIRED:

Show all important zones of porosity and contents thereof; cored intervals, and all drill-stem tests, including depth interval tested, cushion used, time tool open, flowing and shut-in pressures, and recoveries.			SHOW GEOLOGICAL MARKERS LOGS RUN, OR OTHER DESCRIPTIVE INFORMATION.	
FORMATION DESCRIPTION, CONTENTS, ETC.	TOP	BOTTOM	NAME	DEPTH
SEE ORIGINAL WELL HISTORY			Schlumberger: SFL & Comp. FD caliper. CC &	Dual Induc. w/GR and CBL

ACID, FRACTURE, SHOT, CEMENT SQUEEZE RECORD

Amount and kind of material used	Depth interval treated
2-5-80 Acidized w/250 gals 15% MSR-100 Acid	5619-20
8-20-82 Acidized w/500 gals, 7-1/2% HCL-MSR 100 acid.	
9-23-82 Frac trtd w/11,000 gals, gelled acid mixed w/20/40 sd	5619-23

Date of first production 3-6-80	Producing method (flowing, pumping, gas lift, etc.) Pumping	Gravity 31.8°
* Test RATE OF PRODUCTION PER 24 HOURS 11-10-82	Oil 6 bbls. Gas 47.7 MCF Water % Gas-oil ratio 7950 CFPS	Disposition of gas (vented, used on lease or sold) TO BE SOLD
Perforations		5619-5623

--	--	--	--	--

Report of all strings set — surface, intermediate, production, etc. CASING RECORD (New) or (Used)

Purpose of string	Size hole drilled	Size casing set (in O.D.)	Weight lbs./ft.	Setting depth	Type cement	Sacks	Type and percent additives
Surface	12-1/4"	8-5/8"	24#	1582	65/35 Pozmix	700	6% Gel, 2% CaCl 1/2# D-29
					60/40 Pozmix	100	3% CaCl, 1/4# D-29
Production	7-7/8"	5-1/2"	14#	KB 5785'	35/65 light Pozmix	72	6% gel, 1/4# D-29 .8% D-65, 10% salt
					50/50 Poz	150	4% Gel, 1/4# D-29 .8% D-65 10% salt

LINER RECORD			PERFORATION RECORD		
Top, ft.	Bottom, ft.	Sacks cement	Shots per ft.	Shot-Strings	Depth interval
			4 DP Jet	Chester	5619-20 Orig. Perfs
TUBING RECORD			4 " "	"	5620-23 Perf. 8/P
Size 2-3/8"	Setting depth 5588	Factor set at			