

RELEASED
 APR 1 1988
 Date: APR 1 1988 RECEIVED AS OF 2-26-88

374108
11/20/88
 KCC

SIDE ONE

STATE CORPORATION COMMISSION OF KANSAS
 FROM CONFIDENTIAL
 OIL & GAS CONSERVATION DIVISION
 WELL COMPLETION OR RECOMPLETION FORM
 ACO-1 WELL HISTORY
 DESCRIPTION OF WELL AND LEASE

Operator: License # 5208
 Name Mobil Oil Corporation
 Address P.O. Box 5444
 City/State/Zip Denver, CO 80217

Purchaser THE PERMAN CORP.

Operator Contact Person D. H. LAWRENCE
 Phone 303-298-2698

Contractor: License # 5382
 Name CHEYENNE DRILLING INC.

Wellsite Geologist T. A. T. V. R. P. K.
 Phone (303) 298-3689

Designate Type of Completion
 New Well Re-Entry Workover
 Oil SWD Temp Abd
 Gas Inj Delayed Comp.
 Dry Other (Core, Water Supply etc.)

If ONWO: old well info as follows:
 Operator
 Well Name
 Comp. Date Old Total Depth.....

WELL HISTORY

Drilling Method:
 Mud Rotary Air Rotary Cable
8-16-87 8-24-87 9-10-87
 Spud Date Date Reached TD Completion Date
6246' 6208'
 Total Depth PBDT

Amount of Surface Pipe Set and Cemented at 1769 feet
 Multiple Stage Cementing Collar Used? Yes No
 If yes, show depth set.....feet
 If alternate 2 completion, cement circulated
 from.....feet depth to.....w/.....SX cmf
 Cement Company Name
 Invoice #

API NO. 15-189-21101
 County STEVENS
 Sec. 1 East
 Twp 32S Rge 35 West
3300 Ft North from Southeast Corner of Section
660 Ft West from Southeast Corner of Section
 (Note: Locate well in section plat below)

Lease Name K.U. ENDOWMENT Well # 1
 Field Name LARRABEE
 Producing Formation CHESTER
 Elevation: Ground 2961' KB 2972'

Section Plat

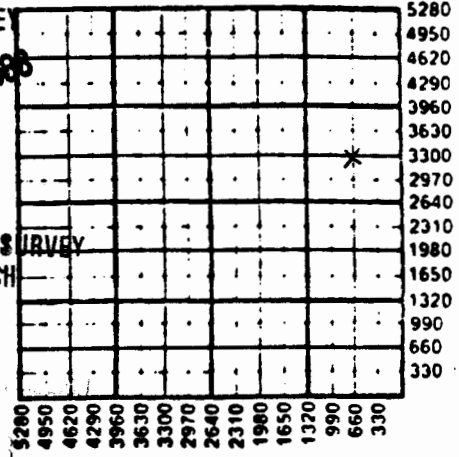

KANSAS GEOLOGICAL SURVEY
 WICHITA BRANCH
 MAR 08 1988
 APR 26 1988

Disposition of Produced Water: Disposal
 Docket # 82-82408 Repressuring
SOUTH CUTTER

Questions on this portion of the ACO-1 call:
 Water Resources Board (913) 296-3717
 Source of Water:
 Division of Water Resources Permit # T.87-324
 Groundwater 3300 Ft North from Southeast Corner
 (Well) 660 Ft West from Southeast Corner of
 Sec 1 Twp 32S Rge 35 East West
 Surface Water.....Ft North from Southeast Corner
 (Stream, pond etc).....Ft West from Southeast Corner
 Sec Twp Rge East West
 Other (explain) WATER WELL ON SITE
 (purchased from city, R.W.D. #)

INSTRUCTIONS: This form shall be completed in triplicate and filed with the Kansas Corporation Commission, 200 Colorado Derby Building, Wichita, Kansas 67202, within 120 days of the spud date of any well. Rule 82-3-130, 82-3-107 and 82-3-106 apply. Information on side two of this form will be held confidential for a period of 12 months if requested in writing and submitted with the form. See rule 82-3-107 for confidentiality in excess of 12 months. One copy of all wireline logs and drillers time log shall be attached with this form. Submit CP-4 form with all plugged wells. Submit CP-111 form with all temporarily abandoned wells.

All requirements of the statutes, rules and regulations promulgated to regulate the oil and gas industry have been fully complied with and the statements herein are complete and correct to the best of my knowledge.

Signature D. H. Lawrence D. H. Lawrence

Title General Accounting Supervisor Date 11-17-87

Subscribed and sworn to before me this 17th day of November
 1987
 Notary Public [Signature]
 Date Commission Expires November 17th 1988

K.C.C. OFFICE USE ONLY

Letter of Confidentiality Attached
 Wireline Log Received
 Drillers Time Log Received

Distribution

KCC SWD/Rep NGPA
 KGS Plug Other
 (Specify)

Sec 1 Twp 32S Rge 35E

SIDE TWO

Operator Name Mobil Oil Corp. Lease Name K.U. ENDOWMENT Well # 1

Sec. 1 Twp. 22S Rge. 25E East West County ST. JOHNS

WELL LOG

INSTRUCTIONS: Show important tops and base of formations penetrated. Detail all cores. Report all drill stem tests giving interval tested, time tool open and closed, flowing and shut-in pressures, whether shut-in pressure reached static level, hydrostatic pressures, bottom hole temperature, fluid recovery, and flow rates if gas to surface during test. Attach extra sheet if more space is needed. Attach copy of log.

Drill Stem Tests Taken Yes No
 Samples Sent to Geological Survey Yes No
 Cores Taken Yes No

Formation Description
 Log Sample

Name	Top	Bottom
CHASE	2592	
COUNCIL GROVE	2926	
ADMIRE	3190	
WABAUNSEE	3321	
HEEBNER	4131	
KANSING	4243	
KANSAS CITY	4525	
MARION	4936	
CHEROKEE	5141	
MORROW	5538	
CHESTER	5740	
STEGENEVIEVE	6100	
ST. LOUIS	6168	

CASING RECORD <input checked="" type="checkbox"/> New <input type="checkbox"/> Used							
Report all strings set-conductor, surface, intermediate, production, etc.							
Purpose of String	Size Hole Drilled	Size Casing Set (in O.D.)	Weight Lbs/Ft.	Setting Depth	Type of Cement	#Sacks Used	Type and Percent Additives
SURFACE	12-1/4"	8-5/8"	24.5	1769'	CLASS C	640	65.25% C, 34.75% S
					CLASS C	185	37.00% C, 63.00% S
PRODUCTION	7-7/8"	5-1/2"	14.5	6246'	CLASS A	260	27.6% C, 72.4% S
					CLASS A	420	31.6% C, 68.4% S
PERFORATION RECORD				Acid, Fracture, Shot, Cement Squeeze Record (Amount and Kind of Material Used)			
Shots Per Foot	Specify Footage of Each Interval Perforated					Depth	
4.36	6042'-6084'			50' 2" 200 BALL SIZES FLUENT		6042' - 6084' 0"	
				BALLS PER FT. 19.94			
				FEET PER FLUENT 2-10			
TUBING RECORD				Liner Run <input type="checkbox"/> Yes <input checked="" type="checkbox"/> No			
Size 2-7/8"		Set At 6112'		Packer at 6007'			
Date of First Production		Producing Method <input type="checkbox"/> Flowing <input checked="" type="checkbox"/> Pumping <input type="checkbox"/> Gas Lift <input type="checkbox"/> Other (explain)					
10-1-87							
Estimated Production Per 24 Hours		Oil	Gas	Water	Gas-Oil Ratio	Gravity	
64 Bbls		53 MCF	3 Bbls	828	CFPB		

METHOD OF COMPLETION Open Hole Perforation Other (Specify) 6042'-6084' O.A.

Disposition of gas: Vented Sold Used on Lease Open Hole Perforation Other (Specify) Dually Completed Conmingled