

APR 1 1989
RELEASED
 STATE CORPORATION COMMISSION OF KANSAS
 OIL & GAS CONSERVATION DIVISION
 FROM CONFIDENTIAL
 WELL COMPLETION OR RECOMPLETION FORM
 ACO-1 WELL HISTORY
 DESCRIPTION OF WELL AND LEASE

SIDE ONE

3/24/89
 KCC

API NO. 15-129-21143
 County... STEVENS
 .. C. N 1/2 NE Sec. 1.. Twp 32S Rge. 35 East
 .. X West
 .. 4670 Ft North from Southeast Corner of Section
 .. 1320 Ft West from Southeast Corner of Section
 (Note: Locate well in section plat below)
 Lease Name... K.U. ENDOWMENT Well #... 3
 Field Name... LARRABEE
 Producing Formation... CHESTER
 Elevation: Ground... 2967' KB... 2983'

Operator: License # 5208
 Name Mobil Oil Corporation
 Address P.O. Box 5444
 City/State/Zip Denver, CO 80217

Purchaser...
INFO NOT AVAILABLE AT THIS TIME

Operator Contact Person... D. H. Lawrence
 Phone... 303-298-2698

Contractor: License # 9137
 Name... UNIT. DRILL. & EXPL. CO.

Wellsite Geologist... V. PHILLIPS
 Phone... 303-298-3653

Designate Type of Completion
 New Well Re-Entry Workover
 OH SWD Temp Abu
 Gas Inj Delayed Comp.
 Dry Other (Core, Water Supply etc.)

If ONWO: old well info as follows:
 Operator
 Well Name
 Comp. Date
 Old Total Depth

WELL HISTORY

Drilling Method:
 Mud Rotary Air Rotary Cable
2-3-88 2-9-88 3-2-88
 Spud Date Date Reached TD Completion Date
6210' 6163'
 Total Depth PBDT

Amount of Surface Pipe Set and Cemented at 1803 feet
 Multiple Stage Cementing Collar Used? Yes No
 If yes, show depth set... 3264 feet
 If alternate 2 completion, cement circulated
 from... feet depth to... w/... SX cmt
 Cement Company Name
 Invoice #

KANSAS GEOLOGICAL SURVEY
 WICHITA BRANCH

MAR 2 1989

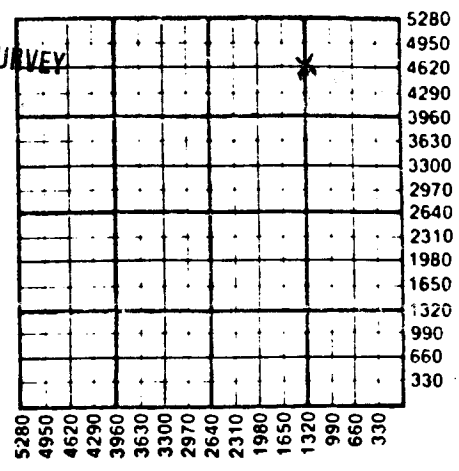

WATER SUPPLY INFORMATION

Disposition of Produced Water: Disposal
 Docket # Repressuring
INFO NOT AVAILABLE AT THIS TIME

Questions on this portion of the ACO-1 call:
 Water Resources Board (913) 296-3717
 Source of Water:
 Division of Water Resources Permit # T. 88-52

Groundwater 3135 Ft North from Southeast Corner
 (Well) .. 625 Ft West from Southeast Corner of
 Sec 1 Twp 32S Rge 35 East West
 Surface Water..... Ft North from Southeast Corner
 (Stream, pond etc)..... Ft West from Southeast Corner
 Sec Twp Rge East West
 Other (explain)
 (purchased from city, R.W.D. #)

INSTRUCTIONS: This form shall be completed in triplicate and filed with the Kansas Corporation Commission, 200 Colorado Derby Building, Wichita, Kansas 67202, within 120 days of the spud date of any well. Rule 82-3-130, 82-3-107 and 82-3-106 apply.
 Information on side two of this form will be held confidential for a period of 12 months if requested in writing and submitted with the form. See rule 82-3-107 for confidentiality in excess of 12 months.
 One copy of all wireline logs and drillers time log shall be attached with this form. Submit CP-4 form with all plugged wells. Submit CP-111 form with all temporarily abandoned wells.

All requirements of the statutes, rules and regulations promulgated to regulate the oil and gas industry have been fully complied with and the statements herein are complete and correct to the best of my knowledge.

Signature D. H. Lawrence D. H. Lawrence
 Title... General Accounting Supervisor Date 3-21-88

Subscribed and sworn to before me this 21st day of March
 1988
 Notary Public [Signature]
 Date Commission Expires 10th 1988

K.C.C. OFFICE USE ONLY

Letter of Confidentiality Attached
 Wireline Log Received
 Drillers Timelog Received

Distribution

KCC SWD/Rep NGPA
 KGS Plug Other
 (Specify)

RECEIVED
 STATE CORPORATION COMMISSION
 WICHITA BRANCH
 MAR 24 1988

Form ACO-1 (5-86)

MAR 29 1988

CONSERVATION DIVISION
 Wichita, Kansas

Sec 1, Twp 32 Rge 35 E

SIDE TWO

Operator Name MOBIL OIL CORP. Lease Name K.V. ENDRUMENT Well # 3

Sec. 1 Twp. 32S Rge. 35 East West County STEVENS

WELL LOG

INSTRUCTIONS: Show important tops and base of formations penetrated. Detail all cores. Report all drill stem tests giving interval tested, time tool open and closed, flowing and shut-in pressures, whether shut-in pressure reached static level, hydrostatic pressures, bottom hole temperature, fluid recovery, and flow rates if gas to surface during test. Attach extra sheet if more space is needed. Attach copy of log.

Drill Stem Tests Taken Yes No
 Samples Sent to Geological Survey Yes No
 Cores Taken Yes No

Formation Description
 Log Sample

Name	Top	Bottom
CHASE	2603	
WINFIELD	2710	
COUNCIL GROVE	2936	
ADMIRE	3199	
WABAUNSEE	3326	
HEEBNER	4134	
LANSING	4247	
KANSAS CITY	4526	
MARMATON	4941	
CHEROKEE	5140	
MORROW	5520	
CHESTER	5722	
STE. GENEVIEVE	6083	
ST. LOUIS	6152	

CASING RECORD <input checked="" type="checkbox"/> New <input type="checkbox"/> Used							
Report all strings set-conductor, surface, intermediate, production, etc.							
Purpose of String	Size Hole Drilled	Size Casing Set (in O.D.)	Weight Lbs/Ft.	Setting Depth	Type of Cement	#Sacks Used	Type and Percent Additives
SURFACE	12-1/4"	8-5/8"	24#	1803'	CLC LITE	585	45:35:6 + 3% CAC 2
PRODUCTION	7-7/8"	5-1/2"	14#	6210'	CLC CLH	175 240	2% CAC 2 50:50 H:Po 2 + 2% GEL
					CLH	430	50:50 + 2% GEL + 2% CAC 2
PERFORATION RECORD				Acid, Fracture, Shot, Cement Squeeze Record			
Shots Per Foot	Specify Footage of Each Interval Perforated			(Amount and Kind of Material Used)		Depth	
4 SPF	6037'-6084'			ACIDIZ'D. W/ 2 M. GALS. 7.5% IRON		6037'-	
4 SPF	6059'-6082'			CONTROL ACID; FLUSH'D. W/ 38 BALS		6082' GA	
				DIESEL FRAC'D. W/ 24,600 GALS 60R PA			
				FOAM. W/ 88,200# 20-40 SAND			
TUBING RECORD				Liner Run <input type="checkbox"/> Yes <input type="checkbox"/> No			
INFO NOT AVAILABLE AT THIS TIME							
Date of First Production	Producing Method						
INFO NOT AVAILABLE	<input type="checkbox"/> Flowing <input type="checkbox"/> Pumping <input type="checkbox"/> Gas Lift <input type="checkbox"/> Other (explain).....						
AT THIS TIME -	Oil	Gas	Water	Gas-Oil Ratio	Gravity		
Estimated Production Per 24 Hours	Bbls	MCF	Bbls	CFPB			

METHOD OF COMPLETION

Production Interval

Disposition of gas: Vented Open Hole Perforation
 Sold Other (Specify)
 Used on Lease Dually Completed Commingled

6037'-6082' 0.1
