

15-077-20397

State Geological Survey  
**WICHITA, BRANCH**  
**KANSAS DRILLERS LOG**

API No. 15 — 077 — 20,397  
 County Number

S. 2 T. 32S R. 6W <sup>E</sup>/<sub>W</sub>  
 Loc. NW NW SE  
 County Harper

Operator  
National Oil Company

Address  
200 W. Douglas, Suite 550, Wichita, KS 67202

Well No. 1 Lease Name Francis

Footage Location  
2310 feet from ~~XX~~ (S) line 2310 feet from (E) ~~XX~~ line

Principal Contractor Graves Drilling Co., Inc. Geologist Bob Gebhart

Spud Date February 21, 1977 Total Depth 4700 P.B.T.D.

Date Completed March 3, 1977 Oil Purchaser

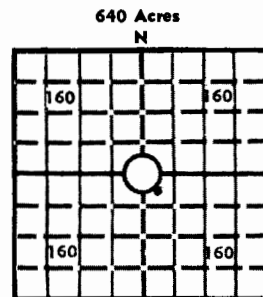

Locate well correctly  
 Elev.: Gr. 1370  
 DF 1378 KB 1380

**CASING RECORD**

Report of all strings set — surface, intermediate, production, etc.

Purpose of string	Size hole drilled	Size casing set (in O.D.)	Weight lbs/ft.	Setting depth	Type cement	Sacks	Type and percent additives
Surface	12¼	8-5/8	28	209		200	2% gel, 3% cc

**LINER RECORD**

**PERFORATION RECORD**

Top, ft.	Bottom, ft.	Sacks cement	Shots per ft.	Size & type	Depth interval

**TUBING RECORD**

Size	Setting depth	Packer set at

**ACID, FRACTURE, SHOT, CEMENT SQUEEZE RECORD**

Amount and kind of material used	Depth interval treated

**INITIAL PRODUCTION**

Date of first production		Producing method (flowing, pumping, gas lift, etc.)			
RATE OF PRODUCTION PER 24 HOURS	Oil bbls.	Gas MCF	Water bbls.	Gas-oil ratio	CFPB
Disposition of gas (vented, used on lease or sold)			Producing interval (s)		

INSTRUCTIONS: As provided in KCC Rule 82-2-125, within 90 days after completion of a well, one completed copy of this Drillers Log shall be transmitted to the State Geological Survey of Kansas, 4150 Monroe Street, Wichita, Kansas 67209. Copies of this form are available from the Conservation Division, State Corporation Commission, 3830 So. Meridian (P.O. Box 17027), Wichita, Kansas 66217. Phone AC 316-522-2206. If confidential custody is desired, please note Rule 82-2-125. Drillers Logs will be on open file in the Oil and Gas Division, State Geological Survey of Kansas, Lawrence, Kansas 66044.

Operator

DESIGNATE TYPE OF COMP.: OIL, GAS, DRY HOLE, SWDW, ETC.:

Dry Hole

National Oil Company

Well No. 1

Lease Name Francis

S 2 T 32 R 6 W E W

NW NW SE

**WELL LOG**

Show all important zones of porosity and contents thereof; cored intervals, and all drill-stem tests, including depth interval tested, cushion used, time tool open, flowing and shut-in pressures, and recoveries.

SHOW GEOLOGICAL MARKERS, LOGS RUN, OR OTHER DESCRIPTIVE INFORMATION.

FORMATION DESCRIPTION, CONTENTS, ETC.	TOP	BOTTOM	NAME	DEPTH
<u>Log Tops</u>				
DST #1, 4280-90'; 30-45-60-45; Str blow; GTS in 123"; Rec 120' G&OCM, 30' G&OCW; IFP 20-60; ISIP 1525; FFP 60-120; FSIP 1485.			Indian Cave	2190 -810
			Topeka	2716 -1336
DST #2, 4675-83'; 30-45-60-60; Fr blow inc to str; Rec 40' MW, 1770' wtr; IFP 120-454; FFP 435-860; ISIP 1714; FSIP 1714.			Heebner	3093 -1713
			Iatan	3350 -1970
			Stalnaker Sd	3413 -2033
			Kansas City	3669 -2289
			Black Shale	3803 -2423
			B/Ks City	3902 -2522
			Marmaton	3973 -2593
			Cherokee	4096 -2716
			Reworked Mis	4265 -2885
			Mississippi	4279 -2899
		Kinderhook	4566 -3186	
		Simpson Sd	4679 -3299	

USE ADDITIONAL SHEETS, IF NECESSARY, TO COMPLETE WELL RECORD

Date Received

*[Handwritten Signature]*

Signature

Geologist

Title

March 24, 1977

Date

State Geological Survey  
WICHITA, BRANCH

ROTARY DRILLERS' LOG

15-077-2039T

2-32-6W

OPERATOR: National Oil Company DRILLING COMMENCED: 21 Feb. 1977  
200 West Douglas  
Suite 550  
Wichita, Kansas 67202

CONTRACTOR: Graves Drilling Co., Inc. DRILLING COMPLETED: 3 Mar. 1977  
910 Union Center  
Wichita, Kansas 67202

CASING RECORD: 5 Jts. 209' of used 8-5/8" LOCATION: Francis No. 1  
cemented with 200 sacks NW NW SE  
Section 2-32S-6W  
Harper County, Kansas

-----

0 - 209	Sand & red bed
209 - 1174	Red bed & shale
1174 - 3303	Shale & lime
3303 - 3425	Shale & sand
3425 - 3515	Sand
3515 - 3619	Lime & shale
3619 - 3734	Shale, lime & chalklime
3734 - 3947	Lime & shale
3947 - 4125	Shale & lime
4125 - 4195	Lime & shale
4195 - 4270	Shale & lime
4270 - 4312	Lime & shale
4312 - 4670	Lime
4670 - 4683	Lime & shale
4683 - 4700	Lime

4700 Rotary Total Depth

I hereby certify the foregoing statements to be true and correct to the best of my knowledge.

GRAVES DRILLING CO., INC.