

Ind 21

KANSAS DRILLERS LOG

API No. 15 — 077 — 20,546
County Number

S. 24 T. 32S R. 7W E W
 C SW SE

County Harper

Operator Sanders Oil Company
 Address 910 Sutton Place, Wichita, Kansas
 Well No. #1 Lease Name Coulson
 Footage Location 660 feet from (N) (S) line 1980 feet from (E) (W) line
 Principal Contractor Brandt Drilling Co., Inc. Geologist Charles R. King
 Spud Date 10/24/79 Total Depth 4925 P.B.T.D.
 Date Completed 11/8/79 Oil Purchaser

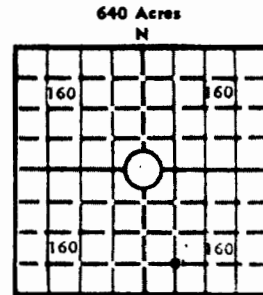

Locate well correctly
 Elev.: Gr. 1446
1448 1450
 DF. KB

CASING RECORD

State Geological Survey
WICHITA BRANCH

Report of oil strings set — surface, intermediate, production, etc.

Purpose of string	Size hole drilled	Size casing set (in O.D.)	Weight lbs/ft.	Setting depth	Type cement	Socks	Type and percent additives
Surface	12 1/2"	8 5/8"	20#	246	Common	200	2% gel; 3% cc
Production	7 7/8"	4 1/2"	9.5#	4575	60/40 posmix latex	110 40	

LINER RECORD

PERFORATION RECORD

Top, ft.	Bottom, ft.	Socks cement	Shots per ft.	Size & type	Depth interval
				4 sand cuts	@ 4485, 4487, 4490 & 4492

TUBING RECORD

Size	Setting depth	Packers set at

ACID, FRACTURE, SHOT, CEMENT SQUEEZE RECORD

Amount and kind of material used	Depth interval treated
1,000 gallons 15% demud acid, 10,000# 20/40 frac sand	4485-4492

INITIAL PRODUCTION

Date of first production _____ Producing method (flowing, pumping, gas lift, etc.) _____

RATE OF PRODUCTION PER 24 HOURS	Oil	Gas	Water	Gas-oil ratio
	bbls.	MCF	bbls.	CFPB
Disposition of gas (vented, used on lease or sold)			Producing interval (s)	

INSTRUCTIONS: As provided in KCC Rule 82-2-125, within 90 days after completion of a well, one completed copy of this Drillers Log shall be transmitted to the State Geological Survey of Kansas, 4150 Monroe Street, Wichita, Kansas 67209. Copies of this form are available from the Conservation Division, State Corporation Commission, 3830 So. Meridian (P.O. Box 17027), Wichita, Kansas 66217. Phone AC 316-522-2206. If confidential custody is desired, please note Rule 82-2-125. Drillers Logs will be on open file in the Oil and Gas Division, State Geological Survey of Kansas, Lawrence, Kansas 66044.

Operator Sanders Oil Company

DESIGNATE TYPE OF COMP.: OIL, GAS, DRY HOLE, SWDW, ETC.:

Well No.

#1

Lease Name

Coulson

icky dry

S 24 T 32S R 7W E C SW SE Harper County, Kansas

WELL LOG

Show all important zones of porosity and contents thereof; cored intervals, and all drill-stem tests, including depth interval tested, cushion used, time tool open, flowing and shut-in pressures, and recoveries.

SHOW GEOLOGICAL MARKERS, LOGS RUN, OR OTHER DESCRIPTIVE INFORMATION.

FORMATION DESCRIPTION, CONTENTS, ETC.	TOP	BOTTOM	NAME	DEPTH
Soil, sand & shale	0	350		
Redbeds & shale	350	776		
Lime & shale	776	1578		
Lime & cherty lime	1578	1675		
Lime & shale	1675	2500		
Lime	2500	2710		
Shale	2710	2760		
Lime	2760	3030		
Shale	3030	3038		
Lime	3038	3250		
Sand & shaley sand	3250	3600		
Lime, xln	3600	3850		
Lime & cherty lime	3850	4060		
Shale w/lime stks.	4060	4220		
Lime & cherty lime	4220	4650		
Shale	4650	4670		
Dolomite, porous	4670	4710		
Sand	4710	4750		
Shale	4750	4895		
Lime	4895	4925		
RTD	4925			

RECEIVED
STATE CORPORATION COMMISSION
SEP 20 1980
CONSERVATION DIVISION
Wichita, Kansas

USE ADDITIONAL SHEETS, IF NECESSARY, TO COMPLETE WELL RECORD.

Date Received

Signature

General Manager

Title

5-20-80

Date