

**KANSAS DRILLERS LOG**

*State Geological Survey*  
**WICHITA BRANCH**  
 RECEIVED STATE CORPORATION COMMISSION  
 APR 10 1981

S. 9 T. 32S R. 8W E  
 C NE SW  
 Loc. \_\_\_\_\_  
 County Harper

API No. 15 — 077 — 20499  
 County Number  
 Operator Raymond Oil Co.  
 Address 200 W. Douglas - Wichita, Ks. 67202  
 Well No. # 1 Lease Name Hoyt  
 Footage Location 660 feet from (N) NE line 1980 feet from (E) (W) line  
 Principal Contractor DaMac Drilling, Inc. Geologist Richard E. Rowland  
 Spud Date 11-24-78 Total Depth 3660 RTD P.B.T.D. \_\_\_\_\_  
 Date Completed 12-1-78 Oil Purchaser \_\_\_\_\_

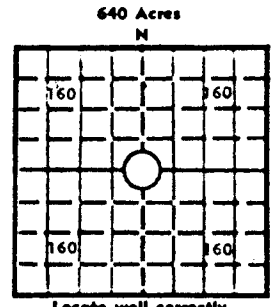

Locate well correctly  
 Elev.: Gr. 1436'  
 DF \_\_\_\_\_ KB 1444'

**CASING RECORD**

Report of all strings set — surface, intermediate, production, etc.

Purpose of string	Size hole drilled	Size casing set (in O.D.)	Weight lbs./ft.	Setting depth	Type cement	Secks	Type and percent additives
Surface		8-5/8"		263'		200	

**LINER RECORD**

**PERFORATION RECORD**

Top, ft.	Bottom, ft.	Secks cement	Shots per ft.	Size & type	Depth interval

Size	Setting depth	Pecker set at

**ACID, FRACTURE, SHOT, CEMENT SQUEEZE RECORD**

Amount and kind of material used	Depth interval treated

**INITIAL PRODUCTION**

Date of first production \_\_\_\_\_ Producing method (flowing, pumping, gas lift, etc.) \_\_\_\_\_

RATE OF PRODUCTION PER 24 HOURS	Oil	Gas	Water	Gas-oil ratio
	bbls.	MCF	bbls.	CFPB

Disposition of gas (vented, used on lease or sold) \_\_\_\_\_ Producing interval (s) \_\_\_\_\_

INSTRUCTIONS: As provided in KCC Rule 82-2-125, within 90 days after completion of a well, one completed copy of this Drillers Log shall be transmitted to the State Geological Survey of Kansas, 4150 Monroe Street, Wichita, Kansas 67209. Copies of this form are available from the Conservation Division, State Corporation Commission, 3830 So. Meridian (P.O. Box 17027), Wichita, Kansas 66217. Phone AC 316-522-2206. If confidential custody is desired, please note Rule 82-2-125. Drillers Logs will be on open file in the Oil and Gas Division, State Geological Survey of Kansas, Lawrence, Kansas 66044.

Operator  
**Raymond Oil Company, Inc.**

DESIGNATE TYPE OF COMP.: OIL, GAS, DRY HOLE, SWDW, ETC.:

Well No. **1** Lease Name **Hoyt** Dry Hole *21*

s9 T32S R8 *W*

**WELL LOG**

Show all important zones of porosity and contents thereof; cored intervals, and all drill-stem tests, including depth interval tested, cushion used, time tool open, flowing and shut-in pressures, and recoveries.

SHOW GEOLOGICAL MARKERS, LOGS RUN, OR OTHER DESCRIPTIVE INFORMATION.

FORMATION DESCRIPTION, CONTENTS, ETC.	TOP	BOTTOM	NAME	DEPTH
DST #1 60-30-60-30 Rec. 1320' SW 1st FP 115-521 2nd FP 531-727 ISIP 1016 FSIP 1016  DST #2 60-30-60-30 Rec. 540' SW 1st FP 21-115 2nd FP 125-250 ISIP 1471 FSIP 1450  D&A Plugged 12-1-78	2354	2397	<u>LOG TOPS</u>	
			Cottonwood	2064
			Admire	2354
			Ind. Cave	2377
			Wabaunsee	2402
			Stotler	2503
			Tarkio	2596
			Topeka	3046
			Heebner	3286
			Iatan	3556
Stalnaker	3604			
LTD	3658			
RTD	3660			

USE ADDITIONAL SHEETS, IF NECESSARY, TO COMPLETE WELL RECORD.

Date Received	<b>RAYMOND OIL COMPANY, INC.</b>  Wm. M. Raymond <small>Signature</small>
	<b>President</b> <small>Title</small>
	<b>3-6-79</b> <small>Date</small>