

State Geological Survey

WICHITA, BRANCH

KANSAS DRILLERS LOG

S. 23 T. 32 R. 8 ^{NE}/_W

API No. 15 — 077 — 20,273
County Number

Loc. NW SW SE

County Harper

Operator
Lario Oil & Gas Co.

Address 301 South Market Wichita, Kansas 67202

Well No. #1-A Lease Name Wilson

Footage Location
990 feet from ~~755~~ (S) line 2310 feet from (E) ~~2000~~ line

Principal Contractor Sweetman Drilling, Inc. Geologist Edward B. Donnelly

Spud Date 7-12-74 Total Depth 4510' P.B.T.D.

Date Completed 7-21-74 Oil Purchaser

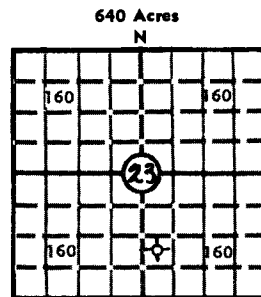

Elev.: Gr. 1405'

DF 1411' KB 1415'

CASING RECORD

Report of all strings set — surface, intermediate, production, etc.

Purpose of string	Size hole drilled	Size casing set (in O.D.)	Weight lbs/ft.	Setting depth	Type cement	Sacks	Type and percent additives
Surface	11"	8 5/8"	24#	238	Common	200	3% CaCl ₂

LINER RECORD

PERFORATION RECORD

Top, ft.	Bottom, ft.	Sacks cement	Shots per ft.	Size & type	Depth interval

TUBING RECORD

Size	Setting depth	Packer set at

ACID, FRACTURE, SHOT, CEMENT SQUEEZE RECORD

Amount and kind of material used	Depth interval treated

INITIAL PRODUCTION

Date of first production		Producing method (flowing, pumping, gas lift, etc.)			
RATE OF PRODUCTION PER 24 HOURS	Oil	Gas	Water	Gas-oil ratio	
	bbls.	MCF	bbls.	CFPB	
Disposition of gas (vented, used on lease or sold)			Producing interval (s)		

INSTRUCTIONS: As provided in KCC Rule 82-2-125, within 90 days after completion of a well, one completed copy of this Drillers Log shall be transmitted to the State Geological Survey of Kansas, 4150 Monroe Street, Wichita, Kansas 67209. Copies of this form are available from the Conservation Division, State Corporation Commission, 3830 So. Meridian (P.O. Box 17027), Wichita, Kansas 66217. Phone AC 316-522-2206. If confidential custody is desired, please note Rule 82-2-125. Drillers Logs will be on open file in the Oil and Gas Division, State Geological Survey of Kansas, Lawrence, Kansas 66044.

Operator Lario Oil & Gas Company		DESIGNATE TYPE OF COMP.: OIL, GAS, DRY HOLE, SWDW, ETC.:
Well No. 1-A	Lease Name Wilson	Dry Hole
S 23 T 32 R 8 ^{EX} W		

WELL LOG

Show all important zones of porosity and contents thereof; cored intervals, and all drill-stem tests, including depth interval tested, cushion used, time tool open, flowing and shut-in pressures, and recoveries.

SHOW GEOLOGICAL MARKERS, LOGS RUN, OR OTHER DESCRIPTIVE INFORMATION.

FORMATION DESCRIPTION, CONTENTS, ETC.	TOP	BOTTOM	NAME	DEPTH
Surface	0	245	DST #1	4441-50'
Red bed and shale	245	725	Open 30 min.	Weak blow
Shale	725	1245	for 15 min. and died.	
Lime & shale	1245	3903	Rec. 10' drilling mud.	
Lime	3903	4450		
Mississippi	4450	4510	DST #2	4448-62'
			Open 60 min,	show of oil and gas cut mud.
			Geological Tops:	
			Heebner	3341 (-1926)
			Iatan	3633 (-2218)
			Stalnaker	3652' (-2237)
			Kansas City	3901 (-2486')
			Cherokee	4293 (-2878')
			Mississippi	4436 (-3021')

USE ADDITIONAL SHEETS, IF NECESSARY, TO COMPLETE WELL RECORD.

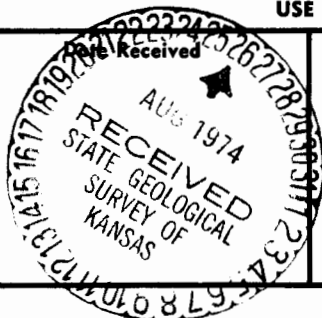

M. E. Kay
Signature

Div. Prod. Supt.
Title

7-24-74
Date