

15-077-20413

Computer Inventoried

State Geological Survey

WICHITA BRANCH  
KANSAS DRILLERS LOG

S. 29 T. 32S R. 8 **W**  
Loc. 660' FNL & 810' FEL  
County Harper

API No. 15 — 077 — 20,413  
County Number

Operator  
Texas Oil & Gas Corp.

Address  
200 West Douglas, Suite 300, Wichita, Kansas 67202

Well No. 1 Lease Name Findley

Footage Location  
660 feet from (N) (S) line 810 feet from (E) (W) line

Principal Contractor Xplor Drilling Company Geologist High Plains Consulting Ltd.

Spud Date 5-11-77 Total Depth 3830' P.B.T.D. 3777'

Date Completed 6-20-77 Oil Purchaser N/A

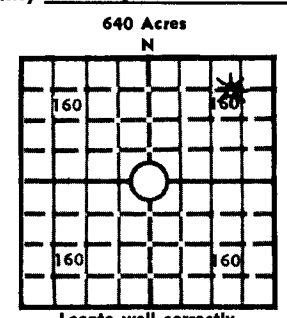

Elev.: Gr. 1436'  
DF 1441' KB 1444'

CASING RECORD

Report of all strings set — surface, intermediate, production, etc.

| Purpose of string | Size hole drilled | Size casing set (in O.D.) | Weight lbs/ft. | Setting depth | Type cement  | Sacks | Type and percent additives |
|-------------------|-------------------|---------------------------|----------------|---------------|--------------|-------|----------------------------|
| Surface           | 12 1/4"           | 8 5/8"                    | 24#            | 259'          | Common       | 250   | 2% Gel, 3% CaCl            |
| Production        | 7 7/8"            | 4 1/2"                    | 10.5#          | 3822'         | 50/50 Pozmix | 200   | 18% NaCl, 2% Gel           |
|                   |                   |                           |                |               |              |       |                            |
|                   |                   |                           |                |               |              |       |                            |

LINER RECORD

PERFORATION RECORD

| Top, ft.      | Bottom, ft.   | Sacks cement  | Shots per ft. | Size & type | Depth interval |
|---------------|---------------|---------------|---------------|-------------|----------------|
| N/A           | N/A           | N/A           |               |             |                |
| TUBING RECORD |               |               | 4 JSPF        | Deep Penet. | 3700-04'       |
| Size          | Setting depth | Packer set at | 4 JSPF        | Deep Penet. | 3689-91'       |
| 1 1/4"        | 3672'         | N/A           |               |             |                |

ACID, FRACTURE, SHOT, CEMENT SQUEEZE RECORD

| Amount and kind of material used      | Depth interval treated |
|---------------------------------------|------------------------|
| Acidized w/1,750 gallons Acetic Acid. | 3700-04'; 3689-91'     |
|                                       |                        |
|                                       |                        |

INITIAL PRODUCTION

|   |            |  |   |                      |      |
|---|------------|--|---|----------------------|------|
| Date of first production<br>Shut-in                           |            | Producing method (flowing, pumping, gas lift, etc.)<br>Flowing |   |                      |      |
| RATE OF PRODUCTION PER 24 HOURS                               | Oil<br>N/A | Gas<br>370 bbls.   | Water<br>1/2 MCF                            | Gas-oil ratio<br>N/A | CFPB |
| Disposition of gas (vented, used on lease or sold)<br>Shut-in |            |  | Producing interval(s)<br>3700-04'; 3689-91' |                      |      |

INSTRUCTIONS: As provided in KCC Rule 82-2-125, within 90 days after completion of a well, one completed copy of this Drillers Log shall be transmitted to the State Geological Survey of Kansas, 4150 Monroe Street, Wichita, Kansas 67209. Copies of this form are available from the Conservation Division, State Corporation Commission, 3830 So. Meridian (P.O. Box 17027), Wichita, Kansas 66217. Phone AC 316-522-2206. If confidential custody is desired, please note Rule 82-2-125. Drillers Logs will be on open file in the Oil and Gas Division, State Geological Survey of Kansas, Lawrence, Kansas 66044.

Operator  
Texas Oil & Gas Corp.

DESIGNATE TYPE OF COMP.: OIL, GAS,  
DRY HOLE, SWDW, ETC.:

Well No. 1 Lease Name Findley Gas Well

S 29 T 32S R 8 E W

**WELL LOG**

Show all important zones of porosity and contents thereof; cored intervals, and all drill-stem tests, including depth interval tested, cushion used, time tool open, flowing and shut-in pressures, and recoveries.

SHOW GEOLOGICAL MARKERS, LOGS RUN,  
OR OTHER DESCRIPTIVE INFORMATION.

| FORMATION DESCRIPTION, CONTENTS, ETC.                         | TOP  | BOTTOM | NAME | DEPTH |
|---|------|--------|------|-------|
| Herrington  | 1564 | -120   |      |       |
| Winfield  | 1625 | -181   |      |       |
| Towanda   | 1700 | -256   |      |       |
| Fort Riley  | 1752 | -308   |      |       |
| Florence  | 1795 | -351   |      |       |
| Wreford   | 1920 | -476   |      |       |
| Bader   | 2084 | -640   |      |       |
| Cottonwood  | 2115 | -671   |      |       |
| Red Eagle   | 2236 | -792   |      |       |
| Indian Cave   | 2379 | -935   |      |       |
| Wabaunsee   | 2450 | -1006  |      |       |
| Stotler   | 2627 | -1138  |      |       |
| Tarkio  | 2758 | -1314  |      |       |
| Emporia   | 2814 | -1370  |      |       |
| Howard  | 3061 | -1617  |      |       |
| Topeka  | 3207 | -1763  |      |       |
| Heebner   | 3367 | -1923  |      |       |
| Toronto   | 3381 | -1937  |      |       |
| T/Douglas Group   | 3402 | -1958  |      |       |
| Douglas Sand  | 3421 | -1977  |      |       |
| Iatan   | 3652 | -2208  |      |       |
| Stalnaker   | 3701 | -2257  |      |       |
| TD  | 3830 | -2386  |      |       |
| PBTD  | 3777 | -2333  |      |       |
| DST #1, 2381-2440', (Indian Cave) w/results as follows:       |      |        |      |       |
| IFP/30": 245-909#, strong blow thru-out                       |      |        |      |       |
| ISIP/60": 1045#   |      |        |      |       |
| FFP/45": 920-1045#, strong blow thru-out                      |      |        |      |       |
| FSIP/90": 1066#   |      |        |      |       |
| Rec 2140' SW.   |      |        |      |       |
| DST #2, 2821-43', (Emporia) w/results as follows:             |      |        |      |       |
| IFP/40": 127-437#, GTS 35", TSTM                              |      |        |      |       |
| ISIP/80": 1202#   |      |        |      |       |
| FFP/45": 427-617#, 19.5 MCFD                                  |      |        |      |       |
| FSIP/90": 1202#   |      |        |      |       |
| Rec 1302' GCSW.   |      |        |      |       |
| SEE ATTACHMENT.   |      |        |      |       |
| USE ADDITIONAL SHEETS, IF NECESSARY, TO COMPLETE WELL RECORD. |      |        |      |       |

Date Received

  
 Harold A. Brown  
 District Geologist  
 June 22, 1977

DST #3, 3405-50', (Douglas Sand) w/results as follows:

IFP/30": 52-213#, GTS 6", 337 MCFD increasing to 895 MCFD

ISIP/60": 1464#

FFP/45": 256-256#, gauged 1174 MCFD

FSIP/90": 1464#

Rec 30' MW + 180' SW.

DST #4, 3704-30', (Stalnaker) w/results as follows:

IFP/30": 223-794#, GTS 3", 31.9 MCFD decreasing to 11.4 MCFD

ISIP/60": 1506#

FFP/40": 794-1056#, 13.6 MCFD increasing to 19.5 MCFD, SWTS 32"

FSIP/60": 1516#

Rec 2510' SW.