

WICHITA BRANCH
KANSAS DRILLERS LOG

API No. 15 — 077 — 20,449
County Number

S. 30 T. 32S R. 8W
Loc. 1320' FSL & 1320' FWL
County Harper

Operator
Texas Oil & Gas Corp.

Address
200 W. Douglas, Suite 300

Well No. 1 Lease Name Antrim

Footage Location
1320 feet from (N) (S) line 1320 feet from (E) (W) line

Principal Contractor H-30 Drlg. Co. Geologist High Plains Consulting, Ltd.

Spud Date 9-10-77 Total Depth 4851' P.B.T.D. 3694'

Date Completed 4-17-78 Oil Purchaser N/A

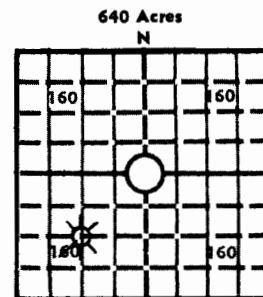

Locate well correctly
Elev.: Gr. 1442'
DF 1447' KB 1450'

CASING RECORD

Report of all strings set — surface, intermediate, production, etc.

Purpose of string	Size hole drilled	Size casing set (in O.D.)	Weight lbs/ft.	Setting depth	Type cement	Sacks	Type and percent additives
Surface	12 1/4"	8-5/8"	24#	290'	Common	150	2% Gel, 3% CaCl
Production		4 1/2"		4552'	"	400	"

LINER RECORD

PERFORATION RECORD

Top, ft.	Bottom, ft.	Sacks cement	Shots per ft.	Size & type	Depth interval
N/A	N/A	N/A	8	Deep Penet.	4413-18'
TUBING RECORD			4	Deep Penet.	4446-50'
			4	Deep Penet.	3960-63'
Size	Setting depth	Packer set at	4	Deep Penet.	3698-3702'
N/A	N/A	N/A	4	Deep Penet.	3676-80'

ACID, FRACTURE, SHOT, CEMENT SQUEEZE RECORD

Amount and kind of material used	Depth interval treated
6750 gal. acid; 100 sx cmt; 13,250 gal. wtr; 14,500# sand;	4413-18' 4446-50'
150# BAF	3960-63' 3698-3702'
	3676-80'

INITIAL PRODUCTION

Date of first production Shut-in Producing method (flowing, pumping, gas lift, etc.) Flowing

RATE OF PRODUCTION PER 24 HOURS	Oil N/A bbls.	Gas 275 MCF	Water 70 bbls.	Gas-oil ratio N/A	CFPB
---------------------------------	---------------	-------------	----------------	-------------------	------

Disposition of gas (vented, used on lease or sold) Shut-in Producing interval(s) 3676-80 (Stalnaker)

INSTRUCTIONS: As provided in KCC Rule 82-2-125, within 90 days after completion of a well, one completed copy of this Drillers Log shall be transmitted to the State Geological Survey of Kansas, 4150 Monroe Street, Wichita, Kansas 67209. Copies of this form are available from the Conservation Division, State Corporation Commission, 3830 So. Meridian (P.O. Box 17027), Wichita, Kansas 66217. Phone AC 316-522-2206. If confidential custody is desired, please note Rule 82-2-125. Drillers Logs will be on open file in the Oil and Gas Division, State Geological Survey of Kansas, Lawrence, Kansas 66044.

DESIGNATE TYPE OF COMP.: OIL, GAS, DRY HOLE, SWDW, ETC.:

Operator Texas Oil & Gas Corp.		
Well No. 1	Lease Name Antrim	Shut-in Gas Well
S <u>30</u> T <u>32^S</u> R <u>8W</u> E W		

WELL LOG

Show all important zones of porosity and contents thereof; cored intervals, and all drill-stem tests, including depth interval tested, cushion used, time tool open, flowing and shut-in pressures, and recoveries.

SHOW GEOLOGICAL MARKERS, LOGS RUN, OR OTHER DESCRIPTIVE INFORMATION.

FORMATION DESCRIPTION, CONTENTS, ETC.	TOP	BOTTOM	NAME	DEPTH
Herrington	1577	-127		
Cottonwood	2130	-680		
Heebner	3368	-1918		
Douglas Group	3403	-1953		
Douglas Sand	3424	-1974		
Lansing	3628	-2178		
Stalnaker	3676	-2226		
Swope	4081	-2631		
Hertha	4112	-2662		
Mississippi	4415	-2965		
Kinderhook	4668	-3218		
Viola	4743	-3293		
Simpson	4803	-3353		
TD	4851	-3401		
PBTD	3694	-2244		
DST #1, 3402-60', (Douglas) w/results as follows: IFP/30": 274-722#, GTS/3" @ 1,233 MCFD w/mud spray in 25" ISIP/60": 1500# FFP/45": 677-740#, stable @ 4,640 MCFD w/mist of wtr FSIP/90": 1500# Rec 15' cond + 50' MW.				
DST #2, 4417-40', (Mississippi) w/results as follows: IFP/30": 174-163#, GTS/3" @ 526 MCFD & stable ISIP/60": 1884# FFP/45": 143-133#, 603 MCFD decr to 472 MCFD FSIP/90": 1665# Rec 93' VSO&GCM & 62' HO&GCM.				

USE ADDITIONAL SHEETS, IF NECESSARY, TO COMPLETE WELL RECORD.

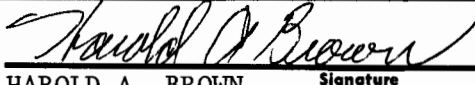
Date Received	
	HAROLD A. BROWN District Geologist
	Signature
	Title
	April 24, 1978
	Date

COMPANY **Texas Oil & Gas Corp.**

SEC. 30 T. 32S. 8W
LOC. 1,320 FSL & 1,320 FWL

FARM **Antrim** NO. **1**

COUNTY **Harper**
KANSAS

TOTAL DEPTH **4,851'**
COMM. **September 10, 1977** COMP. **September 22, 1977**
SHOT OR TREATED
CONTRACTOR **H-30, Inc.**
ISSUED **September 29, 1977**

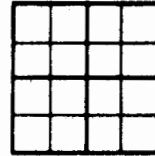

CASING

20	10		
15	8	5/8" 246' cemented w/300 sxs cement	ELEVATION 1,450 K.B.
12	6		
13	5		PRODUCTION

4 1/2" 4,547' cemented w/250 sxs cement
DV Tool @ 3,562 cemented w/ 150 sxs cement

Sand and Red Bed	215'
Shale and Red Bed	1,065'
Lime and Shale	2,640'
Lime	2,825'
Shale and Lime	3,016'
Lime and Shale	3,600'
Lime	3,704'
Lime and Shale	4,210'
Lime	4,440'
Lime and Shale	4,775'
Lime	4,851'
Rotary Total Depth	4,851'

I hereby certify that the above and foregoing to be a true and correct log of the above described well as shown by the drilling reports.

H-30, Inc.

Dean Britting
Dean Britting