

State Geological Survey  
**KANSAS BRANCH**  
**WICHITA DRILLERS LOG**

**IMPORTANT**  
 Kans. Geo. Survey request  
 samples on this well.

S. 31 T. 32 R. 9 W

API No. 15 — 077 — 20,247  
 County Number

Loc. SE SW

County Harper

Operator  
Clinton Oil Company

Address  
Box 1201 Wichita, Kansas

Well No. #1-V Lease Name F. Williams

Footage Location  
330' feet from (N) (S) line 2310' feet from (E) (W) line

Principal Contractor Rains & Williamson Geologist Bob Hammond

Spud Date 4-1-74 Total Depth 4835' P.B.T.D.

Date Completed 4-11-74 Oil Purchaser

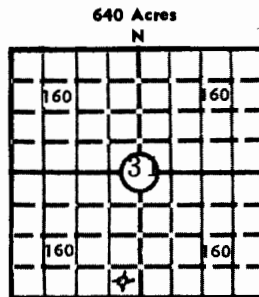

Elev.: Gr. 1383'

DF 1385' KB 1388'

**CASING RECORD**

Report of all strings set — surface, intermediate, production, etc.

Purpose of string	Size hole drilled	Size casing set (in O.D.)	Weight lbs/ft.	Setting depth	Type cement	Sacks	Type and percent additives
surface casing	12-1/4"	8-5/8"	20#	246'	60-40 poz	225	3% CC

**LINER RECORD**

**PERFORATION RECORD**

Top, ft.	Bottom, ft.	Sacks cement	Shots per ft.	Size & type	Depth interval

**TUBING RECORD**

Size	Setting depth	Packer set at

**ACID, FRACTURE, SHOT, CEMENT SQUEEZE RECORD**

Amount and kind of material used	Depth interval treated

**INITIAL PRODUCTION**

Date of first production	Producing method (flowing, pumping, gas lift, etc.)				
<b>RATE OF PRODUCTION PER 24 HOURS</b>	Oil	Gas	Water	Gas-oil ratio	
	bbls.	MCF	bbls.	CFPB	
Disposition of gas (vented, used on lease or sold)			Producing interval(s)		

INSTRUCTIONS: As provided in KCC Rule 82-2-125, within 90 days after completion of a well, one completed copy of this Drillers Log shall be transmitted to the State Geological Survey of Kansas, 4150 Monroe Street, Wichita, Kansas 67209. Copies of this form are available from the Conservation Division, State Corporation Commission, 3830 So. Meridian (P.O. Box 17027), Wichita, Kansas 66217. Phone AC 316-522-2206. If confidential custody is desired, please note Rule 82-2-125. Drillers Logs will be on open file in the Oil and Gas Division, State Geological Survey of Kansas, Lawrence, Kansas 66044.

Operator Clinton Oil Co. DESIGNATE TYPE OF COMP.: OIL, GAS, DRY HOLE, SWDW, ETC.: Dry Hole

Well No. 1 Lease Name F. Williams

S 31 T 32S R 9 R  
W

**WELL LOG**  
 Show all important zones of porosity and contents thereof; cored intervals, and all drill-stem tests, including depth interval tested, cushion used, time tool open, flowing and shut-in pressures, and recoveries. SHOW GEOLOGICAL MARKERS, LOGS RUN, OR OTHER DESCRIPTIVE INFORMATION.

FORMATION DESCRIPTION, CONTENTS, ETC.	TOP	BOTTOM	NAME	DEPTH
Limestone-buff-slight por-chalky-no show.	3946'	3959'	Heebner	3355'
Limestone-buff-trace of xtalline por. no show.	4008'	4012'	Kansas City	3895'
Chert-fresh to tripolitic-excellent pro. slight stain-good odor.	4349'	4380'	Stk. Sh.	4046'
Dolomite-gray to tan - fair porosity-no show.	4710'	4717'	Base KC	4111'
Dolomite-gray to tan-good vugular por. no show.	4730'	4737'	Cherokee	4259'
Sandy dolomite-few pieces w/por. - no show.	4759'	4775'	Miss. Cht.	4337'
Sandstone-trace of por. -loose sand. grains. no show.	4787'	4800'	Porosity	4347'
			Kinderhook	4600'
			Viola	4712'
			Sp. Sh.	4744'
			Sp Sdy. Dol	4755'
			Sp. S. S.	4761'
			2nd Sp. SS	4787'
			TD	4835'

DST #1 - 4352' - 65' (Miss)  
 60" ISIP - 1511#; 120" FSIP - 1517#;  
 30" IFP - 59#-205#; 60" FFP - 244#-442#; IHSP - 2336#; FHSP - 2234#,  
 Temp. 121°. Rec. 905' Fluid, 65' hv. OCM, 840' sl. OCW.



USE ADDITIONAL SHEETS, IF NECESSARY, TO COMPLETE WELL RECORD.

Date Received \_\_\_\_\_

Signature Donald D. Vaughan  
 Title District Geologist

Date May 13, 1974