

KANSAS

State Geological Survey

WELL COMPLETION REPORT AND DRILLER'S LOG

WICHITA BRANCH

S. 7 T. 33S R. 1 W
Loc. 990' FSL & 990' FEL
County Sumner

API No. 15 - 191 - 21,200
County Number

Operator: Hawkins Oil & Gas, Inc.
Address: 320 So. Boston Bldg., Suite 701, Tulsa, OK 74103
Well No. 1-7 Lease Name SUKOVATY
Footage Location: 990 feet from (S) line, 990 feet from (E) line
Principal Contractor: DNB Drilling, Inc. Geologist: Teerakun Karnchanakphan
Spud Date: 2-9-81 Date Completed: 2-20-81 Total Depth: 4287' P.B.T.D.
Directional Deviation: Oil and/or Gas Purchaser

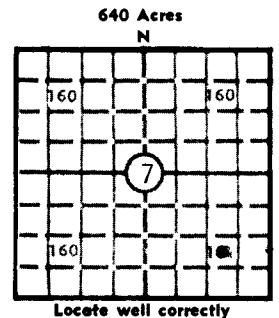

Locate well correctly
Elev.: Gr. 1222'
DF 1230' KB 1233'

CASING RECORD

Report of all strings set - surface, intermediate, production, etc.

Table with 8 columns: Purpose of string, Size hole drilled, Size casing set (in O.D.), Weight lbs/ft., Setting depth, Type cement, Sacks, Type and percent additives. Row 1: Surface, 12 1/4", 8 5/8", 24#, 255', Common, 175, 2% gel, 3% CC

LINER RECORD

PERFORATION RECORD

Tables for Liner Record (Top, Bottom, Sacks cement) and Tubing Record (Size, Setting depth, Packer set at). Perforation Record table is empty.

ACID, FRACTURE, SHOT, CEMENT SQUEEZE RECORD

Table with 2 columns: Amount and kind of material used, Depth interval treated. Includes a 'RECEIVED' stamp from the State Corporation Commission dated JUN 18 1981.

INITIAL PRODUCTION

Date of first production, Producing method (flowing, pumping, gas lift, etc.), RATE OF PRODUCTION PER 24 HOURS (Oil, Gas, Water, Gas-oil ratio), Disposition of gas (vented, used on lease or sold), Producing interval (s) Dry

INSTRUCTIONS: As provided in KCC Rule 82-2-125, within 90 days after completion of a well, one completed copy of this Drillers Log shall be transmitted to the State Geological Survey of Kansas, 4150 Monroe Street, Wichita, Kansas 67209. Copies of this form are available from the Conservation Division, State Corporation Commission, 245 No. Water, Wichita, Kansas 67202. Phone AC 316-522-2206. If confidential custody is desired, please note 82-2-125. Drillers Logs will be on an open file in the Oil and Gas Division, State Geological Survey of Kansas, Lawrence, Kansas 66044.

.cor

Hawkins Oil & Gas, Inc.

DESIGNATE TYPE OF COMP.: OIL, GAS,
DRY HOLE, SWDW, ETC.:

Well No. 1-7	Lease Name SUKOVATY	Dry Hole
S <u>7</u> T <u>33S</u> R <u>1</u> ^E / _W		

WELL LOG

Show all important zones of porosity and contents thereof; cored intervals, and all drill-stem tests, including depth interval tested, cushion used, time tool open, flowing and shut-in pressures, and recoveries.

SHOW GEOLOGICAL MARKERS, LOGS RUN,
OR OTHER DESCRIPTIVE INFORMATION.

FORMATION DESCRIPTION, CONTENTS, ETC.	TOP	BOTTOM	NAME	DEPTH
Sand, shale	0'	255'		
Sand, shale	255'	751'		
Sand, shale, lime	751'	975'		
Shale, lime	975'	3155'		
Shale	3155'	3235'		
Lime	3235'	3300'		
Lime, shale	3300'	3421'		
Lime	3421'	4215'		
Shale	4215'	4286'		
Sand	4286'	4287'	RTD	

USE ADDITIONAL SHEETS, IF NECESSARY, TO COMPLETE WELL RECORD.

Date Received	<p><i>Kathy B. McGuire</i> Signature</p> <p>Kathy B. McGuire / Operations Secretary Title</p> <p>June 10, 1981 Date</p>
---------------	---

DRILLER'S LOG

State Geological Survey
WICHITA, BRANCH

HAWKINS OIL & GAS, INC.
No. 1-7 Sukovaty
C NW SE SE
Sec 7-33S-1W
Summer Co., Ks.

Commenced: 2-9-81
Completed: 2-20-81

Surface Casing: 252' of 8-5/8"
cemented w/175 sx

FORMATION

DEPTH

Surface Hole	0 - 255
Sand & Shale	255 - 751
Sand, Shale & Lime	751 - 975
Shale & Lime	975 - 3155
Shale	3155 - 3235
Lime	3235 - 3300
Lime & Shale	3300 - 3421
Lime	3421 - 4215
Shale	4215 - 4286
Sand	4286 - 4287 RTD

do hereby certify that the foregoing statements are true and correct to the best of my knowledge and belief.

D N B DRILLING, INC.

James L. Donelson Jr
James L. Donelson, Jr.

STATE OF KANSAS: ss:

Subscribed and sworn to before me this 23rd day of February, 1981.

Dorothy L. Schmidt
Dorothy L. Schmidt, Notary Public

