

WELL LOG BUREAU--KANSAS GEOLOGICAL SOCIETY
508 East Murdock, Wichita, Kansas

4-33-11W

Company- AURORA GASOLINE CO.
Farm- Inslee No. 1

SEC. 4 T. 33 R. 11W
SW SE NE

Total Depth. 4455
Comm. 11-4-55 Comp. 11-22-55
Shot or Treated.
Contractor. S. A. Berwick Drilling Co.
issued. 2-4-56

County Barber
KANSAS

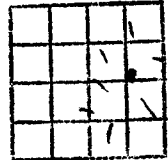

CASING:

8 5/8 @ 280' w/ 200 sx cmt.
5 1/2 @ 4455'

Elevation. 1485 DF

Production. 7,100,000 CFGPD

Figures indicate Bottom of Formations

surface shale	30
shale & shells	280
red bed	550
shale & shells	1295
lime & shells	1340
shale & lime	1645
lime	1670
lime & shale	2020
sandy lime & shale	2095
lime	2200
lime & shale	3610
shale & sand	3675
sand	3765
lime	4245
lime & shale	4304
lime	4350
lime & shale	4415
cherty lime	4425
lime	4455
Total Depth	

TOPS:

Heebner	3565
Douglas sand	3591
Mississippi	4415

DST #1: 3573-3610; open 1 hr. rec.
900' gas, 90' GCM, FP 50#, BHP 670#/
30 min.

DST #2: 3653-90, open 2 hrs. gas in
10 min. stabilized 686 MCF/1 hr. 30
min. rec. 240' GCM, IFP 85#, FFP 240#,
IBHP 1540#, BHP 1400#

DST #3: 4416-55, open 1 hr. gas in
3 min. stabilized 2 mil. CF, rec.
150' O&GCM, FP 430-500#, IBHP 1790#
BHP 1710#

KANSAS

WELL COMPLETION REPORT AND
DRILLER'S LOG

AMENDED REPORT

S. 4 T. 33 R. 11

API No. 15 ⁰⁰⁷ Not assigned
County Number

Loc. SW SE NE

County Barber

Operator
Gulf Oil Corporation

Address
P. O. Box 12116, Oklahoma City, OK 73157

Well No. 1 Lease Name Inslee

Footage Location
330 feet from ~~SEC~~ (S) line 990 feet from (E) ~~CON~~ line NE/4

Principal Contractor S. A. Berwick Drilling Co. Geologist

Spud Date 11/4/55 Date Completed 1/3/56 Total Depth 4455' P.B.T.D.

Directional Deviation Oil and/or Gas Purchaser
Cities Service Gas Co.

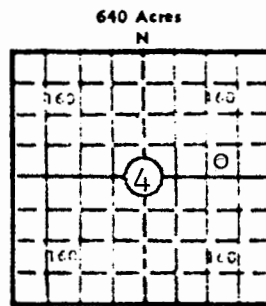

Locate well correctly
Elev.: Gr. 1482.5
DF 1485 KB 1486.5

CASING RECORD

Report of all strings set — surface, intermediate, production, etc.

Purpose of string	Size hole drilled	Size casing set (in O.D.)	Weight lbs/ft.	Setting depth	Type cement	Sacks	Type and percent additives
		8-5/8"		280'		225	
		5-1/2"	14	4455'		125	

LINER RECORD

PERFORATION RECORD

Top, ft.	Bottom, ft.	Sacks cement	Shots per ft.	Size & type	Depth interval
			3	Jets	4418-4426'
			3	Bullets	4433-4450'

TUBING RECORD

Size	Setting depth	Packer set at
2-3/8"	4415'	

ACID, FRACTURE, SHOT, CEMENT SQUEEZE RECORD

Amount and kind of material used	Depth interval treated
500 gals. MCA, 400# Adomite, 5000# Sand, 5000 gals. Kerosene	4418-4426' 4433-4450'

INITIAL PRODUCTION

Date of first production 1-18-56	Producing method (flowing, pumping, gas lift, etc.) Flowing
RATE OF PRODUCTION PER 24 HOURS	Oil 0 bbls. Gas OF 7183 MCF Water 0 bbls. Gas-oil CFPB
Disposition of gas (vented, used on lease or sold) Sold	Producing interval(s) Mississippi 4415-4450'

RECEIVED
STATE CORPORATION COMMISSION
MAR - 6 1980
CONSERVATION DIVISION
Wichita, Kansas

INSTRUCTIONS: As provided in KCC Rule 82-2-125, within 90 days after completion of a well, one completed copy of this Drillers Log shall be transmitted to the State Geological Survey of Kansas, 4150 Monroe Street, Wichita, Kansas 67209. Copies of this form are available from the Conservation Division, State Corporation Commission, 245 No. Water, Wichita, Kansas 67202. Phone AC 316-522-2206. If confidential custody is desired, please note the 82-2-125. Drillers Logs will be on open file in the Oil and Gas Division, State Geological Survey of Kansas, Lawrence, Kansas 66044.

ator

Gulf Oil Corporation

DESIGNATE TYPE OF COMP.: OIL, GAS,
DRY HOLE, SWDW, ETC.:
Gas

Well No. 1	Lease Name Inslee
---------------	----------------------

S 4 T 33 R 11 ^K / _W	Barber County
---	---------------

WELL LOG

Show all important zones of porosity and contents thereof; cored intervals, and all drill-stem tests, including depth interval tested, cushion used, time tool open, flowing and shut-in pressures, and recoveries.

SHOW GEOLOGICAL MARKERS, LOGS RUN, OR OTHER DESCRIPTIVE INFORMATION.

FORMATION DESCRIPTION, CONTENTS, ETC.	TOP	BOTTOM	NAME	DEPTH
DST #1 Open 1 hr., REC 900' gas 90' GCM; FP 50#, BHP - 670#	3573'	3610'	Geological Tops	
DST #2 Open 2 hr., GR 686 MCF 1 hr. 30 min., REC 240' GCM IBHP 1540#, IFP 85#, FFP 240#, FBHP - 1400#	3653'	3690'	Heebner Douglas Sand Lansing LKC Des Moines Mississippi	3563' 3593' 3769' 4246' 4256' 4417'
DST #3 Open 1 hr., gas in 3 min., 2 MCF in 1 hr., REC 150' OGCM, IBHP 1790#, FP 430 - 500#, FBHP - 1710#	4416'	4455'		
SAND	3675'	3765'		
LIME	3765'	4245'		
LIME AND SHALE	4245'	4304'		
LIME	4304'	4350'		
LIME AND SHALE	4350'	4415'		
LIME (CHERT)	4415'	4425'		
LIME	4425'	4455'		

USE ADDITIONAL SHEETS, IF NECESSARY, TO COMPLETE WELL RECORD.

Date Received	<i>John Bagzis</i> Signature
	John Bagzis Production Engineer Title
	March 3, 1980 Date