

Section 9 Township 33 Range 11 W

Well No. # 11 Newkirk

Company Sinclair

NORTH

4

	0						

WEST

EAST

SOUTH

SEC. 9	TWP. 33	R. 11W
-----------	------------	-----------

WELL NO. #11 Newkirk FARM  
 COMPANY

CONTRACTOR Sinclair

G-M-R

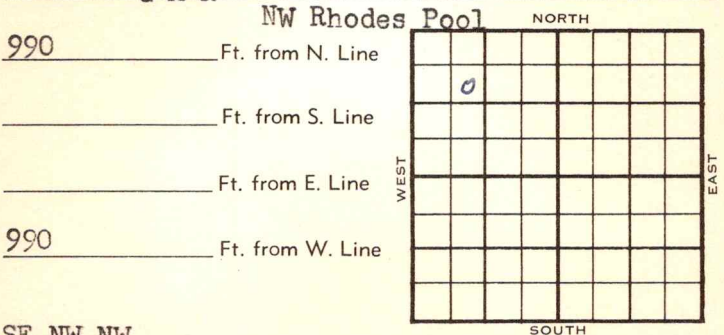

1955	ELEVATION 1463'	REPORT
------	--------------------	--------

3/16 Location  
 4/13 Spud 3-18-55 SI Gas well TD 4522  
 10" @ 240 Doug 3679  
 DST 3678-84 open 1 hr 45 min, gas in  
 3 min, 6,160,000 CFG in 5 min  
 4,735,000 CFG 15 min, 5,210,000 CFG  
 30 mins, 1490# Miss 4390  
 DST 4400-08 open 3 hr, gas in 35 min  
 rec 30' GCM, 1505# TD 4522'  
 Schl tops: Heeb 3534 Doug 3554  
 Doug sd 3641' KC 3742 Miss 4390  
 5" @ 4522 CO 12/3642-44 60/3649-  
 59' Comp. 9,200,000 CFGPD 980#

**COMPLETED**

County Barber State Kansas

Sec. 9 (Blk. Twp.) 33 (Sur. Rge.) 11W Map No.

Operator Sinclair

Well No. 11 Farm Newkirk

Elev. 1463 Location SE NW NW

990 Ft. From N Line NW

990 Ft. From W Line Quarter

1st. Report

Completion APR 13 1955

Remarks NWRhodes Pool

G-M-R - Contr.

Spudding Date 3-18-55

Drlg. Data SI Gas well TD 4522

10" @ 240 Doug. 3679 DST 3678-84

open 1 hr. 45 min. gas in 3 min.

6,160,000 cfg in 5 min. 4,735,000 cfg

15 min. 5,210,000 cfg 30 min. 1490#

Miss. 4390 DST 4400-08 open 3 hr.

gas in 35 min. Rec. 30' gcm 1505#

TD 4522 SCHLUMBERGER TOPS:

Heeb. 3534 Doug. 3554 Doug. sd.3641

KC 3742 Miss. 4390 5" @ 4522

CO 12/ 3642-44 60/ 3649-59

Comp. 9,200,000 cfgpd 980#

FABEN GILSTRAP

