

29-33-12w

State Geological Survey
KANSAS DRILLERS LOG
WICHITA, BRANCH

IMPORTANT
Kans. Geo. Survey request
samples on this well.

S. 29 T. 33 R. 12 W
Loc. NW SW
County Barber

API No. 15 — 007 — 20,177-A
County Number

Operator
Abercrombie Drilling, Inc.

Address
801 Union Center
Wichita, Kansas 67202

Well No. #1 Lease Name (Washdown & deepening of
Smith Estate Patton Oil Co.'s #1 Smith)

Footage Location
1980 feet from (S) line 660 feet from (W) line

Principal Contractor Abercrombie Drilling, Inc Geologist Robert E. McCann

Spud Date December 3, 1973 Total Depth 4898' P.B.T.D.

Date Completed December 11, 1973 Oil Purchaser

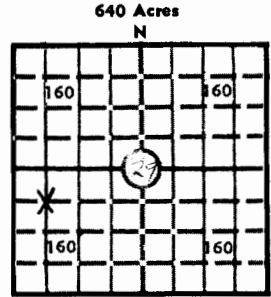

Locate well correctly
Elev.: Gr. 1493
DF 1500 KB 1502

CASING RECORD

Report of all strings set — surface, intermediate, production, etc.

Purpose of string	Size hole drilled	Size casing set (in O.D.)	Weight lbs/ft.	Setting depth	Type cement	Sacks	Type and percent additives

LINER RECORD

PERFORATION RECORD

Top, ft.	Bottom, ft.	Sacks cement	Shots per ft.	Size & type	Depth interval

Size	Setting depth	Packer set at

ACID, FRACTURE, SHOT, CEMENT SQUEEZE RECORD

Amount and kind of material used	Depth interval treated

INITIAL PRODUCTION

Date of first production _____ Producing method (flowing, pumping, gas lift, etc.) _____

RATE OF PRODUCTION PER 24 HOURS	Oil	Gas	Water	Gas-oil ratio

Disposition of gas (vented, used on lease or sold) _____ Producing interval(s) _____

INSTRUCTIONS: As provided in KCC Rule 82-2-125, within 90 days after completion of a well, one completed copy of this Drillers Log shall be transmitted to the State Geological Survey of Kansas, 4150 Monroe Street, Wichita, Kansas 67209. Copies of this form are available from the Conservation Division, State Corporation Commission, 3830 So. Meridian (P.O. Box 17027), Wichita, Kansas 66217. Phone AC 316-522-2206. If confidential custody is desired, please note Rule 82-2-125. Drillers Logs will be on open file in the Oil and Gas Division, State Geological Survey of Kansas, Lawrence, Kansas 66044.

Operator

Abercrombie Drilling, Inc.

DESIGNATE TYPE OF COMP.: OIL, GAS, DRY HOLE, SWDW, ETC.:

Dry Hole

Well No.

1

Lease Name

Smith Estate

S 29 T 33R 12 W

WELL LOG

Show all important zones of porosity and contents thereof; cored intervals, and all drill-stem tests, including depth interval tested, cushion used, time tool open, flowing and shut-in pressures, and recoveries.

SHOW GEOLOGICAL MARKERS, LOGS RUN, OR OTHER DESCRIPTIVE INFORMATION.

FORMATION DESCRIPTION, CONTENTS, ETC.	TOP	BOTTOM	NAME	DEPTH
Washdown to old T.D. 4554'			Chatanooga Sh.	4736
Lime	4554	4658	Kinderhook Sh.	4671
Shale & Sand	4658	4680	Viola	4788
Shale	4680	4737	Simpson Shale	4876
Lime	4737	4740	Simpson Sand	4880
Lime with Shale	4740	4772		
Shale	4772	4805		
Lime	4805	4865		
Shale & Lime	4865	4880		
Sand	4880	4889		
Lime and Sand	4889	4898		
Rotary Total Depth		4898		
<p>DST #1 (4784-17) 30"-30"-30"-30". Rec. 480' GIP, 105' gassy VSOCM, 30' gas cut thin mud. IFP 61#, IBHP 297#, FFP 92#, FBHP 245#.</p> <p>DST #2 (4869-84) 30"-30"-60"-45". Rec. 60' SO & GCM. IFP 20#, IBHP 133#, FFP 30#, FBHP 184#.</p> <p>DST #3 (4869-89) 30"-30"-60"-45". Weak blow increasing to fair. Rec. 60' SOCM. IFP 20#, IBHP 92#, FFP 51#, FBHP 133#.</p> <p>DST #4 (4885-98) 30"-30"-60"-45". Rec. 210' VSO & GCMW and 300' SMW w/spots of oil. IFP 20#, IBHP 1821#, FFP 276#, FBHP 1832#.</p>				

USE ADDITIONAL SHEETS, IF NECESSARY, TO COMPLETE WELL RECORD.

Date Received

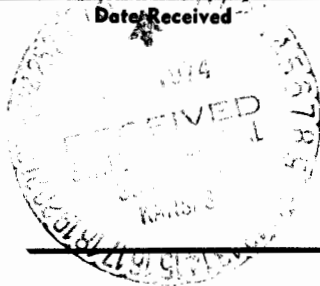

Jack K. Wharton
Signature
Geologist

Title

December 28, 1973

Date