

Ind. PI

STATE CORPORATION COMMISSION OF KANSAS
OIL & GAS CONSERVATION DIVISION
WELL COMPLETION OR RECOMPLETION FORM
ACO-1 WELL HISTORY

API NO. 15-.....007-22,075.5.....
County.....Barber.....
SE/4
..... Sec..... 2 Twp..... 33 Rge..... 14 East West

DESCRIPTION OF WELL AND LEASE

510
740
..... Ft North from Southeast Corner of Section
..... Ft West from Southeast Corner of Section
(Note: Locate well in section plat below)

Operator: License #
Name Bowen Oil & Exploration, Inc.
Address 720 N. Main - Suite 320
City/State/Zip Hutchinson, Kansas 67501

Lease Name..... Elmer Angel Well #..... 3-2.....

Purchaser..... Clear Creek
..... Wichita, Kansas

Field Name..... Wildeat

Operator Contact Person Ralph G. Fowen
Phone 316-665-6563

Producing Formation..... Viola

Elevation: Ground..... 1854 KB..... 1866

Contractor: License # 5149
Name Wheatstate Oilfield Services, Inc

Wellsite Geologist..... Mike Spain
Phone..... 316-838-9109

- Designate Type of Completion
- New Well Re-Entry Workover
 - Oil SWD Temp Abd
 - Gas Inj Delayed Comp
 - Dry Other (Core, Water Supply etc.)

If OWWO: old well info as follows:
Operator
Well Name
Comp. Date Old Total Depth.....

WELL HISTORY

Drilling Method:
 Mud Rotary Air Rotary Cable

8-28-85 9-8-85 9-9-85
Spud Date Date Reached TD Completion Date

5190 5129
Total Depth PBTD

Amount of Surface Pipe Set and Cemented at 352 feet
Multiple Stage Cementing Collar Used? Yes No

DEC 20 1985
State Geological Survey
WICHITA BRANCH

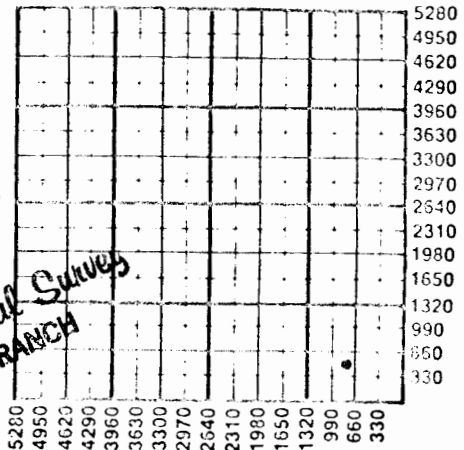

WATER SUPPLY INFORMATION
Disposition of Produced Water: Disposal Reinjecting
Docket #

Questions on this portion of the ACO-1 call:

Water Resources Board (913) 296-3717
Source of Water:
Division of Water Resources Permit #.....
 Groundwater.....Ft North from Southeast Corner
(Well)Ft West from Southeast Corner of
Sec Twp Rge East West
 Surface Water.....Ft North from Southeast Corner
(Stream, pond etc).....Ft West from Southeast Corner
Sec Twp Rge East West

	Oil	Gas	Water	Gas-Oil Ratio	Gravity
Estimated Production Per 24 Hours	38	38		85% oil 15% water	43°
	Bbls	MCF	Bbls	CFPB	

METHOD OF COMPLETION

Production Interval

- Disposition of gas: Vented Open Hole Perforation
 Sold Other (Specify)
- Used on Lease

SIDE TWO

Operator Name Bowen Oil & Exploration, Inc. Lease Name Elmer Angel Well # 3-2

Sec. 2 Twp. 33 Rge. 14 East West County Barber

WELL LOG

INSTRUCTIONS: Show important tops and base of formations penetrated. Detail all cores. Report all drill stem tests giving interval tested, time tool open and closed, flowing and shut-in pressures, whether shut-in pressure reached static level, hydrostatic pressures, bottom hole temperature, fluid recovery, and flow rates if gas to surface during test. Attach extra sheet if more space is needed. Attach copy of log.

Drill Stem Tests Taken Yes No
 Samples Sent to Geological Survey Yes No
 Cores Taken Yes No

DST #1 4600'-4660' 30/60/45/90
 IHP 2340psi; FHP 2319psi; ICP 68 psi; FCP 71 psi
 1st open: weak, died in 25 min; 2nd open: no blow
 Recovered - - 30' mud

DST #2 4659'-4684' 30/60/45/90
 IHP 2371psi; FHP 2350psi; ICP 60 psi; FCP 65 psi;
 1st open: 1/2" in water; 2nd open: weak in top
 of water for 5 min recovery, recovered 30' of mud

DST #3 4684'-4700' 30/60/45/90
 IHP 2445 psi; FHP 2424 psi; ICP 1143psi; FCP 945psi;
 1st open: good off btm of bucket in 15 min
 2nd open: good off btm of bucket in 12 min
 recovered 30' heavy mud 90' heavy mud cut water

DST #4 4915'-4920' 30/60/45/90
 IHP 2508psi; FHP 2478psi; ICP 1575psi; FCP 1497psi;
 1st open: Strong 30 seconds off btm of bucket
 2nd open: Strong immediately off btm of bucket
 Recovered 4600' clean gassy oil - 43° gravity

Formation Description		
Name	Top	Bottom
Red Bed	0	2085
Shale	2085	2993
Lime, Shale	2993	5190

DEC 20 1985
 State Geological Survey
 WICHITA BRANCH

DST #5 5097'-5124' 30/60/45/90
 IHP 2572psi; FHP 2540psi; ICP 1728psi; FCP 1570psi;
 1st open: surge but no blow
 2nd open: no blow, flushed tool
 Recovered 35' mud.

CASING RECORD <input type="checkbox"/> New <input checked="" type="checkbox"/> Used Report all strings set-conductor, surface, intermediate, production, etc.							
Purpose of String	Size Hole Drilled	Size Casing Set (in O.D.)	Weight Lbs/Ft.	Setting Depth	Type of Cement	#Sacks Used	Type and Percent Additives
surface		8 5/8	23	352'	class A	275	
production		4 1/2"	106	5181'	standard	100	pot chlor msa acid 10%
PERFORATION RECORD				Acid, Fracture, Shot, Cement Squeeze Record			
Shots Per Foot	Specify Footage of Each Interval Perforated			(Amount and Kind of Material Used)		Depth	
4	4986 - 4988			500 gals 15% clean-up oil			
2	4990 - 5000			3000-15% acid 6-CI2 8-NFL 30-AG11 45-Ferrotrol 5 pot chlor			
				500 gals w/sap tool 2500 gals SGA15% acid			
TUBING RECORD		Size <u>2 3/8</u>	Set At <u>5125</u>	Packer at <u>none</u>	Liner Run <input type="checkbox"/> Yes <input checked="" type="checkbox"/> No		
Date of First Production		Producing Method					
<u>Oct 2, 1985</u>		<input type="checkbox"/> Flowing <input checked="" type="checkbox"/> Pumping <input type="checkbox"/> Gas Lift <input type="checkbox"/> Other (explain).....					



Oilfield Services, Inc.

2-33-14W^{P1}

- Rotary Drilling
- Drilling Mud and Chemicals
- Heavy Oil Field Hauling
- Roustabout and Dirt Services
- Well Completion and Servicing Units

DRILLER'S WELL LOG

Elmer Angel #3-2 ✓
 510' FSL 740' FEL Sec. 2-33S-14W
 Barber County, Kansas
 Commenced: 8-28-85
 Completed: 9-9-85
 API #15-007-22,075
 Operator: Bowen Oil & Exploration, Inc.

Depth		Formation	Remarks
From	To		
0	2085	Red Bed	Ran 1 joint (39') of 13 3/8 conductor casing. Cemented with 40 sxs Class A, 3%cc, 2% gel. Job by B. J. Titan.
2085	2993	Shale	
2993	5190	Lime, Shale T.D.	Ran 8 joints (339') new 23# 8 5/8" surface casing. Set at 352' with 235 sxs Class A, 3%cc, 2% gel. Cement did circulate. Plug down at 4:45 p.m. on 8-29-85. Job by B.J. Titan.
			RTD 5190'
			Ran 124 joints 4 1/2" casing. Set at 5181' with 125 sxs lite, 100 sxs Class A with 1/2 gal latex per sx. Plug down at 12:00 a.m. 9-9-85. Job by Halliburton of Pratt.

SEP 8 0 1985
 State Geological Survey
 WICHITA BRANCH

STATE OF KANSAS)
) ss
 COUNTY OF PRATT)

I, the undersigned, being duly sworn on oath, state that the above Driller's Log is true and correct to the best of my knowledge and belief and according to the records of this office.

WHEATSTATE OILFIELD SERVICES, INC.

Arnie Little
 ARNIE LITTLE, VICE-PRESIDENT



Mary L. Tjaden
 NOTARY PUBLIC

RECEIVED
 STATE CORPORATION COMMISSION

My Commission Expires:

3/22/88

SEP 27 1985

CONSERVATION DIVISION
 Wichita, Kansas