

State Geological Survey
WICHITA, BRANCH

KANSAS DRILLERS LOG

API No. 15 — 033 — 20,198
County Number

Operator
National Oil Company

Address
200 W. Douglas, Suite 550, Wichita, KS 67202

Well No. 4 Lease Name Merrill

Footage Location
660 feet from (M) (S) line 560 feet from (M) (W) line

Principal Contractor DaMac Drilling Co., Inc. Geologist Bill Sladek

Spud Date April 20, 1976 Total Depth 5000' P.B.T.D.

Date Completed May 2, 1976 Oil Purchaser

S. 23 T. 33S R. 16W E
W
Loc. 100' W of SW SW
County Comanche

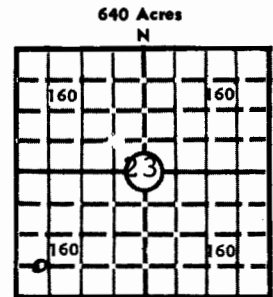

Locate well correctly
Elev.: Gr. 1761
DF 1763 KB 1765

CASING RECORD

Report of all strings set — surface, intermediate, production, etc.

Purpose of string	Size hole drilled	Size casing set (in O.D.)	Weight lbs/ft.	Setting depth	Type cement	Sacks	Type and percent additives
Surface		8-5/8		311	Regular	150	2% gel, 3% cc
Production		4-1/2	10.5	4970	50-50 Pos	175	18% salt, .075% CFR2

LINER RECORD

PERFORATION RECORD

Top, ft.	Bottom, ft.	Sacks cement	Shots per ft.	Size & type	Depth interval
			3		4897-99'
			2		4909-12'

TUBING RECORD

ACID, FRACTURE, SHOT, CEMENT SQUEEZE RECORD

Amount and kind of material used	Depth interval treated
500 gal MCA	4897-99'
Frac 8250# 20-40 sand	4909-12'

INITIAL PRODUCTION

Date of first production <u>Shut In</u>	Producing method (flowing, pumping, gas lift, etc.)				
RATE OF PRODUCTION PER 24 HOURS	Oil	Gas	Water	Gas-oil ratio	
	bbls.	2100 MCF		bbls.	CFPB
Disposition of gas (vented, used on lease or sold)			Producing interval (s)		
			4897-99' & 4909-12'		

INSTRUCTIONS: As provided in KCC Rule 82-2-125, within 90 days after completion of a well, one completed copy of this Drillers Log shall be transmitted to the State Geological Survey of Kansas, 4150 Monroe Street, Wichita, Kansas 67209. Copies of this form are available from the Conservation Division, State Corporation Commission, 3830 So. Meridian (P.O. Box 17027), Wichita, Kansas 66217. Phone AC 316-522-2206. If confidential custody is desired, please note Rule 82-2-125. Drillers Logs will be on open file in the Oil and Gas Division, State Geological Survey of Kansas, Lawrence, Kansas 66044.

Operator
National Oil Company

DESIGNATE TYPE OF COMP.: OIL, GAS,
DRY HOLE, SWDW, ETC.:
Gas

Well No. 4 Lease Name Merrill

s 23 T 33S R 16WE W 100' W of SW SW

WELL LOG

Show all important zones of porosity and contents thereof; cored intervals, and all drill-stem tests, including depth interval tested, cushion used, time tool open, flowing and shut-in pressures, and recoveries.

SHOW GEOLOGICAL MARKERS, LOGS RUN, OR OTHER DESCRIPTIVE INFORMATION.

FORMATION DESCRIPTION, CONTENTS, ETC.	TOP	BOTTOM	NAME	DEPTH
DST #1, 4889-4915'; 30-60-60-60; GTS in 9", 161 MCF in 5", 129 MCF in 30"; 2nd opening 107 MCF immediately, built up & stabilized @ 143 MCF; Rec 70' mud, no wtr; IFP 74-03; FFP 56-83; ISIP 1818; FSIP 1809.			Log Tops Heebner Douglas Lansing Marmaton Mississippi	4078 -2313 4102 -2337 4247 -2482 4776 -3011 4896 -3131
DST #2, 4915-40'; 30-60-60-60; Str blow; GTS 48" into the FSI; Rec 12' mud; IFP 88; FFP 56-37; ISIP 1800; FSIP 1790.				
DST #3, 4940-55'; 30-60-60-60; Wk blow, died; Rec 10' drlg mud; IFP 27; FFP 27; BHP 126-45.				

USE ADDITIONAL SHEETS, IF NECESSARY, TO COMPLETE WELL RECORD.

Date Received

RB Jenkins
Signature
Exploration Manager
Title
July 14, 1976
Date