

KANSAS

WELL COMPLETION REPORT AND
DRILLER'S LOG

State Geological Survey

API No. 15 — 033 — 20434 WICHITA BRANCH
County Number

S. 17 T. 33 R. 19 ^{XX}W

Loc. NW/NE

County Comanche

Operator
Bow Valley Petroleum Inc.

Address
1700 Broadway Suite 900 Denver, Colorado 80290

Well No. 17-1 Lease Name N.V. Lindsay

Footage Location
660 feet from (N) ~~XX~~ line 1980 feet from (E) ~~XX~~ line

Principal Contractor Husky Drilling Co. Geologist Bob Williams

Spud Date 6-18-81 Date Completed 6-29-81 Total Depth 5350' P.B.T.D. 5300'

Directional Deviation 1° @ 5350' Oil and/or Gas Purchaser N.A.

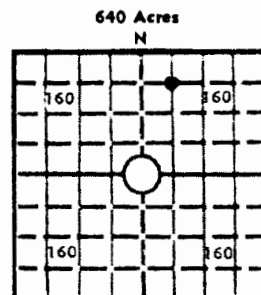

Elev.: Gr. 1950

DF 1958 KB 1960

CASING RECORD

Report of all strings set — surface, intermediate, production, etc.

Purpose of string	Size hole drilled	Size casing set (in O.D.)	Weight lbs/ft.	Setting depth	Type cement	Sacks	Type and percent additives
Conductor	26"	16"	65#	60'	Grout	65	2% CaCl ₂
Surface	12 1/4"	8 5/8"	24#	553'	Lite & Common	500	3% CaCl ₂ 1/4# Flocele
Production	7 7/8"	4 1/2"	10.5# 9.5#	5327'	H. & Pozmix	250	15% Salt 10# Gilsonite

LINER RECORD

PERFORATION RECORD

Top, ft.	Bottom, ft.	Sacks cement	Shots per ft.	Size & type	Depth interval
N.A.			1 SPF	.4" Jet	5203-5284
TUBING RECORD			2 SPF	.4" Jet	4816-4818
			2 SPF	.4" Jet	4403-4406
Size 2 3/8"	Setting depth 5170	Packer set at 5108	2 SPF	.4" Jet	4321-4324

ACID, FRACTURE, SHOT, CEMENT SQUEEZE RECORD

Amount and kind of material used	Depth interval treated
1000 Gals 15% HCL acid (7-14-81)	
500 Gals 15% HCL acid (7-16-81)	5203-5284
Frac w/38,500 Gals gelled acid & 51,000 lbs. sand (7-19-81)	5203-5284
750 Gals 15% HCL acid (9-12-81)	5203-09
500 Gals 15% HCL acid (12-3-81)	4816-4818
500 Gals 15% HCL acid (12-6-81)	4403-4406
1000 Gals 28% HCL acid (12-8-81)	4321-4324

INITIAL PRODUCTION

Date of first production 7-24-81 Producing method (flowing, pumping, gas lift, etc.) Swabbing

RATE OF PRODUCTION PER 24 HOURS
Oil Trace bbls. Gas None MCF Water 113 bbls. Gas-oil ratio N.A. CFPB

Disposition of gas (vented, used on lease or sold) N.A. Producing interval(s) 5203-5284

INSTRUCTIONS: As provided in KCC Rule 82-2-125, within 90 days after completion of a well, one completed copy of this Drillers Log shall be transmitted to the State Geological Survey of Kansas, 4150 Monroe Street, Wichita, Kansas 67209. Copies of this form are available from the Conservation Division, State Corporation Commission, 245 No. Water, Wichita, Kansas 67202. Phone AC 316-522-2206. If confidential custody is desired, please note Rule 82-2-125. Drillers Logs will be on open file in the Oil and Gas Division, State Geological Survey of Kansas, Lawrence, Kansas 66044.

Operator **Bow Valley Petroleum Inc.** DESIGNATE TYPE OF COMP.: OIL, GAS, DRY HOLE, SWDW, ETC.:

Well No. **17-1** Lease Name **N.V. Lindsay** Dry Hole

S 17 T 23 R 19 W

WELL LOG

Show all important zones of porosity and contents thereof; cored intervals, and all drill-stem tests, including depth interval tested, cushion used, time tool open, flowing and shut-in pressures, and recoveries.

SHOW GEOLOGICAL MARKERS, LOGS RUN, OR OTHER DESCRIPTIVE INFORMATION.

FORMATION DESCRIPTION, CONTENTS, ETC.	TOP	BOTTOM	NAME	DEPTH
Mississippi - water w/tr oil	5203	5350		
Cherokee - water	5116	5203		
Marmaton - water	4964	5116		
Swope	4908	4964		
Lansing/Kansas City - water	4460	4870		
Douglas - water	4339	4460		
Toronto - water	4286	4339		
Heebner - Non Porous	4274	4286		
<p>Logs run: Dual Induction Focused Log w/Gamma Ray and Spontaneous Potential, Compensated Density-Neutron Log w/Gamma Ray & Caliper, Mud Log.</p>				

USE ADDITIONAL SHEETS, IF NECESSARY, TO COMPLETE WELL RECORD.

Date Received	Signature
	Title
	Date