

**KANSAS DRILLERS LOG**

API No. 15 — 033 — 20,422  
 County Number

S. 36 T. 23S R. 20W  
 State Geological Survey  
 WICHITA BRANCH  
 County Comanche

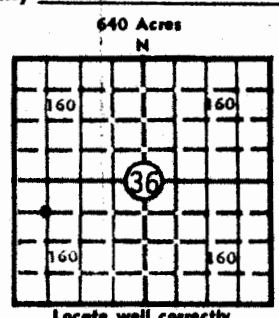

Operator  
 R.J. Patrick Operating Company

Address  
 P.O. Box 1314, Liberal, KS 67901

Well No. 2 Lease Name RALPH BAKER

Footage Location  
 1980' feet from (N) (S) line 660' feet from (E) (W) line

Principal Contractor NRG Drilling, Inc. Geologist Mr. Joseph Blair

Spud Date March 20, 1981 Total Depth 4820' P.B.T.D. --

Date Completed March 28, 1981 P&A Oil Purchaser

Elev.: Gr. 1819'  
 DF 1827' KB 1830'

**CASING RECORD**

Report of all strings set — surface, intermediate, production, etc.

Purpose of string	Size hole drilled	Size casing set (in O.D.)	Weight lbs/ft.	Setting depth	Type cement	Sacks	Type and percent additives
Conductor Pipe	30"	20"	20#steel	61'	Grout	6½ yds	None
Surface Pipe	12¼"	8-5/8"	24#	653'	HOWCO Lite	500 sks	3%CC

**LINER RECORD**

**PERFORATION RECORD**

Top, ft.	Bottom, ft.	Sacks cement	Shots per ft.	Size & type	Depth interval

**TUBING RECORD**

Size	Setting depth	Pecker set at

**ACID, FRACTURE, SHOT, CEMENT SQUEEZE RECORD**

Amount and kind of material used	Depth interval treated

**INITIAL PRODUCTION**

Date of first production DRY HOLE Producing method (flowing, pumping, gas lift, etc.) ---

RATE OF PRODUCTION PER 24 HOURS	Oil	Gas	Water	Gas-oil ratio
	bbls.	MCF	bbls.	CFPB
Disposition of gas (vented, used on lease or sold)			Producing interval (s)	

INSTRUCTIONS: As provided in KCC Rule 82-2-125, within 90 days after completion of a well, one completed copy of this Drillers Log shall be transmitted to the State Geological Survey of Kansas, 4150 Monroe Street, Wichita, Kansas 67209. Copies of this form are available from the Conservation Division, State Corporation Commission, 3830 So. Meridian (P.O. Box 17027), Wichita, Kansas 66217. Phone AC 316-522-2206. If confidential custody is desired, please note Rule 82-2-125. Drillers Logs will be on open file in the Oil and Gas Division, State Geological Survey of Kansas, Lawrence, Kansas 66044.

Operator R.J. Patrick Operating Company  
 P.O. Box 1314, Liberal, KS 67901

DESIGNATE TYPE OF COMP.: OIL, GAS,  
 DRY HOLE, SWD, ETC.:  
 DRY HOLE

Well No. 2 Lease Name RALPH BAKER

s 36 T 33 R 20 W Comanche County, KS

**WELL LOG**

Show all important zones of porosity and contents thereof; cased intervals, and all drill-stem tests, including depth interval tested, cushion used, time tool open, flowing and shut-in pressures, and recoveries.

SHOW GEOLOGICAL MARKERS, LOGS RUN, OR OTHER DESCRIPTIVE INFORMATION.

FORMATION DESCRIPTION, CONTENTS, ETC.	TOP	BOTTOM	NAME	DEPTH
Red Bed, Shale	0'	970'		
Shale, Red Bed	970'	1950'		
Lime, Shale	1950'	2916'		
Shale, Lime	2916'	3645'		
Lime, Shale	3645'	4305'		
Shale	4305'	4695'		
Lime, Shale	4695'	4820'		
RTD		4820'		
LTD		4826'		

USE ADDITIONAL SHEETS, IF NECESSARY, TO COMPLETE WELL RECORD.

Date Received	
	R.J. Patrick Signature
	Owner Title
	April 7, 1981 Date

# K. G. S. LIBRARY

36-33-20W  
C NW SW

## DRILLER'S LOG

K.J. Patrick Operating Company  
P.O. Box 1314  
Liberal, KS 67901

Total Depth: 4820'

RALPH BAKER #2  
C-NW-SW Section 36-33S-20W  
Comanche County, Kansas

Surface Casing: Drilled 655' of 12 1/4" hole.  
Ran 17 jts. new 24# 8-5/8"  
Surface Casing, 655' OA, set @653' KB. Cemented  
with 300 sks Halliburton Lite, 1/4# floreal,  
2% CC; 200 sks Halliburton Heavy, 3% CC. Plug  
down at 7:30 AM 3/21/81. Cement circulated.

Commenced: March 20, 1981  
Completed: March 26, 1981

Elev: 1830 KB 1819 GL

FORMATION	FROM	TO	REMARKS
Red Bed, Shale	0'	970'	RTD 4820'
Shale, Red Bed	970'	1950'	LTD 4826'
Lime, Shale	1950'	2916'	
Shale, Lime	2916'	3645'	
Lime, Shale	3645'	4305'	
Shale	4305'	4695'	
Lime, Shale	4695'	4820'	
		4820'	

I certify that this is a true and correct copy of the log on the above captioned well to the best of my knowledge.

NRG Drilling, Inc.

By Elmer Jack Taylor  
Elmer Jack Taylor, Vice President

Subscribed and sworn to be fore me this 3rd day of April 19 81

V. Kay Lucas  
Notary Public V. Kay Lucas

My commission expires

