

IMPORTANT  
Kans. Geo. Survey request  
samples on this well.

15-025-20178

API No. 15 — 025 — 20,178  
County Number

S. 2 T. 33 R. 21 <sup>K</sup>/<sub>W</sub>

Loc. C N2 NE

County Clark

Operator  
Lear Petroleum Corp.

Address  
2601 NW Espressway, Suite 1200, Okla City, Okla 73112

Well No. #1 Lease Name  
Shrauner

Footage Location  
660 feet from (N)  line 1320 feet from (E)  line

Principal Contractor Search Drilling Company Geologist  
W. P. Andy Anderson

Spud Date November 14, 1977 Total Depth 5250' P.B.T.D. 5250'

Date Completed November 26, 1977 Oil Purchaser

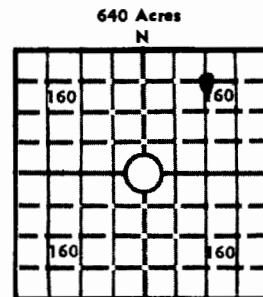

Locate well correctly  
Elev.: Gr. 1852'

DF 1860' KB 1862'

**CASING RECORD**

Report of all strings set — surface, intermediate, production, etc.

Purpose of string	Size hole drilled	Size casing set (in O.D.)	Weight lbs/ft.	Setting depth	Type cement	Sacks	Type and percent additives
Surface	12-1/2	8-5/8	24#	672	Class "A"	550	10# Gilsomite 1/4# Flocele
							Did not circulate pumped down back- side to fill.

**LINER RECORD**

**PERFORATION RECORD**

Top, ft.	Bottom, ft.	Sacks cement	Shots per ft.	Size & type	Depth interval

<b>TUBING RECORD</b>		
Size	Setting depth	Packer set at

**ACID, FRACTURE, SHOT, CEMENT SQUEEZE RECORD**

Amount and kind of material used	Depth interval treated

**INITIAL PRODUCTION**

Date of first production		Producing method (flowing, pumping, gas lift, etc.)			
RATE OF PRODUCTION PER 24 HOURS	Oil bbls.	Gas MCF	Water bbls.	Gas-oil ratio	CFPB
Disposition of gas (vented, used on lease or sold)			Producing interval (s)		

**INSTRUCTIONS:** As provided in KCC Rule 82-2-125, within 90 days after completion of a well, one completed copy of this Drillers Log shall be transmitted to the State Geological Survey of Kansas, 4150 Monroe Street, Wichita, Kansas 67209. Copies of this form are available from the Conservation Division, State Corporation Commission, 3830 So. Meridian (P.O. Box 17027), Wichita, Kansas 66217. Phone AC 316-522-2206. If confidential custody is desired, please note Rule 82-2-125. Drillers Logs will be on open file in the Oil and Gas Division, State Geological Survey of Kansas, Lawrence, Kansas 66044.

Operator

Lear Petroleum Corporation

DESIGNATE TYPE OF COMP.: OIL, GAS,  
DRY HOLE, SWDW, ETC.:  
Dry Hole

Well No.  
#1

Lease Name  
Shrauner

S 2 T 33 R 21 E  
W

**WELL LOG**

Show all important zones of porosity and contents thereof; cored intervals, and all drill-stem tests, including depth interval tested, cushion used, time tool open, flowing and shut-in pressures, and recoveries.

SHOW GEOLOGICAL MARKERS, LOGS RUN,  
OR OTHER DESCRIPTIVE INFORMATION.

FORMATION DESCRIPTION, CONTENTS, ETC.	TOP	BOTTOM	NAME	DEPTH
Chase	2343			
Council Grove	2698			
Nabaunsee	3244			
Tariko	3391			
Topeka	3750			
Heebner	4164			
Lansing K.C.	4358			
Marmaton	4876			
Cherokee	5047			
Morrow	5147			
Morrow B Sand	5160			
Morrow C Sand	5180			
Mississipian	5204			
TD	5250			
DST 5146 - 5174 IH 2669, IF 244-190 (15 min.), ISI 1686 (30 min.) FF 190 - 407 (30 min.), FSI 1713 (60 min.) Good blow throughout, recovered 325 Heavy Oil & Gas, cut mud and 440' salt water. Max flow rate 8.9 MCF.				

USE ADDITIONAL SHEETS, IF NECESSARY, TO COMPLETE WELL RECORD.

Date Received

Signature

Mike Purdum, Drilling Supervisor

Title

February 16, 1978

Date