

State Geological Survey

WICHITA BRANCH KANSAS DRILLERS LOG

15-119-20326

API No. 15 — 119 — 20,326
County Number

S. 29 T. 33S R. 26 ^{EX}W
Loc. 100' W-C-E/2- NE
County Meade

Operator
Hawkins Oil & Gas

Address
P.O. Box 1578, Liberal, Kansas 67901

Well No. 1 Lease Name Horner

Footage Location
1320 feet from (N) line 760 feet from (E) line

Principal Contractor B & N Drilling Geologist

Spud Date 9-23-78 Total Depth 5860' P.B.T.D. 5818

Date Completed 10-20-78 Oil Purchaser

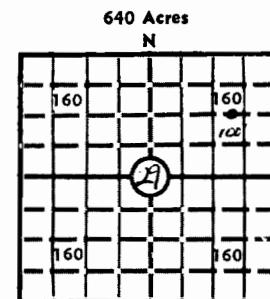

Elev.: Gr. 2311
DF 2319' KB 2321'

CASING RECORD

Report of all strings set — surface, intermediate, production, etc.

Purpose of string	Size hole drilled	Size casing set (in O.D.)	Weight lbs/ft.	Setting depth	Type cement	Sacks	Type and percent additives
Surface	12 1/4	8 5/8	23#	733'	lite Class H	350 150	2% cc 3% cc
Production	7 7/8	4 1/2"	10.5#	5870'	Class H	50	8% Gel - 12 1/2# Gil. 10% salt
					50/50 pozmix	200	18% salt - 12 1/2# Gil. - 3/4% CFR-2

LINER RECORD

PERFORATION RECORD

Top, ft.	Bottom, ft.	Sacks cement	Shots per ft.	Size & type	Depth interval
			2	3 1/8" DP	5762-74'

Size	Setting depth	Packer set at
2 3/8"	5755'	

ACID, FRACTURE, SHOT, CEMENT SQUEEZE RECORD

Amount and kind of material used	Depth interval treated
1500 gals 15% BDA	5762-74
30,000 gals gelled 5% acid & 22,000# 20/40 sand	" "

INITIAL PRODUCTION

Date of first production 11-2-78 Producing method (flowing, pumping, gas lift, etc.) Flowing

RATE OF PRODUCTION PER 24 HOURS
Oil bbls. 179 Gas MCF 1/2 Water bbls. Gas-oil ratio CFPB

Disposition of gas (vented, used on lease or sold) Sold Producing interval (s) 5762-74'

INSTRUCTIONS: As provided in KCC Rule 82-2-125, within 90 days after completion of a well, one completed copy of this Drillers Log shall be transmitted to the State Geological Survey of Kansas, 4150 Monroe Street, Wichita, Kansas 67209. Copies of this form are available from the Conservation Division, State Corporation Commission, 3830 So. Meridian (P.O. Box 17027), Wichita, Kansas 66217. Phone AC 316-522-2206. If confidential custody is desired, please note Rule 82-2-125. Drillers Logs will be on open file in the Oil and Gas Division, State Geological Survey of Kansas, Lawrence, Kansas

Operator Hawkins Oil & Gas		DESIGNATE TYPE OF COMP.: OIL, GAS, DRY HOLE, SWDW, ETC.: Gas
Well No. 1	Lease Name Horner	
S <u>29</u> T <u>33S</u> R <u>26</u> ^{EX} W		

WELL LOG

Show all important zones of porosity and contents thereof; cored intervals, and all drill-stem tests, including depth interval tested, cushion used, time tool open, flowing and shut-in pressures, and recoveries.

SHOW GEOLOGICAL MARKERS, LOGS RUN, OR OTHER DESCRIPTIVE INFORMATION.

FORMATION DESCRIPTION, CONTENTS, ETC.	TOP	BOTTOM	NAME	DEPTH
Sand & Clay	0	340		
Lime & Clay	340	584		
Clay & Shale	584	1000		
Shale	1000	2615		
Lime & Shale	2615	5751		
Lime	5751	5860		
USE ADDITIONAL SHEETS, IF NECESSARY, TO COMPLETE WELL RECORD.				

Date Received	
	Signature
	Harold K. Frauli, Agent
	Title
	November 24, 1978
	Date

STATE OF KANSAS
STATE CORPORATION COMMISSION - CONSERVATION DIVISION
245 North Water
Wichita, Kansas 67202

FORM C-2

DATA AND AFFIDAVIT

(On Cementing in Surface or Drive Pipe and required by Rule 82-2-123 of the Commission for compliance with Section 55-136, 55-137 and 55-138, 1947 Supplement to G. S. Kansas 1935)

LEASE OWNER Hawkins Oil & GasOFFICE ADDRESS P.O. Box 1578, Liberal, KansasLEASE NAME Horner WELL NO. 1 COUNTY Meade (W)EXACT SPOT LOCATION 100' W-C E/2 NE SEC. 29 TWP. 33S RGE. 26 (E)CONTRACTOR B & N DrillingOFFICE ADDRESS Great Bend, KansasDrilled with (Cable) or (Rotary) tools: Date pipe set 9-25-78SURFACE HOLE DATASURFACE PIPE DATASize of Hole 12 1/2 Csg. (new) or (used) Size 8 5/8 Wt. 23#Depth 1571' Where set 733'METHOD OF CEMENTINGCement: Amount and kind 350 sacks Halco lite - 2% cc & 150 sacks class H - 3% ccMethod: (By Service Co., Dump, Tog., etc.) Halliburton pumpedEst. Height Cement behind pipe circulatedGROUND WATER INFORMATIONDepth to bottom of lowest fresh water producing stratum 100'Name of lowest fresh water producing stratum OgallalaSurface elevation of well 2311ADDITIONAL INFORMATION

(Additional information may be submitted on separate sheet)

A F F I D A V I TSTATE OF Kansas, COUNTY OF Seward SS,

I, Harold K. Frauli, Agent, of the Hawkins Oil & Gas Company, being first duly sworn on oath, state: That I have knowledge of the facts, statements and matters herein contained and that the same are true and correct.