

Section 26 Township 33 Range 30W

Well No. #6 Novinger

Company Columbian Fuel

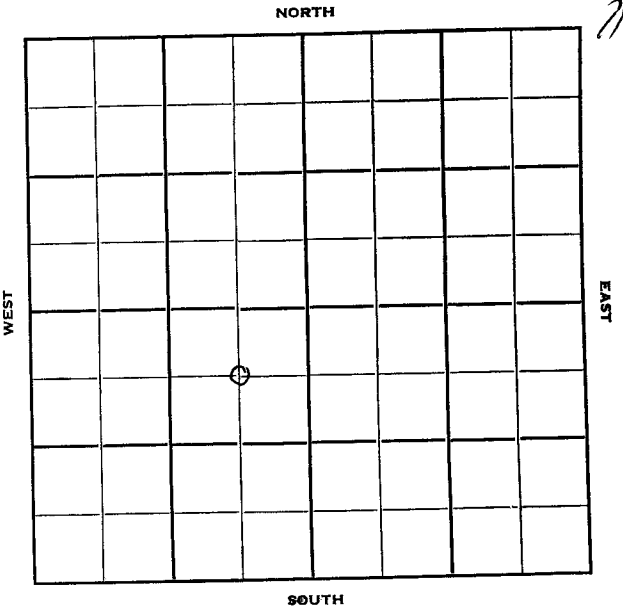

Meade

KANSAS  
30W

Sec. 26 Twp. 33 R. 30W

Well No. #6 Novinger Farm

Columbian Fuel Company

Contractor

Novinger Pool

660' Ft. from N. Line

Ft. from S. Line

660' Ft. from E. Line

Ft. from W. Line

C NE SW

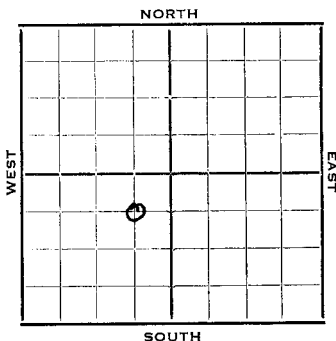

1952 Elev. 2709' REPORT

2/20 Location

3/5 "

3/12 "

3/19 16" @ 334'  
Drlg. 670'

3/25 RTD 2720'

4/1 Drlg. 4196'

4/9 Drlg. 5223'

4/23 \*ST 5292-5332 40 mins oil to surf 15"  
F during test est 5230 clean oil  
F est 5 to 25 BOPH

Marm por 5294 RTD 5361 5" @ 5360

4/30 Stonecarrell 1690'  
Hol 2625' Her 2690' Krider 2722'  
Winfield 2825' Up Ft. 2'22'  
Low Ft. 2958' Lans. 4480'

5/7 NR

5/14 CO 5344 12/ 5287-89 dry sq. off.  
18/5327-30 2 M gas SI

5/21 F 243 BO 14 hrs. thru tub. F 22  
Boph for 24 hrs. 25/64" chk.  
180/5297-5327 22 Boph for 10 hrs.  
45/64" ck.

1952

5/28 Spud 3-15-52  
Oil Well TD 5361  
16" @ 334 Stonecorrell 1690  
Hol. 2625 Her. 2690  
Kri 2722 Win 2825  
Ft. Riley 2822 Lans. 4480  
DST 5292-5332 opn 40 min,  
oil to surface in 15 min.  
F/5 to 25 boph Marm 5294  
TD 5361 5" @ 5360 CO to 5344  
12/5287-89 18/5327-30 2 mcfg  
F/243 bo 14 hr. F/22 boph  
180/5297-5327 22 boph  
Comp. 2170 bopd

**COMPLETED**

County **Meade** State **Kansas**

Sec. **26** (Blk. Twp.) **33** (Sur. Rge.) **30W** Map No.

Operator **Columbian Fuel**

Well No. **6** Farm **Novinger**

Level. Location **C NE SW**

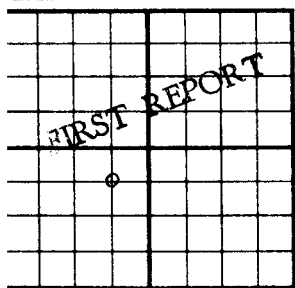

**660** Ft. From **N** Line **SW**

**660** Ft. From **E** Line Quarter

1st. Report **FEB 20 1952**

Completion

Remarks

Spudding Date

Orig. Data **Novinger Pool**

**Location**

County Meade State Kansas  
 Sec. 26 (Blk. 33 (Sur. 30W Map No.  
Twp. Rge.)

Operator Columbian Fuel

Well No. 6 Farm Novinger

Elev. 2709 Location C NE SW

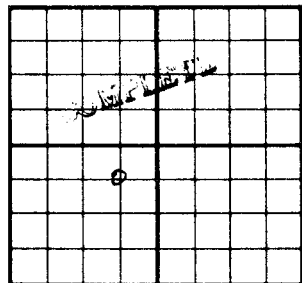

660 Ft. From N Line SW

660 Ft. From E Line Quarter

1st. Report

Completion MAY 28 1952

Remarks Novinger Pool

Spudding Date 3-15-52

Drig. Data Oil well TD 5361

16" @ 334 Stonecorrell 1690 Hol. 2625

Her. 2690 Kri. 2722 Win. 2825

Ft. Riley 2822 Lans. 4480 DST 5292-5332

open 40 min. oil to surface in 15 min.

F/ 5 to 25 boph Marm. 5294 TD 5361

5" @ 5360 CO to 5344 12/ 5287-89

18/ 5327-30 2 mcfg F/ 243 bo 14 hr.

F/ 22 boph 180/ 5297-5327 22 boph

Comp. 2170 bopd