

Section 27 Township 33 Range 30 W

Well No. # 2 Kennedy

Company Columbian Fuel

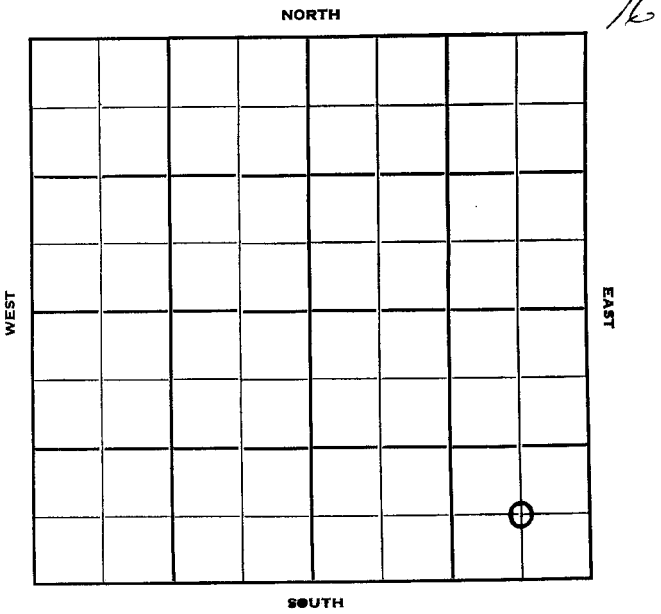

Sec. 27 Twp. 33 R. 30W

Well No. #2 Kennedy Farm

Columbian Fuel Company

Contractor

Ft. from N. Line
660 Ft. from S. Line
660 Ft. from E. Line
Ft. from W. Line
C SE SE

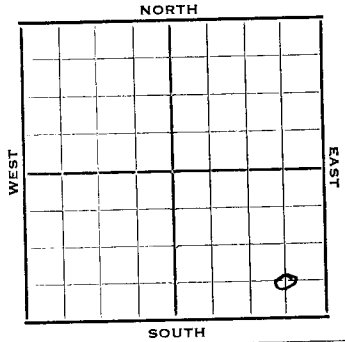

1952 Elev. 2706 REPORT

5/28	Spud 5-23-52 13" @ 601' Drlg. 1905'
6/11	8" @ 2713' Drlg. 4972'
6/18	DST 5284-5320', 1 hr. gas in 20" 1170' clean oil 150' HO&GCM 1170# 15" TD 5300' Schl. 5" @
6/25	B Blane 970 Anhy 1448 Wellington 2165 Hal 2624 Her 2702 KC 4470 Marm por 5293-5300 RTD 5327 5" @ 5327
7/2	NR
7/9	CO 5328 Sq off CO 5294 Sq off
7/17	CO 5305' 42/5295-5302' 4 BOPH To A
7/23	NR
7/30	"

1952

8/6 Spud 5-23-52
Oil Well Tl 5330
13" @ 601 8" @ 2 13
DIT 5284-5320 opn 1 hr. gas in 20
min. Rec. 1170 clean oil 150' ho
& gcm 1170# TL 5330
D. Elone 70 Inhy 14 8
Wellington #165 No. 7624
Mer. 2702 4470
Mara. 5 93 5327
5" @ 5327 00 to 5305
42/5295-5302 4 boph 1500A
Comp. 316 bopd

21. 11/19

County Leade State Kansas

Sec. 27 (Blk. Twp.) 33 (Sur. Rge.) 30W Map No.

Operator Columbian Fuel

Well No. 2 Farm Kennedy

Elev. 2706 Location C SE SE

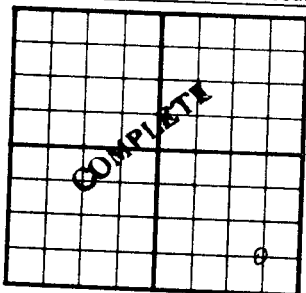

660 Ft. From S Line SE

660 Ft. From E Line Quarter

1st. Report

Completion AUG 6 1952

Remarks

Spudding Date 5-23-52

Drilg. Data Oil well TD 5330

13" @ 601 8" @ 2713 DST 5284-5320

open 1 hr. gas in 20 min. Rec. 1170'

clean oil 150' ho & gcm 1170'

TD 5330 B. Blane 970 Anhy 1448

Wellington 2165 Hel. 2624 Her. 2702

KC 4470 Farm. 5293 RTD 5327 5" @ 5327

CO to 5305 42/ 5295-5302 4 bopd

1500 A Comp. 316 bopd

County **Meade** State **Kansas**

Sec. **27** (Blk. **33**) (Sur. **30W**) (Twp. **33**) (Rge. **30W**) Map No.

Operator **Columbian Fuel**

Well No. **2** Farm **Kennedy**

Elev. Location **C SE SE**

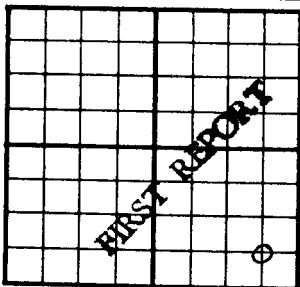

660 Ft. From **S** Line **SE**

660 Ft. From **E** Line Quarter

1st. Report **MAY 28 1952**

Completion

Remarks

Spudding Date **5-23-52**

Drig. Data

15" @ 601 Dirs 1905

~~Handwritten scribble~~

J. G. McGEHEE

County Meade State Kansas

Sec. 27 (Blk. 33 (Sur. 30W Map No. (Twp.) (Rge.))

Operator Columbian Fuel

Well No. 2 Farm Kennedy

Elev. 2706 Location C SE SE

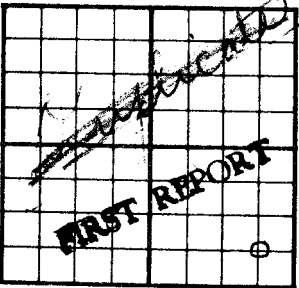

660 Ft. From S Line SE

660 Ft. From E Line Quarter

Ist. Report MAY 28 1952

Completion _____

Remarks _____

Spudding Date 5-23-52

Drlg. Data Hugoton Pool

J. G. McGENEE