

WICHITA BRANCH
KANSAS DRILLERS LOG

IMPORTANT
Kans. Geo. Survey request
samples on this well.

15-191-20786

API No. 15 — 191 — 20,786
County Number

S. 18 T. 33 R. 3 ^XW
Loc. C SE NW
County Sumner

Operator
Hummon Oil Company and Leonard Ropfogel

Address
1725 Vickers KSB&T Building Wichita, Kansas 67202

Well No. #1 Lease Name Small

Footage Location
660 feet from ~~CRK~~ (S) line 660 feet from (E) ~~CRK~~ line

Principal Contractor Gabbert-Jones, Inc. Geologist Byron E. Hummon, Jr.

Spud Date June 17, 1978 Total Depth 4530 P.B.T.D. 4107'

Date Completed August 23, 1978 Oil Purchaser Koch Oil Company

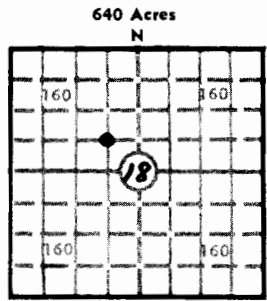

Locate well correctly
Elev.: Gr. 1247
DF 1250 KB 1252

CASING RECORD

Report of all strings set — surface, intermediate, production, etc.

Purpose of string	Size hole drilled	Size casing set (in O.D.)	Weight lbs/ft.	Setting depth	Type cement	Sacks	Type and percent additives
Surface	12 1/4"	8-5/8	28#	238'	Common	200sx.	2% Gel, 3% CC
Production	7-7/8"	4 1/2"	10 1/2#	4146'	60/40 Poz.	100sx.	18% salt

LINER RECORD

PERFORATION RECORD

Top, ft.	Bottom, ft.	Sacks cement	Shots per ft.	Size & type	Depth interval
-----	-----	-----	2 holes/ft.	DP shot	4077 - 4082

TUBING RECORD		
Size	Setting depth	Packer set at
2"	4072'	NONE

ACID, FRACTURE, SHOT, CEMENT SQUEEZE RECORD

Amount and kind of material used	Depth interval treated
Acidize w/500 gal. MCA	4077 - 4082
Frac w/50sx. 20/40 foam	4077 - 4082

INITIAL PRODUCTION

Date of first production <u>September 5, 1978</u>		Producing method (flowing, pumping, gas lift, etc.) <u>flowing</u>	
RATE OF PRODUCTION PER 24 HOURS	Oil <u>55</u> bbls.	Gas <u>120</u> MCF	Water <u>120</u> bbls.
Disposition of gas (vented, used on lease or sold) <u>venting</u>		Producing interval (s) <u>4077 - 4082</u>	

INSTRUCTIONS: As provided in KCC Rule 82-2-125, within 90 days after completion of a well, one completed copy of this Drillers Log shall be transmitted to the State Geological Survey of Kansas, 4150 Monroe Street, Wichita, Kansas 67209. Copies of this form are available from the Conservation Division, State Corporation Commission, 3830 So. Meridian (P.O. Box 17027), Wichita, Kansas 66217. Phone AC 316-522-2206. If confidential custody is desired, please note Rule 82-2-125. Drillers Logs will be on open file in the Oil and Gas Division, State Geological Survey of Kansas, Lawrence, Kansas 66044.

Operator Hummon Oil Company DESIGNATE TYPE OF COMP.: OIL, GAS, DRY HOLE, SWDW, ETC.: Oil

Well No. 1 Lease Name Small

S 18 T 33S R 3 ~~XX~~ W

WELL LOG
 Show all important zones of porosity and contents thereof; cored intervals, and all drill-stem tests, including depth interval tested, cushion used, time tool open, flowing and shut-in pressures, and recoveries. SHOW GEOLOGICAL MARKERS, LOGS RUN, OR OTHER DESCRIPTIVE INFORMATION.

FORMATION DESCRIPTION, CONTENTS, ETC.	TOP	BOTTOM	NAME	DEPTH
DST #1: (Mississippi) 45/60/45/60 Strong blow GTS 4 min. Ga. 175,000 CFG increase to 211,000 CFG on 1st op. 211,000 - 202,000 CFG on 2nd op. Rec. 30' O&GCM, 120' HO&GCM, 390' SMGO & 30' G&OCW SIP 1656/1666 FP 115/147 BHT 131°	4068	4090	<u>LOG TOPS</u>	
			Elmont	1992
			White Cloud	2114
			Howard	2168
			Severy	2242
			Severy Sand	2260
			Topeka	2336
			B. Topeka	2518
			Elgin Sand	2582
			Heebner Sh	2745
			Iatan Lime	3064
			Stalnaker Sd	3079
			Kansas City	3394
B.K.C.	3674			
DST #2: (Simpson Sand) 30/30/15/30 Wk blow for 15 min. & died Rec. 30' drilling mud SIP 71/59 FP 23/47	4480	4500	Mississippi	4066
			Kinderhook Sh	4412
			Simpson Sd	4489
			LTD	4533
DST #3: (Simpson Sand) 30/30/30/30 Wk blow throughout Rec. 290' MW SIP 1695/1684 FP 47/119 BHT 131°	4500	4530		

USE ADDITIONAL SHEETS, IF NECESSARY, TO COMPLETE WELL RECORD.

Date Received _____

 Signature
 Wilber Berg
 Title
 February 23, 1979
 Date