

W.P.B. Meade

KANSAS

O.W.W.O.

Section 30 Township 33 Range 30W

Well No. #1 Wheatley ~~C.C. WHEATLEY~~ ~~e. e. WHEAT~~

Company Columbian Fuel

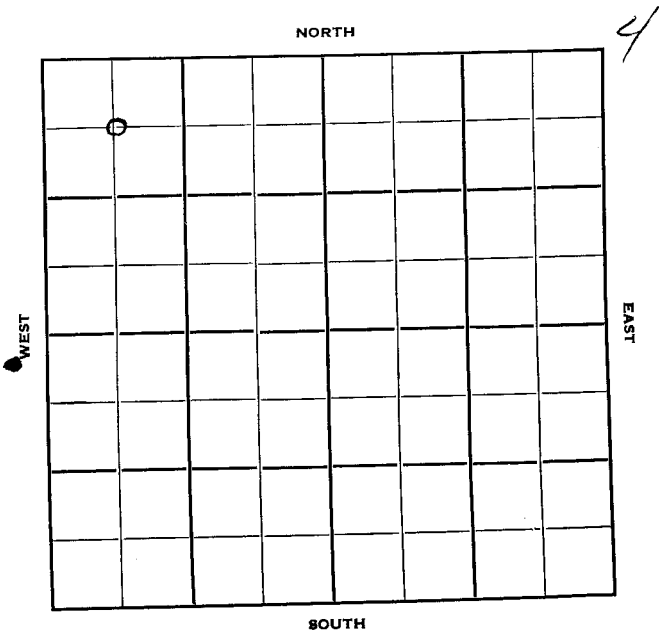

FORM 100-B
O.W.P.B. Meads

Sec. 30 Twp. 33 O.W.W.O. 30W

Well No. #1 Wheatley ~~C.C. WHEAT~~ Farm

Columbian Fuel Company

Wildcat (Deep Test) E KISMET POOL Contractor

660 Ft. from N. Line

Ft. from S. Line

Ft. from E. Line

660 Ft. from W. Line

NW 1/4 C NW NW

Stanolind - DHM

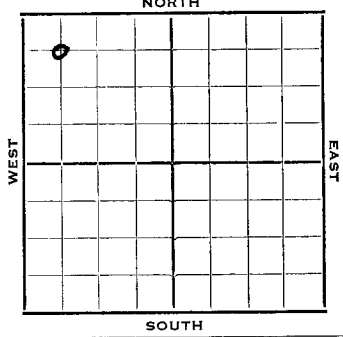

1952	Elev. 2722'	REPORT
		Deep Test
10/29	MIM	
11/5	13" @ 691	
	Drlg. 1966'	
11/12	8" @ 2602	
	DST 2698 -	
11/20	DST 2630-98, 2 hrs, 20' M	DST 2780-2895', 1 hr, 50' salty M, 180' SW
	DST 3100-3130, 2 1/2 hrs, 115' GCM	60,000 gas.
	DST 3102-34, 2 hrs, 123' GCM, 60,000 gas, 585# 20"	
	DST 3170-3240, 2 hrs, 45' M	525# 20"
	DST 3310-40, 1 hr, 600' SW, 940' muddy SW, 660# 15"	
	TD 3475'	
11/27	NR	
12/4	DST 4384-4436, opn 1 hr., rec. 210' mud, 540' SW, 1290#	
	DST 4584-4602, opn 1 hr., rec. 675' SW	
	DST 3595-3610, opn 1 hr., rec. 1975' SW, 1035#	
	Drlg. 4682	
	Hol. 2550, Her. 2590, Win 2705, Ft. Riley 2755'	

#1 Wheatly .

12/11 Ø5336

12/18 Morrow 5626 @ 563385 52' DST 5645 -85 (60 Mins 3½ Gas 55' Dist & GCM 1800 #20" @ 5686-5718 32' DST 5706-18 1½ Hr 15' M Ø5766

12/25 " " " " "

1/1 Chester 5718 DST 5720-68 1 Hr. 5' M o # DST 6082-6120 RTD 1 Hr. 50' O&GCM 905 # 5" @ 6117

1/8 4/3226-27 Sq.

1/22 Testing

1/29 "

2/5 "

2/12 "

2/19 "

2/26 Testing

3/12 "

3/19 "

3/26 "

4/2 "

4/9 "

4/16 "

4/23 "

4/29 Spud 10-30-52 Gas well TD 6120' 13" @ 691 8" @ 2602
DST 2630-98 open 2 hr rec 20' mud
DST 2780-2895 open 1 hr rec 50' salty mud, 180' SW 540#
DST 3100-3130 open 2½ hr. rec 115' GCM 60,000 gas 725#
DST 3102-314 open 2 hr rec 123' GCM 60,000 gas 585#
DST 3190-3240 open 2 hr rec 45' mud 525#
DST 3310-40 open 1 hr. rec 600' MSW 940' SW 660# TD 3475
DST 4384-4436 open 1 hr rec 210' mud 540' SW 1290#
DST 4584-4602 open 1 hr. rec 675' SW
DST 3595-3610 open 1 hr rec 1975' SW 1035# Hol 2550' Her. 2590'
Win. 2705' Ft. Riley 2755'
DST 4673-4710 open 1 hr rec 110' SW & mud, 450' SW 1455# Morrow 5626'

1 Wheatley

1953

4/29

(Information continued)

DST 5645-85 open 50 min 3½ MCFG
 55' dist & GCM 1800#
 DST 5706-19 open 90 min rec 15' mud
 Chester 5718
 DST 5720-68 open 1 hr rec 5' mud O#
 DST 6082-6120 open 1 hr rec 50' G &
 OCM 905# 5" @ 6117
 4/3226-27 48/6086-96 25 GOCMPH
 500 A 17 GO 43 GWPH SP 5760
 72/5722-34 24/5742-46 8 GMPH 500
 S/6 BOPH 18 hr. 16/5734-42 1 BOPH
 2500 A B/18 BF 18 hr. 50% oil
 PB 5753 42/5145-52 F/6 BO 6 hr.
 F/21 BO 24 hr. F/10 BOPD 8 days
 F/7 BOPD F/5 to 7 BOPD
 Comp. 5½ MCFGPD

COMPLETED

W.W.O.

1954

2/17

Hol 2550', Her. 2590', Win 2705'
 Chester 5718'

OTD 6120'

M I C T

3/3

PB 5683'

3/17

Gas well TD 6120' Hol.2550
 Her. 2590 Win. 2705'
 Chester 5718' OTD 6120 PB 5683'
 Comp. 3 MCFGPD

COMPLETED

O.W.P.B.

1955

4/27

Hol. 2534', Her. 2584', Kri 2656',
 Win. 2708', Ft. Riley 2771', ~~Chester~~
 Florence flint 2889', KC 4457', Marn
 5100', Cherokee 5275', Atoka 5407',
 Morrow sh. 5624', Morrow sd. 5645',
 Chester 5718', St. Gen. 5925', St.
 Louis 6098'

OTD 6120'

5" @ 6117', CO, SP 5600

4/3171-75, SSG

S/20 gf SSG sq 3171-75, WOC

County **Meade** State **Kansas**

Sec. **30** (Blk. Twp.) **33** (Sur. Rge.) **30W** Map No.

Operator **Columbian Fuel**

Well No. **1** Farm **Wheatley**

Elev. Location **C NW NW**

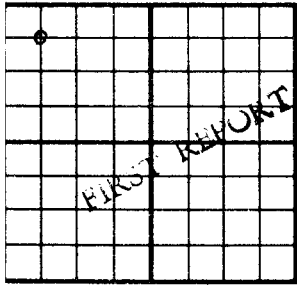

660 Ft. From **N** Line **NW**

660 Ft. From **W** Line **Quarter**

1st. Report **OCT 29 1952**

Completion

Remarks **Stanolind - DIM**

Spudding Date

Orlg. Data **Wildcat (deep test)**

M I M

County State Kansas

Sec. 30 (Blk. Twp.) 33 (Sur. Rge.) 30 Map No.

Operator Columbian Fuel

Well No. 1 Farm Theatley

Elev. 2722 Location

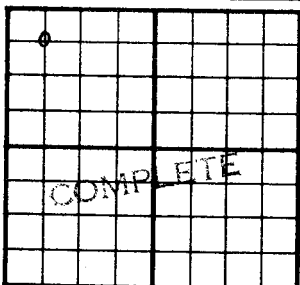

600 Ft. From Line

600 Ft. From Line Quarter

1st. Report

Completion PR 29 1953

Remarks Wildcat

Spudding Date 10-30-52

Drlg. Data Gas well TD 6120

13" 2691 8" 2602 DST 2680-28

open 2 hr. Rec. 20' mud DST 2780-2895

open 1 hr. Rec. 50' salty mud 180' sw

540' DST 3100-3130 open 2 1/2 hr.

Rec. 115' com 60,000 gas 725"

DST 3102-34 open 2 hr. Rec. 123' com

60,000 gas 585" DST 3190-3240

open 2 hr. Rec. 45' mud 525"

DST 3310-40 open 1 hr. Rec. 600' msw

340' sw 660" TD 3475 DST 4324-4436

open 1 hr. Rec. 210' mud 540' sw

1290" DST 4584-4602 open 1 hr.

Rec. 675' sw DST 3595-3610 open 1 hr.

Rec. 1075' sw 1035" Hel. 2550

J. G. McGEHEE

O.W.W.O.

County **Meade** State **Kansas**

Sec. **30** (Blk. Twp.) **33** (Sur. Rge.) **30W** Map No.

Operator **Columbian Fuel**

Well No. **1** Farm **C. C. Wheat**

Elev. **2722** Location **C NW NW**

0					

660 Ft. From **N** Line **NW**

660 Ft. From **W** Line Quarter

1st. Report **FEB 17 1954**

Completion

Remarks **O.W.W.O.**

O.W.W.O.

Spudding Date

Drig. Data **E. Kismet Pool**

Hol. 2550 Her. 2590 Win. 2705

Chester 5718 OTD 6120 M I C T

J. G. McGEHEE

County Meade State Kansas

Sec. 30 (Blk. Twp.) 33 (Sur. Rge.) 30W 0 Tap No.

Operator Columbian Fuel

Well No. 1 Farm C. C. Wheatley

Elev. 2722 Location C NW NW

6				

660 Ft. From N Line NW

660 Ft. From W Line Quarter

1st. Report APR 27 1955

Completion

Remarks OWPB

Spudding Date

Orig. Data

Hol. 2534 Her. 2584 KPI. 2656

Win. 2708 Ft. Riley 2771 Florence flint

2889 KC 4457 Marm. 5100 Cherokee 5275

Atoka 5407 Morrow sh. 5624 Morrow sd.

5645 Chester 5718 St. Gen. 5925

St. Louis 6098 OTD 6120 5" @ 6117

CO SP 5600 4/ 3171-75 SSG

S/ 20 gf SSG sq. 3171-75 WOC

K-33

FABEN GILSTRAP