

KANSAS DRILLERS LOG

API No. 15 — 189 — 20,202
 County Number

S. 1 T. 33S R. 38 ~~EX~~ W
 Loc. 1320' FSL & 330' FWL
 County Stevens

Operator
Anadarko Production Company

Address
 Box 351, Liberal, Kansas 67901

Well No. 1 Lease Name **Savage "A"**

Footage Location
 1320 feet from ~~XXX~~ (S) line 330 feet from ~~XXX~~ (W) line

Principal Contractor **Gabbert-Jones, Inc.** Geologist

Spud Date 7-27-73 Total Depth 2975' P.B.T.D.

Date Completed 8-29-73 Oil Purchaser

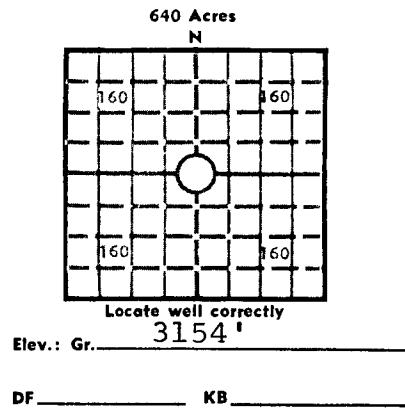

CASING RECORD

Report of all strings set — surface, intermediate, production, etc.

| Purpose of string | Size hole drilled | Size casing set (in O.D.) | Weight lbs/ft. | Setting depth | Type cement | Sacks | Type and percent additives |
|-------------------|-------------------|---------------------------|----------------|---------------|------------------------|---------------|---|
| Surface | 12-1/4" | 8-5/8" | 24# | 519' | Common Common | 450 100 | 3% CC 3% CC |
| Production | 7-7/8" | 5-1/2" | 14# | 2974' | Litewate SaltSatPoz | 500 4% 150 | gel 12# .5% CFR-2 Gilsonit per s |
| | | | | | | | |
| | | | | | | | |

LINER RECORD

PERFORATION RECORD

| Top, ft. | Bottom, ft. | Sacks cement | Shots per ft. | Size & type | Depth interval |
|----------------------|---------------------|---------------|---------------|-------------|----------------|
| | | | 2 | | 2948-52' |
| TUBING RECORD | | | 2 | | 2824-34' |
| | | | 2 | | 2902-13' |
| Size 2-3/8" | Setting depth 2827' | Packer set at | 2 | | 2892-96' |
| | | | 2 | | 2831-82' OA |

ACID, FRACTURE, SHOT, CEMENT SQUEEZE RECORD

| Amount and kind of material used | Depth interval treated |
|--|------------------------|
| Acid w/500 gals 15% HCL + 10 BS. Sq w/100 sx common. | 2948-52' |
| Acid w/1000 gals 15% + 25 BS. Sq w/100 sx common. | 2824-34' |
| Acid w/1000 gals 15% + 40 BS. | 2892-2913' OA |
| Acid w/3000 gals 15% + 100 BS. Fraced w/120,000 gals | 2831-2913' OA |
| wtr + 100,000# sand. | |

INITIAL PRODUCTION Potential

Date of first production Not connected as yet Producing method (flowing, pumping, gas lift, etc.) **Flowing**

RATE OF PRODUCTION PER 24 HOURS
 Oil bbls. Gas IWHOF 3386 MCF Water bbls. Gas-oil ratio

Disposition of gas (vented, used on lease or sold) **Will be sold** Producing interval (s) **2831-2913'**

INSTRUCTIONS: As provided in KCC Rule 82-2-125, within 90 days after completion of a well, one completed copy of this Drillers Log shall be transmitted to the State Geological Survey of Kansas, 4150 Monroe Street, Wichita, Kansas 67209. Copies of this form are available from the Conservation Division, State Corporation Commission, 3830 So. Meridian (P.O. Box 17027), Wichita, Kansas 66217. Phone AC 316-522-2206. If confidential custody is desired, please note Rule 82-2-125. Drillers Logs will be on open file in the Oil and Gas Division, State Geological Survey of Kansas, Lawrence, Kansas 66044.

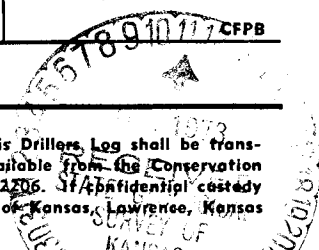

DRILLER'S LOG

WELL NAME Savage "A" #1 COMPANY OPERATING Anadarko Production Co.
 ADDRESS OF COMPANY Box 351, Liberal, Kansas
 WELL LOCATION 1/4 1/4 1/4
1320 Ft. North of South Line,
330 Ft. East of West Line, Sec. 1, Twp. 33S, Rge. 38W, Stevens County, Kansas
 DRILLING STARTED 7-27, 19 73, DRILLING COMPLETED 7-31, 19 73
 WELL COMPLETED 8-29, 19 73, WELL CONNECTED _____, 19 _____
 ELEVATION 3154 Ft. Ground Level CHARACTER of WELL (Oil, Gas, Dry Hole) Gas

FOR GAS SANDS OR ZONES - PERFORATIONS - ACIDIZING AND FRACTURING INFORMATION

| Name | From | To | No. of Shots | Gallons Used | Kind Used |
|---------------|-------|------|--------------|-------------------------------------|------------------|
| Council Grove | 2948 | 2952 | 8 | Acid w/500 gals 15% | Sq w/100 sx com. |
| " | 2824 | 2834 | 20 | Acid w/1000 gals 15% | Sq w/100 sx com. |
| " | 2902 | 2913 | 22 | Acid 2902-13' & 2892-96' w/1000 | |
| " | 2892 | 2896 | 8 | gals 15%. | |
| " | 2878 | 2882 | 8 | | |
| " | 2870 | 2876 | 12 | Acid 2831-2913' OA w/3000 gals 15%. | |
| " | 2858 | 2860 | 4 | Fraced 2831-2913' OA w/120,000 gals | |
| " | 2852- | 2856 | 8 | wtr + 100,000# sand. | |
| " | 2845 | 2848 | 6 | | |
| " | 2838 | 2850 | 24 | | |
| " | 2831 | 2835 | 8 | | |

8 CASING RECORD

| Size | Amount Set | Sacks of Cement | Amount Pulled |
|--------|------------|-----------------|---------------|
| 8-5/8" | 519' | 450 | None |
| 5-1/2" | 2974' | 650 | None |
| 2-3/8" | 2827' | SN @ 2811' | None |

FORMATION RECORD

| Formation | Top | Bottom | Formation | Top | Bottom |
|----------------|------|--------|-----------|-----|--------|
| Sand & red bed | 0 | 522 | | | |
| Red bed | 522 | 887 | | | |
| Shale & shells | 887 | 1470 | | | |
| Shale & anhy | 1470 | 1805 | | | |
| Shale | 1805 | 2051 | | | |
| Shale & shale | 2051 | 2975 | | | |
| Total Depth | 2975 | | | | |
| | | | | | |
| | | | | | |
| | | | | | |
| | | | | | |

RESULTS OF INITIAL PRODUCTION TEST: IWHOF 3386 MCFD (check test)