

## KANSAS DRILLERS LOG

API No. 15 — 189 — 20,405  
County Number

Operator  
ANADARKO PRODUCTION COMPANY

Address  
P. O. BOX 351, LIBERAL, KANSAS 67901

Well No. 1 Lease Name SPIKES "C"

Footage Location  
2590 feet from (N) (S) line 150 feet from (E) (W) line

Principal Contractor Lohmann-Johnson Geologist Joe Blair

Spud Date 4/28/78 Total Depth 6417' P.B.T.D. 6130'

Date Completed 6/15/78 Oil Purchaser

S. 2 T. 33S R. 38 E

Loc. 2590' FSL & 150' FEL

County STEVENS

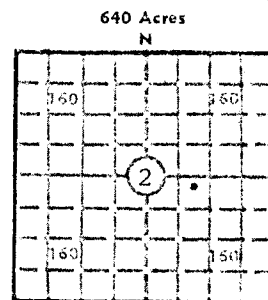

Locate well correctly  
Elev.: Gr. 3154'

DF KB

## CASING RECORD

Report of all strings set — surface, intermediate, production, etc.

Purpose of string	Size hole drilled	Size casing set (in O.D.)	Weight lbs/ft.	Setting depth	Type cement	Sacks	Type and percent additives
Surface	12-1/4"	8-5/8"	24#	1719'	Poz Common	600	4% gel, 2% CaCl
						200	3% CaCl
Production	7-7/8"	4-1/2"	11.6#	6215'	SS Poz Lite Wate	310	.5% CFR-2
						500	.5% CFR-2

## LINER RECORD

## PERFORATION RECORD

Top, ft.	Bottom, ft.	Sacks cement	Shots per ft.	Size & type	Depth interval
			2		6036-62'

## TUBING RECORD

Size	Setting depth	Packer set at
2-3/8"	6056'	

## ACID, FRACTURE, SHOT, CEMENT SQUEEZE RECORD

Amount and kind of material used	Depth interval treated
A/4000 gals 10% MCA + 45 BS + 500 SCF N <sub>2</sub> /Bbl. F/60,000 gals 75% foamed 3% acid + 60,000# 10-20 sd + 20 BS.	6036-62'

## INITIAL PRODUCTION

Date of first production		Producing method (flowing, pumping, gas lift, etc.)			
SI for PL Conn.		Flowing			
RATE OF PRODUCTION PER 24 HOURS	Oil	Gas	Water	Gas-oil ratio	
	bbls.	1030 MCF	bbls.	CFPB	
Disposition of gas (vented, used on lease or sold)			Producing interval(s)		
Will Be Sold			6036-62' (Morr)		

INSTRUCTIONS: As provided in KCC Rule 82-2-125, within 90 days after completion of a well, one completed copy of this Drillers Log shall be transmitted to the State Geological Survey of Kansas, 4150 Monroe Street, Wichita, Kansas 67209. Copies of this form are available from the Conservation Division, State Corporation Commission, 3830 So. Meridian (P.O. Box 17027), Wichita, Kansas 66217. Phone AC 316-522-2206. If confidential custody is desired, please note Rule 82-2-125. Drillers Logs will be on open file in the Oil and Gas Division, State Geological Survey of Kansas, Lawrence, Kansas 66044.

Operator ANADARKO PRODUCTION COMPANY	DESIGNATE TYPE OF COMP.: OIL, GAS, DRY HOLE, SWDW, ETC.: GAS
---	--

Well No. 1	Lease Name SPIKES "C"
---------------	--------------------------

S <u>2</u> T <u>33S</u> R <u>38</u> <sup>K</sup> / <sub>W</sub>	
---	--

### WELL LOG

Show all important zones of porosity and contents thereof; cored intervals, and all drill-stem tests, including depth interval tested, cushion used, time tool open, flowing and shut-in pressures, and recoveries.

SHOW GEOLOGICAL MARKERS, LOGS RUN, OR OTHER DESCRIPTIVE INFORMATION.

FORMATION DESCRIPTION, CONTENTS, ETC.	TOP	BOTTOM	NAME	DEPTH
Sand	40'	518'		
Redbed & Sand	518'	1010'		
Redbed	1010'	1115'		
Sand	1115'	1350'		
Redbed	1350'	1630'		
Redbed & Anhy	1630'	1719'		
Shale	1719'	2400'		
Shale & Lime	2400'	6417'		
TOTAL DEPTH		6417'		
PBTD		6130'		

USE ADDITIONAL SHEETS, IF NECESSARY, TO COMPLETE WELL RECORD.

Date Received

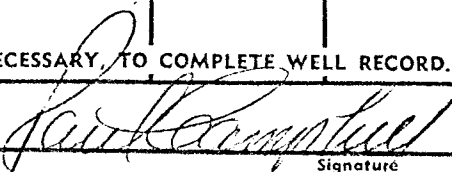
  
Signature

Paul Campbell, Division Production Manager

Title

July 14, 1978

Date