

15-077-20482

State Geological Survey

KANSAS DRILLERS LOG

S. 11 T. 33S R. 6 <sup>X</sup><sub>E</sub>  
 W  
 Loc. 1980' FSL & 760' FEL  
 County Harper

API No. 15 — 077 — 20,482  
 County Number

Operator  
 ANADARKO PRODUCTION COMPANY  
 Address  
 P. O. BOX 351, LIBERAL, KS. 67901  
 Well No. 1 Lease Name FLINN "A"  
 Footage Location  
 1980 feet from (N) (S) line 760 feet from (E) (W) line  
 Principal Contractor Gabbert-Jones, Inc. Geologist Eldon J. Schierling  
 Spud Date 6/16/78 Total Depth 4834' P.B.T.D.  
 Date Completed 6/29/78 Oil Purchaser

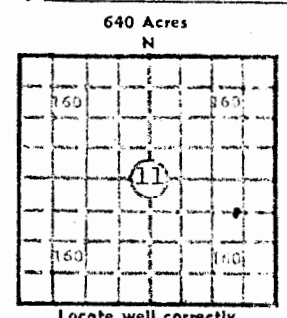

Locate well correctly  
 Elev.: Gr. 1313'  
 DF \_\_\_\_\_ KB \_\_\_\_\_

CASING RECORD

Report of all strings set — surface, intermediate, production, etc.

| Purpose of string | Size hole drilled | Size casing set (in O.D.) | Weight lbs/ft. | Setting depth | Type cement | Sacks | Type and percent additives |
|-------------------|-------------------|---------------------------|----------------|---------------|-------------|-------|----------------------------|
| Surface           | 12-1/4"           | 8-5/8"                    | 20#            | 261'          | Common      | 300   | 3% cc                      |
|                   |                   |                           |                |               |             |       |                            |
|                   |                   |                           |                |               |             |       |                            |

LINER RECORD

PERFORATION RECORD

| Top, ft. | Bottom, ft. | Sacks cement | Shots per ft. | Size & type | Depth interval |
|----------|-------------|--------------|---------------|-------------|----------------|
|          |             |              |               |             |                |
|          |             |              |               |             |                |

TUBING RECORD

| Size | Setting depth | Packer set at |
|------|---------------|---------------|
|      |               |               |

ACID, FRACTURE, SHOT, CEMENT SQUEEZE RECORD

| Amount and kind of material used | Depth interval treated |
|----------------------------------|------------------------|
|                                  |                        |
|                                  |                        |

INITIAL PRODUCTION

Date of first production \_\_\_\_\_ Producing method (flowing, pumping, gas lift, etc.) \_\_\_\_\_

| RATE OF PRODUCTION PER 24 HOURS | Oil   | Gas | Water | Gas-oil ratio |
|---------------------------------|-------|-----|-------|---------------|
|                                 | bbls. | MCF | bbls. | CFPB          |

Disposition of gas (vented, used on lease or sold) \_\_\_\_\_ Producing interval(s) \_\_\_\_\_

INSTRUCTIONS: As provided in KCC Rule 82-2-125, within 90 days after completion of a well, one completed copy of this Drillers Log shall be transmitted to the State Geological Survey of Kansas, 4150 Monroe Street, Wichita, Kansas 67209. Copies of this form are available from the Conservation Division, State Corporation Commission, 3830 So. Meridian (P.O. Box 17027), Wichita, Kansas 66217. Phone AC 316-522-2206. If confidential custody is desired, please note Rule 82-2-125. Drillers Logs will be on an open file in the Oil and Gas Division, State Geological Survey of Kansas, Lawrence, Kansas 66044.

DESIGNATE TYPE OF COMP.: OIL, GAS,  
 DRY HOLE, SWDW, ETC.:  
 DRY HOLE

Operator  
 ANADARKO PRODUCTION COMPANY

Well No. 1 Lease Name  
 FLINN "A"

S 11 T 33S R 6<sup>EX</sup> W

**WELL LOG**

Show all important zones of porosity and contents thereof; cored intervals, and all drill-stem tests, including depth interval tested, cushion used, time tool open, flowing and shut-in pressures, and recoveries.

SHOW GEOLOGICAL MARKERS, LOGS RUN,  
 OR OTHER DESCRIPTIVE INFORMATION.

| FORMATION DESCRIPTION, CONTENTS, ETC.   | TOP  | BOTTOM | NAME | DEPTH |
|---|------|--------|------|-------|
| Surface Clay-Rock   | 0    | 115    |      |       |
| Redbed-Rock   | 115  | 170    |      |       |
| Shale   | 170  | 850    |      |       |
| Shale-Lime  | 850  | 1340   |      |       |
| Lime-Shale  | 1340 | 4361   |      |       |
| Lime  | 4361 | 4785   |      |       |
| Sand  | 4785 | 4790   |      |       |
| Lime-Sand   | 4790 | 4834   |      |       |
| TOTAL DEPTH   |      | 4834   |      |       |
| <p>DST #1 4343-4361 ( Miss) 20 MPF w/wk blo, SI 40', tool open 40 w/wk to fair blo, SI 120' rec 35' wtry DM, PFP 9-28, ISIP 564, FFP 28-37, FSIP 1404, HP 2242-2167.</p> <p>DST #2 4773-4785 (Simpson) 20 MPF w/wk blo, SI 40', tool op 60' w/no blo in 20', bypassed tool w/few bubbles, SI 120', rec 70' DM, PFP 20-20, ISIP 1825, FFP 20-40, FSIP 1825, HP 2485-2505, lost approx 300 BM 4834.</p> <p>DST #3 4772-4834 (Simpson) 20-40-40-120, op w/str blo, rec 60' DM, 3840' MW, PFP 945-1525, ISIP 1885 (40), FFP 1445-1885, FSIP 1885 (120).</p> |      |        |      |       |

USE ADDITIONAL SHEETS, IF NECESSARY, TO COMPLETE WELL RECORD.

Date Received

*Paul Campbell*  
 Signature  
 Paul Campbell, Division Production Manager  
 Title  
 August 7, 1978  
 Date