

Handwritten mark

STATE CORPORATION COMMISSION OF KANSAS
OIL & GAS CONSERVATION DIVISION
WELL COMPLETION OR RECOMPLETION FORM
ACO-1 WELL HISTORY
DESCRIPTION OF WELL AND LEASE

Operator: License # 3532
Name ..CMX, Inc.....
Address ..1026 Union Center Bldg.....
City/State/Zip ..Wichita, KS, 67202.....

Purchaser..... Not Applicable

Operator Contact Person ...Doug McGinness II...
Phone316-269-9052.....

Contractor: License # 5929

Name ..Duke Drilling Co., Inc.....
Wellsite Geologist... Doug McGinness II

Designate Type of Completion
___ New Well ___ Re-Entry ___ X Workover
___ Oil ___ SWD ___ Temp Abd
___ Gas ___ Inj ___ Delayed Comp.
___ Dry ___ Other (Core, Water Supply etc.)

If OWN: old well info as follows:
Operator,
Well Name,
Comp. DateOld Total Depth.....

WELL HISTORY

Drilling Method:
___ Mud Rotary ___ Air Rotary ___ Cable
___ X Mud Rotary

..1-28-89.. ..1-30-89... ..04-17-89..
Spud Date Date Reached TD Completion Date
..4707'..... ..N/A.....
Total Depth PBDT

Amount of Surface Pipe Set and Cemented at...240' feet
Multiple Stage Cementing Collar Used? ___ Yes ___ X No
If yes, show depth set.....feet
If alternate 2 completion, cement circulated
from.....feet depth to.....w/.....SX cmt
Cement Company Name,
Invoice #

API NO. 15-.077-20.470-A.....
County.....Harper.....
.C...SW...SE..... Sec. 24. Twp 33...Rge. 8... East
XX West

660..... Ft North from Southeast Corner of Section
1980..... Ft West from Southeast Corner of Section
(Note: Locate well in section plat below)

Lease Name...Clark.....Well #. 1-24..

Field Name..... Wildcat

Producing Formation..... D. & A

Elevation: Ground..... 1380'.....KB.....

Section Plat

KANSAS GEOLOGICAL SURVEY
WICHITA BRANCH

JUN 0 6 1989

RECEIVED
STATE CORPORATION COMMISSION

JUN - 2 1989

CONSERVATION DIVISION
Wichita, Kansas

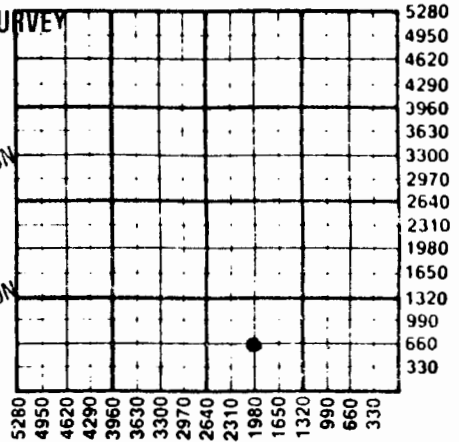

WATER SUPPLY INFORMATION

Disposition of Produced Water: ___ Disposal
Docket # ___ Repressuring

Questions on this portion of the ACO-1 call:
Water Resources Board (913) 296-3717

Source of Water:
Division of Water Resources Permit #.....

___ Groundwater.....Ft North from Southeast Corner
(Well)Ft West from Southeast Corner of
Sec Twp Rge ___ East ___ West

___ Surface Water.....Ft North from Southeast Corner
(Stream, pond etc).....Ft West from Southeast Corner
Sec Twp Rge ___ East ___ West

City of Attica Water
___ X Other (explain).....
(purchased from city, R.W.D. #)

INSTRUCTIONS: This form shall be completed in triplicate and filed with the Kansas Corporation Commission, 200 Colorado Derby Building, Wichita, Kansas 67202, within 120 days of the spud date of any well. Rule 82-3-130, 82-3-107 and 82-3-106 apply. Information on side two of this form will be held confidential for a period of 12 months if requested in writing and submitted with the form. See rule 82-3-107 for confidentiality in excess of 12 months. One copy of all wireline logs and drillers time log shall be attached with this form. Submit CP-4 form with all plugged wells. Submit CP-111 form with all temporarily abandoned wells.

SIDE TWO

Operator Name CMX, Inc. Lease Name Clark Well # 1-24

Sec. 24 Twp. 33 Rge. 8 East West County Harper

WELL LOG

INSTRUCTIONS: Show important tops and base of formations penetrated. Detail all cores. Report all drill stem tests giving interval tested, time tool open and closed, flowing and shut-in pressures, whether shut-in pressure reached static level, hydrostatic pressures, bottom hole temperature, fluid recovery, and flow rates if gas to surface during test. Attach extra sheet if more space is needed. Attach copy of log.

Drill Stem Tests Taken Yes No
 Samples Sent to Geological Survey Yes No
 Cores Taken Yes No

Formation Description
 Log Sample

Name Top Bottom

#1-24 Clark was a washdown of an old hole.

Mississippi 4591 (-3211)

CASING RECORD <input type="checkbox"/> New <input type="checkbox"/> Used							
Report all strings set-conductor, surface, intermediate, production, etc.							
Purpose of String	Size Hole Drilled	Size Casing Set (in O.D.)	Weight Lbs/Ft.	Setting Depth	Type of Cement	#Sacks Used	Type and Percent Additives
Surface				240'			
Production	7-7/8"	5 1/2"		4705'	50/50paz	125	2% gel, 3% KCl, 75 Halar, 322 Gilsonite per sk. & 10# 400 gal. flush
PERFORATION RECORD				Acid, Fracture, Shot, Cement Squeeze Record (Amount and Kind of Material Used) Depth			
Shots Per Foot	Specify Footage of Each Interval Perforated						
2	4645' to 4655'			500 gals. 15% MCA; squeeze with 100 sx; 250 gals. 15%; squeeze; Plugged			
TUBING RECORD				Liner Run	<input type="checkbox"/> Yes <input type="checkbox"/> No		
Date of First Production	Producing Method			<input type="checkbox"/> Flowing <input type="checkbox"/> Pumping <input type="checkbox"/> Gas Lift <input type="checkbox"/> Other (explain).....			