

5-34-13W

KANSAS DRILLERS LOG

State Geological Survey
WICHITA, BRANCH

S. 5 T. 34 R. 13 W.
Loc. SW SW
County Barber

API No. 15 — 007 — 20,433
County Number

Operator
George R. Jones

Address
200 East First Wichita, Kansas 67202

Well No. #1 Lease Name Blunk

Footage Location
660 feet from (N) (S) line 560 feet from (E) (W) line

Principal Contractor Gabbert-Jones Geologist Lee Poulsen

Spud Date 7-23-76 Total Depth 5328' P.B.T.D. --

Date Completed 8-26-76 Oil Purchaser Permian

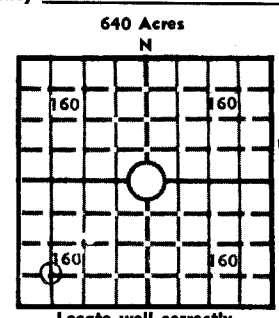

Locate well correctly
Elev.: Gr. 1856'
DF 1858' KB 1861'

CASING RECORD

Report of all strings set — surface, intermediate, production, etc.

Purpose of string	Size hole drilled	Size casing set (in O.D.)	Weight lbs/ft.	Setting depth	Type cement	Sacks	Type and percent additives
Surface	13"	8 5/8"	28#	357	Posmix	300	2% gel; 3% CC
Production	7 7/8"	5 1/2"	15.5# & 17#	5312	Posmix	100	200 bbl salt flush 10% salt

LINER RECORD

PERFORATION RECORD

Top, ft.	Bottom, ft.	Sacks cement	Shots per ft.	Size & type	Depth interval
--	--	--	--	--	--

TUBING RECORD

Size	Setting depth	Packer set at
2 3/8"	5307'	--

ACID, FRACTURE, SHOT, CEMENT SQUEEZE RECORD

Amount and kind of material used	Depth interval treated
No Treatment	--

INITIAL PRODUCTION

Date of first production <u>8-26-76</u>		Producing method (flowing, pumping, gas lift, etc.) <u>Pumping</u>			
RATE OF PRODUCTION PER 24 HOURS	Oil <u>100</u> bbls.	Gas <u>Not known</u> MCF	Water <u>None</u> bbls.	Gas-oil ratio <u>--</u> CFPB	
Disposition of gas (vented, used on lease or sold) <u>Vented</u>			Producing interval(s) <u>Simpson 5312-5328'</u>		

INSTRUCTIONS: As provided in KCC Rule 82-2-125, within 90 days after completion of a well, one completed copy of this Drillers Log shall be transmitted to the State Geological Survey of Kansas, 4150 Monroe Street, Wichita, Kansas 67209. Copies of this form are available from the Conservation Division, State Corporation Commission, 3830 So. Meridian (P.O. Box 17027), Wichita, Kansas 66217. Phone AC 316-522-2206. If confidential custody is desired, please note Rule 82-2-125. Drillers Logs will be on open file in the Oil and Gas Division, State Geological Survey of Kansas, Lawrence, Kansas 66044.

Operator

George R. Jones

DESIGNATE TYPE OF COMP.: OIL, GAS,
DRY HOLE, SWDW, ETC.:
Oil well

Well No.

1

Lease Name

Blunk

S 5 T 34S R 13 W

WELL LOG

Show all important zones of porosity and contents thereof; cored intervals, and all drill-stem tests, including depth interval tested, cushion used, time tool open, flowing and shut-in pressures, and recoveries.

SHOW GEOLOGICAL MARKERS, LOGS RUN,
OR OTHER DESCRIPTIVE INFORMATION.

FORMATION DESCRIPTION, CONTENTS, ETC.	TOP	BOTTOM	NAME	DEPTH
			Heebner	4116 (-2255)
			Lansing	4297 (-2436)
			Base Kan. City	4756 (-2895)
			Mississippian	4854 (-2993)
			Kinderhook	5106 (-3245)
			Viola	5204 (-3343)
			Simpson Dolo.	5312 (-3451)
			LTD	5328 (-3467)
			<u>Logs Run:</u>	
			Petro Log Radiation-Guard Caliper	

USE ADDITIONAL SHEETS, IF NECESSARY, TO COMPLETE WELL RECORD.

Date Received



Signature

George R. Jones

Title Operator

10/8/76

Date

24-100