

21-34-13W

SIDE ONE

STATE CORPORATION COMMISSION OF KANSAS
OIL & GAS CONSERVATION DIVISION
WELL COMPLETION OR RECOMPLETION FORM
ACO-1 WELL HISTORY
DESCRIPTION OF WELL AND LEASE

Operator: License # 5171
Name TXO Production Corp.
Address 1660 Lincoln St. - Suite 1800
City/State/Zip Denver, Colorado 80264

Purchaser.....

Operator Contact Person Les Smith
Phone 303-861-4246

Contractor: License # 5864
Name Loba Drilling Company

Wellsite Geologist Ken LeBlanc
Phone (316) 683-8145

Designate Type of Completion
X New Well Re-Entry Workover
Oil SWD Temp Abd
Gas Inj Delayed Comp.
X Dry Other (Core, Water Supply etc.)

If ONWO: old well info as follows:
Operator.....
Well Name.....
Comp. Date.....Old Total Depth.....

WELL HISTORY

Drilling Method:
X Mud Rotary Air Rotary Cable
3-11-89 3-19-89 3-17-89
Spud Date Date Reached TD Completion Date
5000'
Total Depth PBTD

Amount of Surface Pipe Set and Cemented at 397 feet
Multiple Stage Cementing Collar Used? Yes No
If yes, show depth set.....feet
If alternate 2 completion, cement circulated
from.....feet depth to.....w/.....SX cmt
Cement Company Name.....
Invoice #.....

API NO. 15-007-22,226
County Barber
C. SW/4 Sec 21 Twp 34 Rge 13 East West

1320 Ft North from Southeast Corner of Section
3960 Ft West from Southeast Corner of Section
(Note: Locate well in section plat below)

Lease Name Meyer "G" Well # 1

Field Name.....

Producing Formation.....

Elevation: Ground 1568 1573 KB

Section Plat

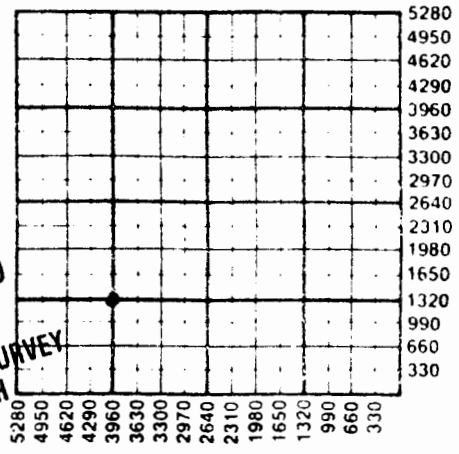

JUN 27 1989
KANSAS GEOLOGICAL SURVEY
WICHITA BRANCH

WATER SUPPLY INFORMATION

Disposition of Produced Water: Disposal
Docket # Repressuring

Questions on this portion of the ACO-1 call:
Water Resources Board (913) 296-3717

Source of Water:
Division of Water Resources Permit #.....
Groundwater.....Ft North from Southeast Corner
(Well)Ft West from Southeast Corner of
Sec Twp Rge East West
X Surface Water 1320 Ft North from Southeast Corner
(Stream, pond etc) 1320 Ft West from Southeast Corner
Sec 21 Twp 34 Rge 13 East X West
Other (explain).....
(purchased from city, R.W.D. #)

INSTRUCTIONS: This form shall be completed in triplicate and filed with the Kansas Corporation Commission, 200 Colorado Derby Building, Wichita, Kansas 67202, within 120 days of the spud date of any well. Rule 82-3-130, 82-3-107 and 82-3-106 apply.

Information on side two of this form will be held confidential for a period of 12 months if requested in writing and submitted with the form. See rule 82-3-107 for confidentiality in excess of 12 months. One copy of all wireline logs and drillers time log shall be attached with this form. Submit CP-4 form with all plugged wells. Submit CP-111 form with all temporarily abandoned wells.